

HTE 04-5-8521

21094

**IMPROVEMENT PERMIT**

Be it ordained by the Harnett County Board of Health as follows: Section III, Item B. "No Person shall begin construction of any building at which a septic tank system is to be used for disposal of sewage without first obtaining a written permit from the Harnett County Health Department."

Name: (owner) Weaver Dev.  New Installation  Septic Tank  
 Property Location: SR# 1141  Repairs  Nitrification Line

Subdivision Sunset Ridge Lot # 175

Tax ID # \_\_\_\_\_ Quadrant # \_\_\_\_\_

Number of Bedrooms Proposed: 3 (42x46) Lot Size: 1/3 AC

Basement with Plumbing:  Garage:

Water Supply:  Well  Public  Community

Distance From Well: 50 ft.

**Following is the minimum specifications for sewage disposal system on above captioned property. Subject to final approval.**

Type of system:  Conventional  Other \_\_\_\_\_

Size of tank: Septic Tank: 1000 gallons Pump Tank: \_\_\_\_\_ gallons

Subsurface Drainage Field No. of ditches 1 exact length of each ditch 200 ft. width of ditches 3 ft. depth of ditches 18 1/4 in.

French Drain Required: \_\_\_\_\_ Linear feet

Date: 02-09-04

Signed: [Signature]  
 Environmental Health Specialist

**This permit is subject to revocation if site plans or intended use change.**

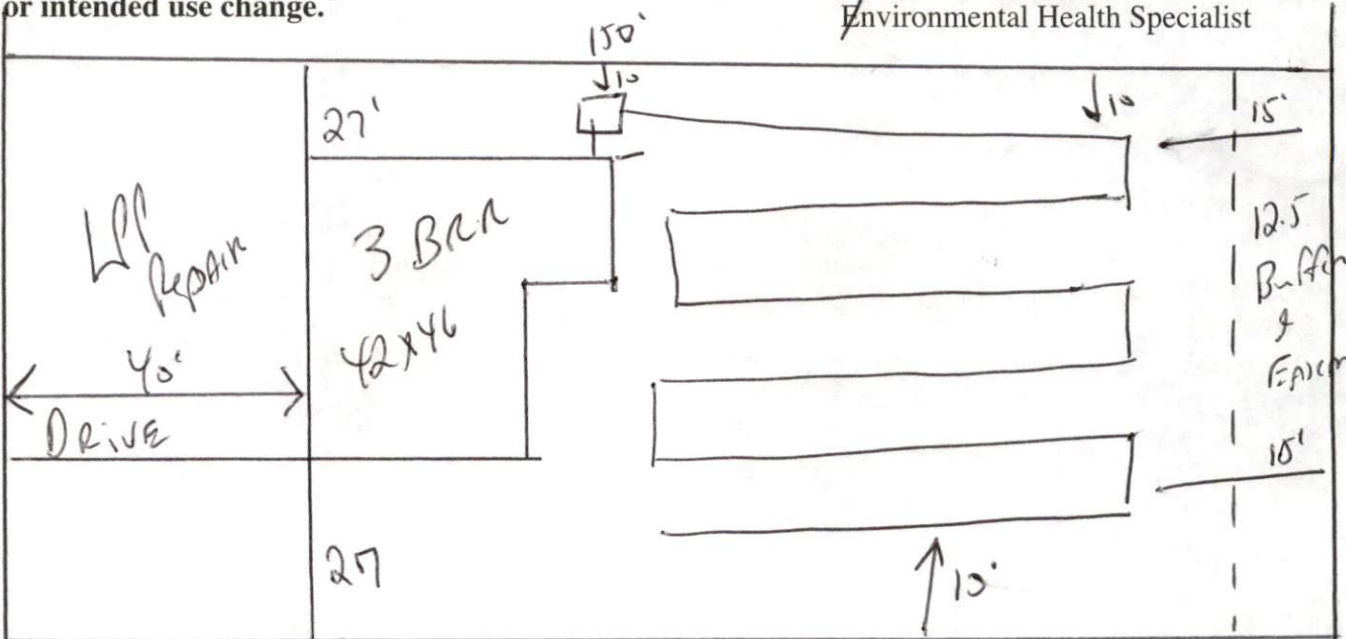

STUB out Plumbing shallow maintain All setbacks  
 Keep drain Lines 15' from Rear Property Line

HARNETT COUNTY HEALTH DEPARTMENT  
AUTHORIZATION TO CONSTRUCT

Authorization is hereby given to construct a wastewater system to the specifications described by Harnett County Health Department, Improvement Permit # 21094. This authorization shall be valid for a period not to exceed five (5) years from the date of issuance. This authorization will be invalid if ownership, site plans, or intended use change.

Weaver  
Name \_\_\_\_\_ Telephone# \_\_\_\_\_

Address \_\_\_\_\_

Property Location SR# \_\_\_\_\_ Road Name \_\_\_\_\_  
Sunset Ridge 175 3(42x44) 1/3 ac  
Subdivision Lot # # Bedrooms Proposed Lot Size

**TYPE OF SYSTEM**

- New Installation    Repair    Septic Tank    Nitrification Lines  
 Conventional    Other \_\_\_\_\_  
 Basement    With Plumbing    Without Plumbing

Water Supply:  Well    Public Water Supply   Minimum Well Setback: \_\_\_\_\_ Ft.  
Septic Tank 1000 gal   Pump Chamber \_\_\_\_\_ gal

**NITRIFICATION FIELD SPECIFICATIONS**

Number of fields 1 # of lines per field 1 Length of lines 200 Ft.  
Width of ditches 3 ft. Depth of ditches 18.24 inches  
French Drain: Linear feet required \_\_\_\_\_ Depth of gravel \_\_\_\_\_

No wastewater system shall be covered or placed into use by any person until an inspection by the Harnett County Health Department has determined that the system has been installed according to the conditions of the Improvement Permit and that a valid Operations Permit has been issued.

Joe Waters  
Signature of Authorized Agent for Harnett County of Harnett \_\_\_\_\_ Date 02-09-04