

HTE# 17-5-41863

Harnett County Department of Public Health

29594

Improvement Permit

A building permit cannot be issued with only an Improvement Permit

ISSUED TO: Phillip Faulk
PROPERTY LOCATION: 2581 Barbecue Ch. Rd. (Sn 1209)
NEW [x] REPAIR [] EXPANSION []
Type of Structure: Garage / Farm Storage
Proposed Wastewater System Type: 25% reduction Sys.
Projected Daily Flow: 100 GPD (State minimum)
Number of bedrooms: na Number of Occupants: 0A max
Basement [] Yes [x] No
Pump Required: [] Yes [] No [x] May be required based on final location and elevations of facilities
Type of Water Supply: [] Community [x] Public [] Well Distance from well _____ feet
Permit conditions: _____ Permit valid for: [] Five years [] No expiration

Authorized State Agent: [Signature] Date: 08/02/2017 SEE ATTACHED SITE SKETCH
The issuance of this permit by the Health Department in no way guarantees the issuance of other permits. The permit holder is responsible for checking with appropriate governing bodies in meeting their requirements. This site is subject to revocation if the site plan, plat, or the intended use changes. The Improvement Permit shall not be affected by a change in ownership of the site. This permit is subject to compliance with the provisions of the Laws and Rules for Sewage Treatment and Disposal and to conditions of this permit.

Construction Authorization

(Required for Building Permit)

The construction and installation requirements of Rules .1950, .1952, .1954, .1955, .1956, .1957, .1958, and .1959 are incorporated by references into this permit and shall be met. Systems shall be installed in accordance with the attached system layout.

ISSUED TO: Phillip Faulk PROPERTY LOCATION: 2581 Barbecue Ch. Rd. (Sn 1209)
SUBDIVISION _____ LOT # _____

Facility Type: Garage / Farm Storage [x] New [] Expansion [] Repair []
Basement? [] Yes [x] No Basement Fixtures? [] Yes [] No
Type of Wastewater System** 25% Reduction System (Initial) Wastewater Flow: 100 GPD
(See note below, if applicable [])
25% Reduction System (Repair)

Installation Requirements/Conditions
Septic Tank Size 1000 gallons
Pump Tank Size _____ gallons
Number of trenches 2
Exact length of each trench 40 feet
Trench Spacing: 9 Feet on Center
Trenches shall be installed on contour at a
Maximum Trench Depth of: 24 inches (Maximum soil cover shall not exceed 36" above the trench bottom)
in all directions)
Pump Requirements: _____ ft. TDH vs. _____ GPM
Aggregate Depth: 12 inches total
C inches below pipe
2 inches above pipe
Conditions: Garage/Animal Storage, Sinks, Drains, Future Bathroom, NO Bedrooms, NO Single Family Dwelling

WATER LINES (INCLUDING IRRIGATION) MUST BE 10FT. FROM ANY PART OF SEPTIC SYSTEM OR REPAIR AREA.
NO UTILITIES ALLOWED IN INITIAL OR REPAIR DRAIN FIELD AREA.

**If applicable: I understand the system type specified is different from the type specified on the application. I accept the specifications of this permit.

Owner/Legal Representative Signature: _____ Date: _____

This Construction Authorization is subject to revocation if the site plan, plat, or the intended use changes. The Construction Authorization shall not be transferred when there is a change in ownership of the site. This Construction Authorization is subject to compliance with the provisions of the Laws and Rules for Sewage Treatment and Disposal and to the conditions of this permit. SEE ATTACHED SITE SKETCH

Authorized State Agent: [Signature] Date: 08/02/2017
ANDREW CURRIN Construction Authorization Expiration Date: 08/02/2022

HTE# 17-5-41865

Permit # 29594

Harnett County Department of Public Health Site Sketch

ISSUED TO: Phillip Faulk PROPERTY LOCATOR: 2581 Barbecue Ch. Rd. (SR 1209)
SUBDIVISION _____ LOT # _____

Authorized State Agent: Andrew Currin Date: 08/02/2017
ANDREW CURRIN

- Facility: Garage & Animal Storage Area
- Sinks & Drains
 - Future Bathroom
 - No bedroom/Single Family Dwelling
 - State Minimum 100 Gallons Per Day (GPD)

25% REDUCTION
REPAIR AREA

ON CONTOUR
EQ. DIST.
25% REDUCTION
40(2)

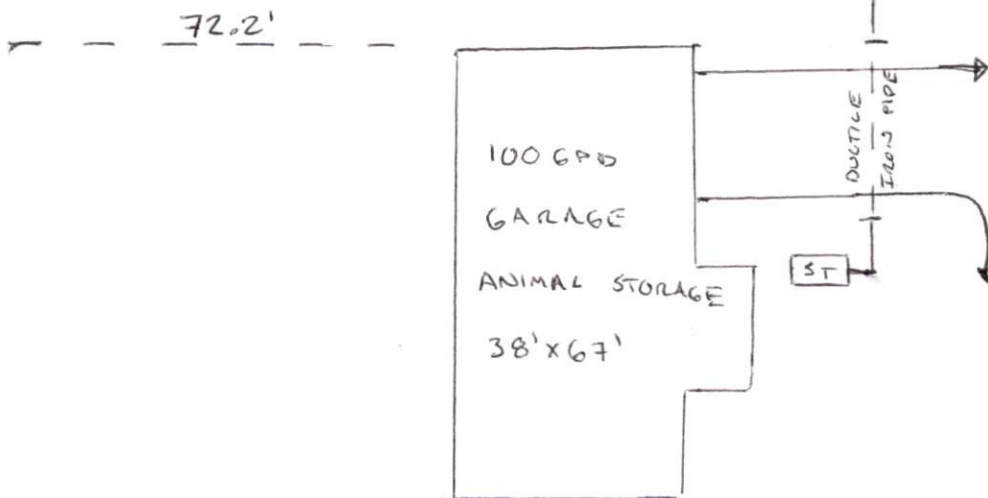

- * Building Construction began Pre-Permit
- * Plumbing Stubbed Pre-Permit
- * Ductile Iron Pipe shall be used under Drive Way
- * No driving on septic or repair area

TO BARBECUE
CHURCH RD.