

11-5-27794R A
HTE# 11-5-27795R B

Harnett County Department of Public Health Improvement Permit

27833

A building permit cannot be issued with only an Improvement Permit

PROPERTY LOCATION: Kirk Adams Rd.

ISSUED TO: Srinivasa Badarinarayana SUBDIVISION _____ LOT # 3

NEW REPAIR EXPANSION

Site Improvements required prior to Construction Authorization Issuance:

Type of Structure: SFD 60' x 110'

Proposed Wastewater System Type: 25% Reduction System

Projected Daily Flow: 600 GPD

Number of bedrooms: 5 Number of Occupants: 10 max

Basement Yes No

Pump Required: Yes No May be required based on final location and elevations of facilities

Type of Water Supply: Community Public Well Distance from well 100 feet

Permit valid for: Five years

Permit conditions: _____ No expiration

Authorized State Agent: Bryan McSwain, REHS Date: 3/26/2014 SEE ATTACHED SITE SKETCH

The issuance of this permit by the Health Department in no way guarantees the issuance of other permits. The permit holder is responsible for checking with appropriate governing bodies in meeting their requirements. This site is subject to revocation if the site plan, plat, or the intended use changes. The Improvement Permit shall not be affected by a change in ownership of the site. This permit is subject to compliance with the provisions of the Laws and Rules for Sewage Treatment and Disposal and to conditions of this permit.

Construction Authorization

(Required for Building Permit)

The construction and installation requirements of Rules .1950, .1952, .1954, .1955, .1956, .1957, .1958, and .1959 are incorporated by references into this permit and shall be met. Systems shall be installed in accordance with the attached system layout.

ISSUED TO: Srinivasa Badarinarayana PROPERTY LOCATION: Kirk Adams Rd.
SUBDIVISION _____ LOT # 3

Facility Type: SFD New Expansion Repair

Basement? Yes No Basement Fixtures? Yes No

Type of Wastewater System** 25% Reduction System (Initial) Wastewater Flow: 600 GPD

(See note below, if applicable)

25% Reduction System (Repair)

Installation Requirements/Conditions

Septic Tank Size 1250 gallons

Number of trenches 3

Exact length of each trench 150 feet

Trench Spacing: 9 Feet on Center

Pump Tank Size _____ gallons

Trenches shall be installed on contour at a

Soil Cover: 6-8 inches

Maximum Trench Depth of: 18-20 inches

(Maximum soil cover shall not exceed

(Trench bottoms shall be level to +/-1/4"

36" above the trench bottom)

in all directions)

Pump Requirements: _____ ft. TDH vs. _____ GPM

Aggregate Depth: _____ inches below pipe

_____ inches above pipe

Conditions: Septic Contractor to meet on site prior to installing system. No driving on drain field and or repair area. If fall from tank cannot be achieved a pump tank will be required

WATER LINES (INCLUDING IRRIGATION) MUST BE 10FT. FROM ANY PART OF SEPTIC SYSTEM OR REPAIR AREA.

NO UTILITIES ALLOWED IN INITIAL OR REPAIR DRAIN FIELD AREA.

**If applicable: I understand the system type specified is different from the type specified on the application. I accept the specifications of this permit.

Owner/Legal Representative Signature: _____ Date: _____

This Construction Authorization is subject to revocation if the site plan, plat, or the intended use changes. The Construction Authorization shall not be transferred when there is a change in ownership of the site. This

Construction Authorization is subject to compliance with the provisions of the Laws and Rules for Sewage Treatment and Disposal and to the conditions of this permit.

SEE ATTACHED SITE SKETCH

Authorized State Agent: Bryan McSwain, REHS Date: 3/26/2014
Construction Authorization Expiration Date: 3/26/2019

11-5-27794 R A

HTE# 11-5-27795 R B

Permit # 27833

Harnett County Department of Public Health Site Sketch

PROPERTY LOCATOR: Kirk Adams Rd.

ISSUED TO: Srinivasa Badarinarayana

SUBDIVISION

LOT # 3

Authorized State Agent: *[Signature]* REHS

Date: 3/26/2014

K
I
R
K

M
S
Rd.

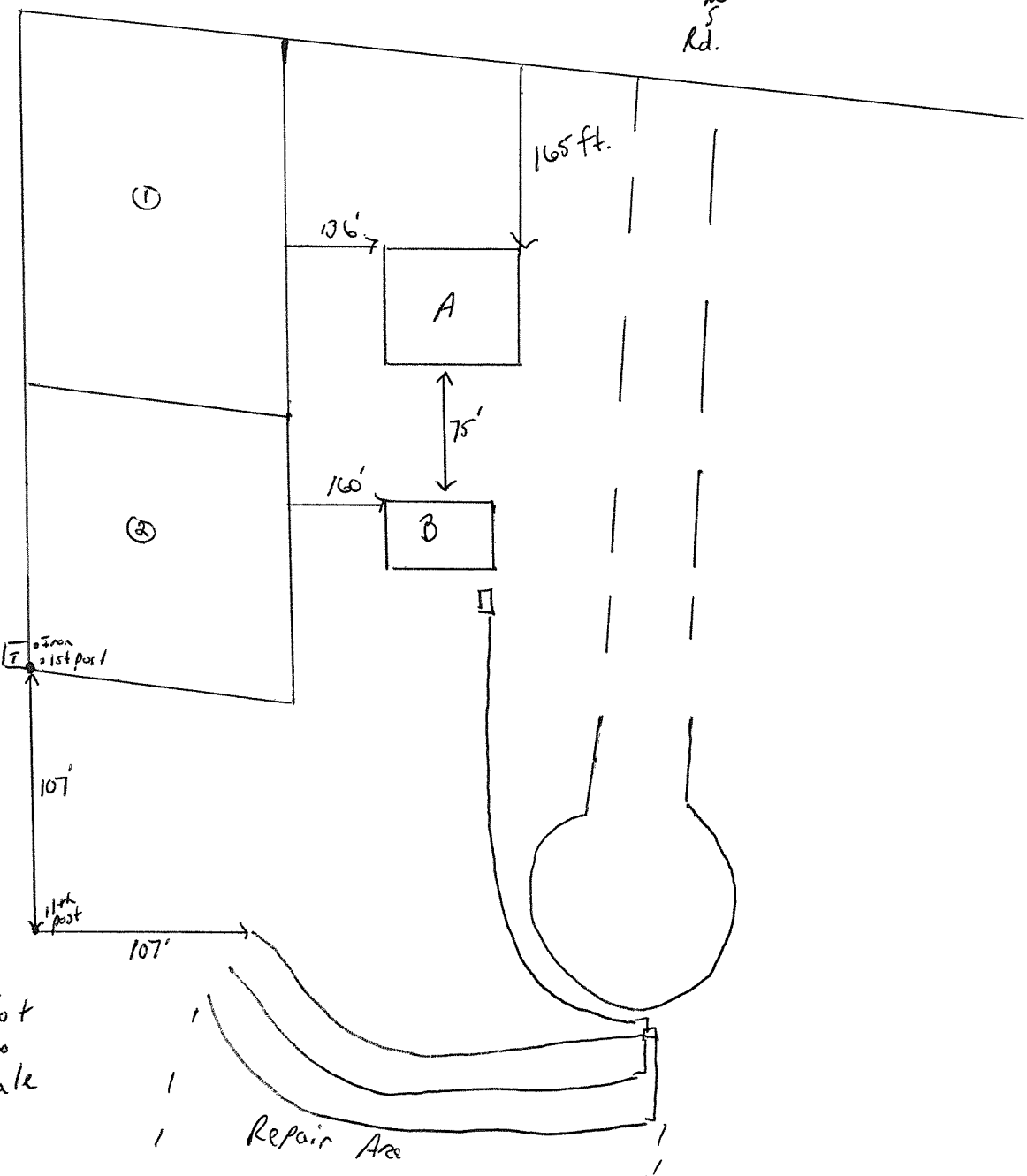

* Not to Scale

Repair Area