

Initial Application Date: 5-25-16 Angier zoning Application # 1650038816
CU# _____

COUNTY OF HARNETT RESIDENTIAL LAND USE APPLICATION
Central Permitting 108 E. Front Street, Lillington, NC 27546 Phone: (910) 893-7525 ext:2 Fax: (910) 893-2793 www.harnett.org/permits

****A RECORDED SURVEY MAP, RECORDED DEED (OR OFFER TO PURCHASE) & SITE PLAN ARE REQUIRED WHEN SUBMITTING A LAND USE APPLICATION****

LANDOWNER: Chris Hughes Mailing Address: 65 Golden Ln
City: Angier State: NC Zip: 27501 Contact No: 919-810-3301 Email: SpecialtySignandGraphic@gmail.com

APPLICANT*: same Mailing Address: _____
City: _____ State: _____ Zip: _____ Contact No: _____ Email: _____
*Please fill out applicant information if different than landowner

CONTACT NAME APPLYING IN OFFICE: _____ Phone # _____

PROPERTY LOCATION: Subdivision: _____ Lot #: 5 Lot Size: .75
State Road # _____ State Road Name: 65 Golden Ln Map Book & Page: - / -
Parcel: 040672 0040 09 PIN: 0683-80-3259
Zoning: Angier Flood Zone: X Watershed: - Deed Book & Page: 3049, 618 Power Company*: _____

*New structures with Progress Energy as service provider need to supply premise number _____ from Progress Energy.

PROPOSED USE:

- SFD: (Size _____ x _____) # Bedrooms: _____ # Baths: _____ Basement(w/wo bath): _____ Garage: _____ Deck: _____ Crawl Space: _____ Slab: _____ Slab: _____
(Is the bonus room finished? () yes () no w/ a closet? () yes () no (if yes add in with # bedrooms)
- Mod: (Size _____ x _____) # Bedrooms _____ # Baths _____ Basement (w/wo bath) _____ Garage: _____ Site Built Deck: _____ On Frame _____ Off Frame _____
(Is the second floor finished? () yes () no Any other site built additions? () yes () no
- Manufactured Home: _____ SW _____ DW _____ TW (Size _____ x _____) # Bedrooms: _____ Garage: _____ (site built? _____) Deck: _____ (site built? _____)
- Duplex: (Size _____ x _____) No. Buildings: _____ No. Bedrooms Per Unit: _____
- Home Occupation: # Rooms: _____ Use: _____ Hours of Operation: _____ #Employees: _____

Addition/Accessory/Other: (Size 54 x 26.25) Use: Attached Garage Closets in addition? () yes no
12x12 Bathroom Addition

Water Supply: County _____ Existing Well _____ New Well (# of dwellings using well _____) *Must have operable water before final
Sewage Supply: _____ New Septic Tank (Complete Checklist) _____ Existing Septic Tank (Complete Checklist) _____ County Sewer

Does owner of this tract of land, own land that contains a manufactured home within five hundred feet (500') of tract listed above? () yes no
Does the property contain any easements whether underground or overhead () yes no

Structures (existing or proposed): Single family dwellings: _____ Manufactured Homes: _____ Other (specify): _____

Required Residential Property Line Setbacks:

Front	Minimum	Actual
		<u>35</u>
Rear		<u>95</u>
Closest Side		<u>10</u>
Sidestreet/corner lot		
Nearest Building on same lot		

Comments: Customer says teach lines are where proposed Garage is going so he wants the lines to be moved

SPECIFIC DIRECTIONS TO THE PROPERTY FROM LILLINGTON:

210 Ron Sheriff Johnson

Left on Old Buies Creek right on
Montague and Right onto Golden Ln.-
Second house on Left.

If permits are granted I agree to conform to all ordinances and laws of the State of North Carolina regulating such work and the specifications of plans submitted. I hereby state that foregoing statements are accurate and correct to the best of my knowledge. Permit subject to revocation if false information is provided.

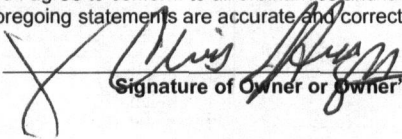
Signature of Owner or Owner's Agent

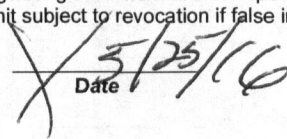
Date

It is the owner/applicants responsibility to provide the county with any applicable information about the subject property, including but not limited to: boundary information, house location, underground or overhead easements, etc. The county or its employees are not responsible for any incorrect or missing information that is contained within these applications.

This application expires 6 months from the initial date if permits have not been issued

NAME: _____

APPLICATION #: 38814

This application to be filled out when applying for a septic system inspection.

County Health Department Application for Improvement Permit and/or Authorization to Construct

IF THE INFORMATION IN THIS APPLICATION IS FALSIFIED, CHANGED, OR THE SITE IS ALTERED, THEN THE IMPROVEMENT PERMIT OR AUTHORIZATION TO CONSTRUCT SHALL BECOME INVALID. The permit is valid for either 60 months or without expiration depending upon documentation submitted. (Complete site plan = 60 months; Complete plat = without expiration)

910-893-7525 option 1

CONFIRMATION # Customer 3-25-16
Calling in.

Environmental Health New Septic System Code 800

- **All property irons must be made visible.** Place "pink property flags" on each corner iron of lot. All property lines must be clearly flagged approximately every 50 feet between corners.
- Place "orange house corner flags" at each corner of the proposed structure. Also flag driveways, garages, decks, out buildings, swimming pools, etc. Place flags per site plan developed at/for Central Permitting.
- Place orange Environmental Health card in location that is easily viewed from road to assist in locating property.
- If property is thickly wooded, Environmental Health requires that you clean out the **undergrowth** to allow the soil evaluation to be performed. Inspectors should be able to walk freely around site. **Do not grade property.**
- **All lots to be addressed within 10 business days after confirmation. \$25.00 return trip fee may be incurred for failure to uncover outlet lid, mark house corners and property lines, etc. once lot confirmed ready.**
- After preparing proposed site call the voice permitting system at 910-893-7525 option 1 to schedule and use code **800** (after selecting notification permit if multiple permits exist) for Environmental Health inspection. Please note confirmation number given at end of recording for proof of request.
- Use Click2Gov or IVR to verify results. Once approved, proceed to Central Permitting for permits.

Environmental Health Existing Tank Inspections Code 800

- Follow above instructions for placing flags and card on property.
- Prepare for inspection by removing soil over **outlet end** of tank as diagram indicates, and lift lid straight up (*if possible*) and then **put lid back in place.** (Unless inspection is for a septic tank in a mobile home park)
- **DO NOT LEAVE LIDS OFF OF SEPTIC TANK**
- After uncovering **outlet end** call the voice permitting system at 910-893-7525 option 1 & select notification permit if multiple permits, then use code **800** for Environmental Health inspection. Please note confirmation number given at end of recording for proof of request.
- Use Click2Gov or IVR to hear results. Once approved, proceed to Central Permitting for remaining permits.

SEPTIC

If applying for authorization to construct please indicate desired system type(s): can be ranked in order of preference, must choose one.

- Accepted Innovative Conventional Any
 Alternative Other _____

The applicant shall notify the local health department upon submittal of this application if any of the following apply to the property in question. If the answer is "yes", applicant **MUST ATTACH SUPPORTING DOCUMENTATION**:

- YES NO Does the site contain any Jurisdictional Wetlands?
 YES NO Do you plan to have an irrigation system now or in the future?
 YES NO Does or will the building contain any drains? Please explain. _____
 YES NO Are there any existing wells, springs, waterlines or Wastewater Systems on this property?
 YES NO Is any wastewater going to be generated on the site other than domestic sewage?
 YES NO Is the site subject to approval by any other Public Agency?
 YES NO Are there any Easements or Right of Ways on this property?
 YES NO Does the site contain any existing water, cable, phone or underground electric lines?
If yes please call No Cuts at 800-632-4949 to locate the lines. This is a free service.

I Have Read This Application And Certify That The Information Provided Herein Is True, Complete And Correct. Authorized County And State Officials Are Granted Right Of Entry To Conduct Necessary Inspections To Determine Compliance With Applicable Laws And Rules.

I Understand That I Am Solely Responsible For The Proper Identification And Labeling Of All Property Lines And Corners And Making The Site Accessible So That A Complete Site Evaluation Can Be Performed.

PROPERTY OWNERS OR OWNERS LEGAL REPRESENTATIVE SIGNATURE (REQUIRED)

DATE

Chris [Signature]

5/25/16

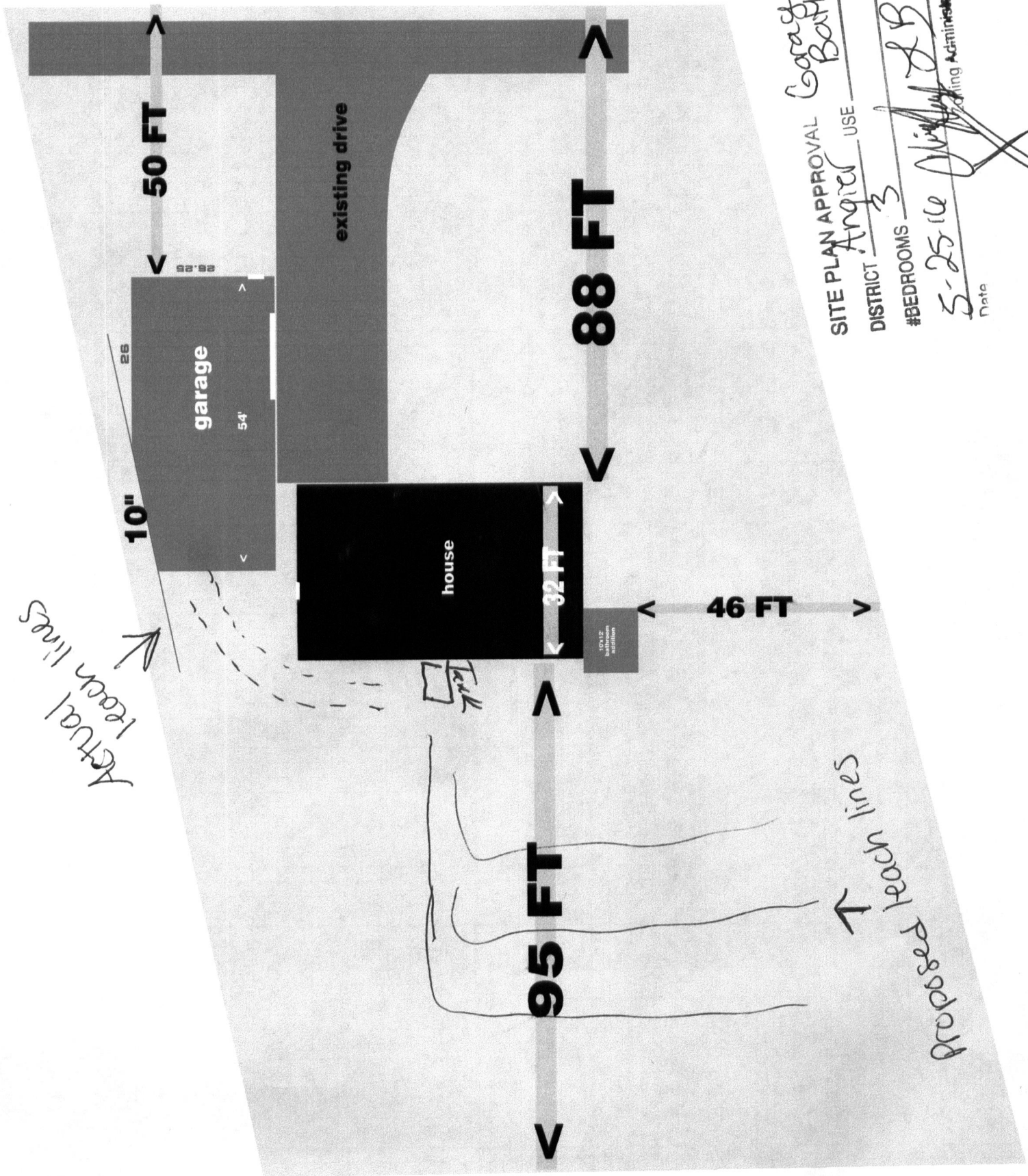

SITE PLAN APPROVAL Garaged Bathroom
Angier USE _____
 DISTRICT 3
 #BEDROOMS 3
5-25-16 [Signature]
 Date Planning Administrator



TOWN OF ANGIER

LAND USE PERMIT

55 NORTH BROAD ST WEST ANGIER, NC 27501-0278

Phone: 919-639-2071 FAX: 919-639-6130

DATE ISSUED: 05/09/2016

PERMIT #: 2016-000156

LOCATION

65 GOLDEN LANE

DISTRICT

TAX MAP PARCEL#

040672 0040 09

LOT

ZONING DISTRICT

RA-30

OWNER:

CHRIS HUGHES

TOTAL VALUATION

\$ 0

CONTRACTOR:

SUBCONTRACTOR ID/NAME

SUBCONTRACTOR TYPE

TYPE CONSTRUCTION: LAND USE

OCCUPANCY GROUP: LAND USE

FEE CODE

FEE

LAND USE RESIDENTIAL

35.00

TOTAL PAID:

35.00

PAID IN FULL

TOTAL AMOUNT:

35.00

REMARKS:

LAND USE PERMIT FOR NEW ATTACHED GARAGE, BATHROOM ADDITION, AND SEPTIC SYSTEM RECONFIGURATION

(SIGNATURE OF CONTRACTOR/OWNER)

Sean Johnson

(ISSUED BY)

(DATE)

5/9/16

(DATE)