

HTE# 14-5-2293402

Harnett County Department of Public Health

27919

Improvement Permit

A building permit cannot be issued with only an Improvement Permit

ISSUED TO: McNEIL MASONRY PROPERTY LOCATION: NC27W
 NEW REPAIR EXPANSION SUBDIVISION MOREQUITY REALTY LOT # 3
 Type of Structure: SFO (26'x42') Site Improvements required prior to Construction Authorization Issuance:
 Proposed Wastewater System Type: 25% REDUCTION SYSTEM
 Projected Daily Flow: 360 GPD
 Number of bedrooms: 3 Number of Occupants: 6 max
 Basement Yes No
 Pump Required: Yes No May be required based on final location and elevations of facilities
 Type of Water Supply: Community Public Well Distance from well 100 feet Permit valid for: Five years
 Permit conditions: No expiration

Authorized State Agent: [Signature] REHS Date: 3/31/14 SEE ATTACHED SITE SKETCH
 The issuance of this permit by the Health Department in no way guarantees the issuance of other permits. The permit holder is responsible for checking with appropriate governing bodies in meeting their requirements. This site is subject to revocation if the site plan, plat, or the intended use changes. The Improvement Permit shall not be affected by a change in ownership of the site. This permit is subject to compliance with the provisions of the Laws and Rules for Sewage Treatment and Disposal and to conditions of this permit.

Construction Authorization

(Required for Building Permit)

The construction and installation requirements of Rules .1950, .1952, .1954, .1955, .1956, .1957, .1958, and .1959 are incorporated by references into this permit and shall be met. Systems shall be installed in accordance with the attached system layout.

ISSUED TO: McNEIL MASONRY PROPERTY LOCATION: NC27W
 Facility Type: SFO (26'x42') New Expansion Repair
 Basement? Yes No Basement Fixtures? Yes No
 Type of Wastewater System** 25% REDUCTION SYSTEM (Initial) Wastewater Flow: 360 GPD
 (See note below, if applicable)
Pump To 25% REDUCTION (Repair)

Installation Requirements/Conditions

Septic Tank Size <u>1000</u> gallons	Number of trenches <u>5</u>	Trench Spacing: <u>9</u> Feet on Center
Pump Tank Size <u>1000</u> gallons (IF NEEDED)	Exact length of each trench <u>60</u> feet	Soil Cover: <u>6</u> inches
	Trenches shall be installed on contour at a Maximum Trench Depth of: <u>18-12</u> inches (Trench bottoms shall be level to +/-1/4" in all directions)	(Maximum soil cover shall not exceed 36" above the trench bottom)

Pump Requirements: _____ ft. TDH vs. _____ GPM _____ inches below pipe
 Aggregate Depth: _____ inches above pipe
 Conditions: START LINES AT 18" MINIMUM OF 6" OF COVER
NEEDED OVER DRAIN FIELD _____ inches total

**WATER LINES (INCLUDING IRRIGATION) MUST BE 10FT. FROM ANY PART OF SEPTIC SYSTEM OR REPAIR AREA.
NO UTILITIES ALLOWED IN INITIAL OR REPAIR DRAIN FIELD AREA.**

**If applicable: I understand the system type specified is different from the type specified on the application. I accept the specifications of this permit.

Owner/Legal Representative Signature: _____ Date: _____

This Construction Authorization is subject to revocation if the site plan, plat, or the intended use changes. The Construction Authorization shall not be transferred when there is a change in ownership of the site. This Construction Authorization is subject to compliance with the provisions of the Laws and Rules for Sewage Treatment and Disposal and to the conditions of this permit. SEE ATTACHED SITE SKETCH

Authorized State Agent: [Signature] REHS Date: 3/31/14
 Construction Authorization Expiration Date: 3/31/19

HTE# 14-5-32934R

Permit # 27919

Harnett County Department of Public Health Site Sketch

ISSUED TO: McNEILL MASONRY PROPERTY LOCATOR: NC27W
SUBDIVISION MOREQUITY REALTY LOT # 3

Authorized State Agent: ~~REHS (OLIVER TOLKSDORF)~~ Date: 3/31/14

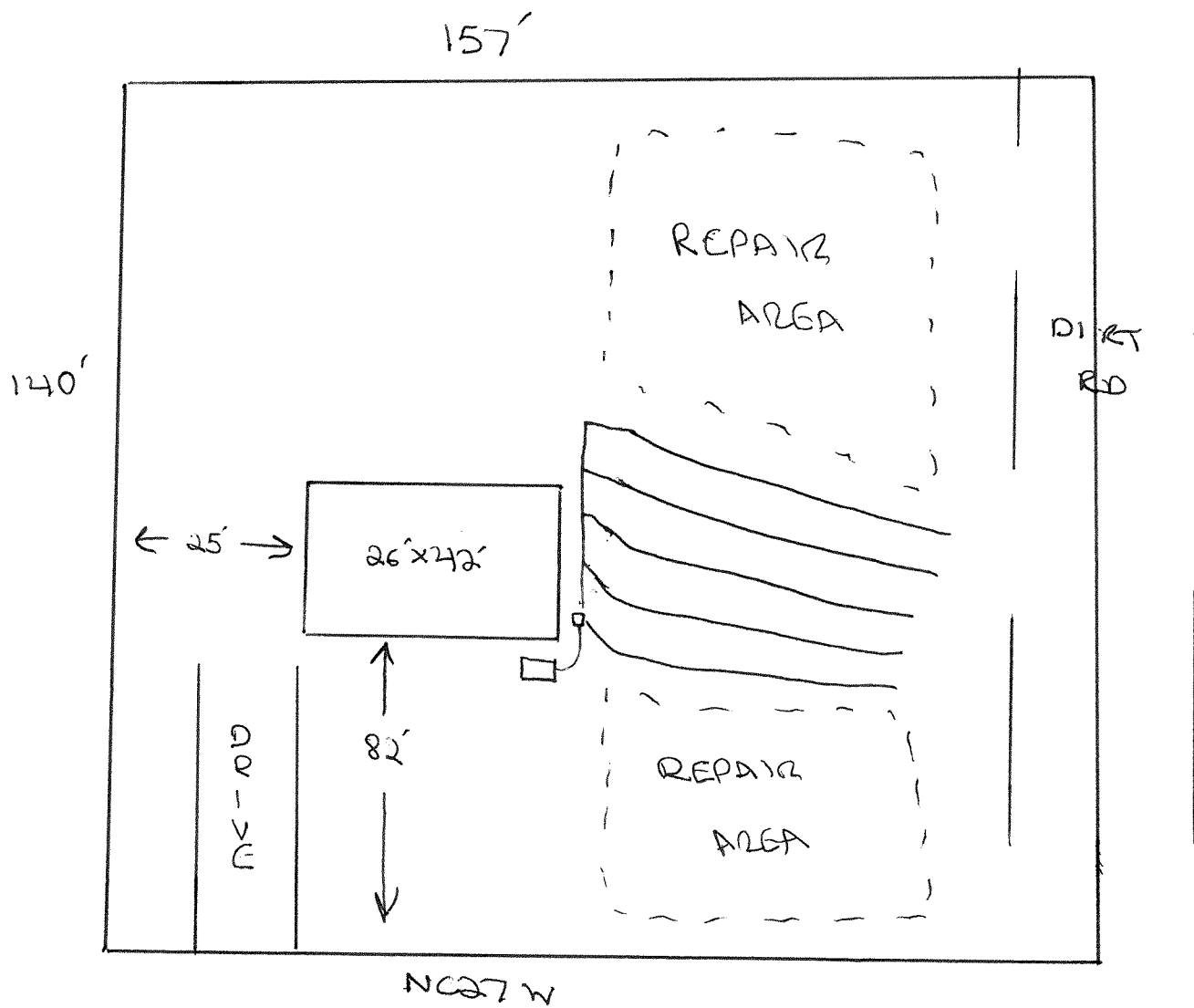

*DRAWING NTS