

SCANNED  
3/10/11  
DATE: 4/1/11

Application # 11-500-26231 R

Harnett County Central Permitting  
PO Box 65 Lillington, NC 27546  
910-893-7525 Fax 910-893-2793 www.harnett.org/permits

**Application for Permit in Town Zoning/Areas Zoned by Municipalities**

Land Owner Information:  
Name: William Hamm  
Address: 106 East "F" St  
Erwin N.C. 28339  
Phone: 910-897-2226

Applicant Information:  
Name: \_\_\_\_\_  
Address: SAME  
Phone: \_\_\_\_\_

Property Location:  
E911 Address: Bumpass Creek Access Rd State Road#: \_\_\_\_\_  
Parcel Number: 060596 0316 07 PIN: 0596-70-2410.000  
Subdivision: KENNETH D. POPE Lot Number: 1  
Lot Size: 1.18 Zoning: R201H Power Co\*: \_\_\_\_\_  
\* New structures with Progress Energy must provide premise number \_\_\_\_\_ from Progress Energy

Specific Directions to Job from Lillington: HWY 92 From Erwin  
Right on Bumpass Creek Access Rd, to Right of  
204 Bumpass Creek Access.

**Proposed Use:**

- Single Family Dwelling (Size: 32' x 64') # of Bedrooms: 3  
Basement: NA Basement w/ Plumbing: No Deck:  Slab or Crawl Space
- Multi Family Dwelling # of Units: \_\_\_\_\_ # of Bedrooms/Units: \_\_\_\_\_
- Manufactured Home (Size: \_\_\_\_\_ x \_\_\_\_\_) # of Bedrooms: \_\_\_\_\_  
Garage: \_\_\_\_\_ Deck: \_\_\_\_\_
- Business Square Footage Retail Space: \_\_\_\_\_ Type: \_\_\_\_\_
- Industry Size: \_\_\_\_\_ Type: \_\_\_\_\_ Use: \_\_\_\_\_
- Home Occupation # of Rooms: \_\_\_\_\_ Use: \_\_\_\_\_
- Addition to Existing Building Size: \_\_\_\_\_ Use: \_\_\_\_\_
- Other: \_\_\_\_\_

Water Supply:  County  Well  Other  
Sewage:  New Tank (Complete septic checklist)  Existing Septic (Complete septic checklist)  Sewer  
**There is a \$250.00 charge for new tanks, \$100 for existing tanks. This approval is subject to revocation if the intended use of the septic system changes or if false information is provided on this application.** Your signature below certifies all information above is correct.

Applicant Signature: William Hamm Date: 3-10-11

TOWN INFO  
CONF # 115762  
4/1/11 Customer ADDS A CONSTRUCTION TRAILER TO THE SITE  
& WANTS TO PICK UP TO THE SEPTIC SYSTEM  
WHILE THE HOME IS BEING CONSTRUCTED. THE TRAILER  
WILL BE REMOVED WITHIN 14 DAYS RECEIVE THE CO (RD) \$25.00



**TOWN OF ERWIN**

Post Office Box 459

Erwin, NC 28339

(910) 897-5140

**M-E-M-O-R-A-N-D-U-M**

**DATE:** March 24, 2011

**TO:** Note to File – Permit# 2011-005

**FROM:** Bryan T. Thompson, Town Manager 

**RE:** William Lamm – Addendum for Temporary Residents at Site of Single-family Dwelling Construction Site

---

The attached site plan is revised from 3/10/11. The revised site plan denotes the location and dimensions of proposed temporary residence to be occupied during the construction of the approved permanent primary single-family residential structure. The site plan and temporary use is in compliance with the Town of Erwin Zoning Ordinance.

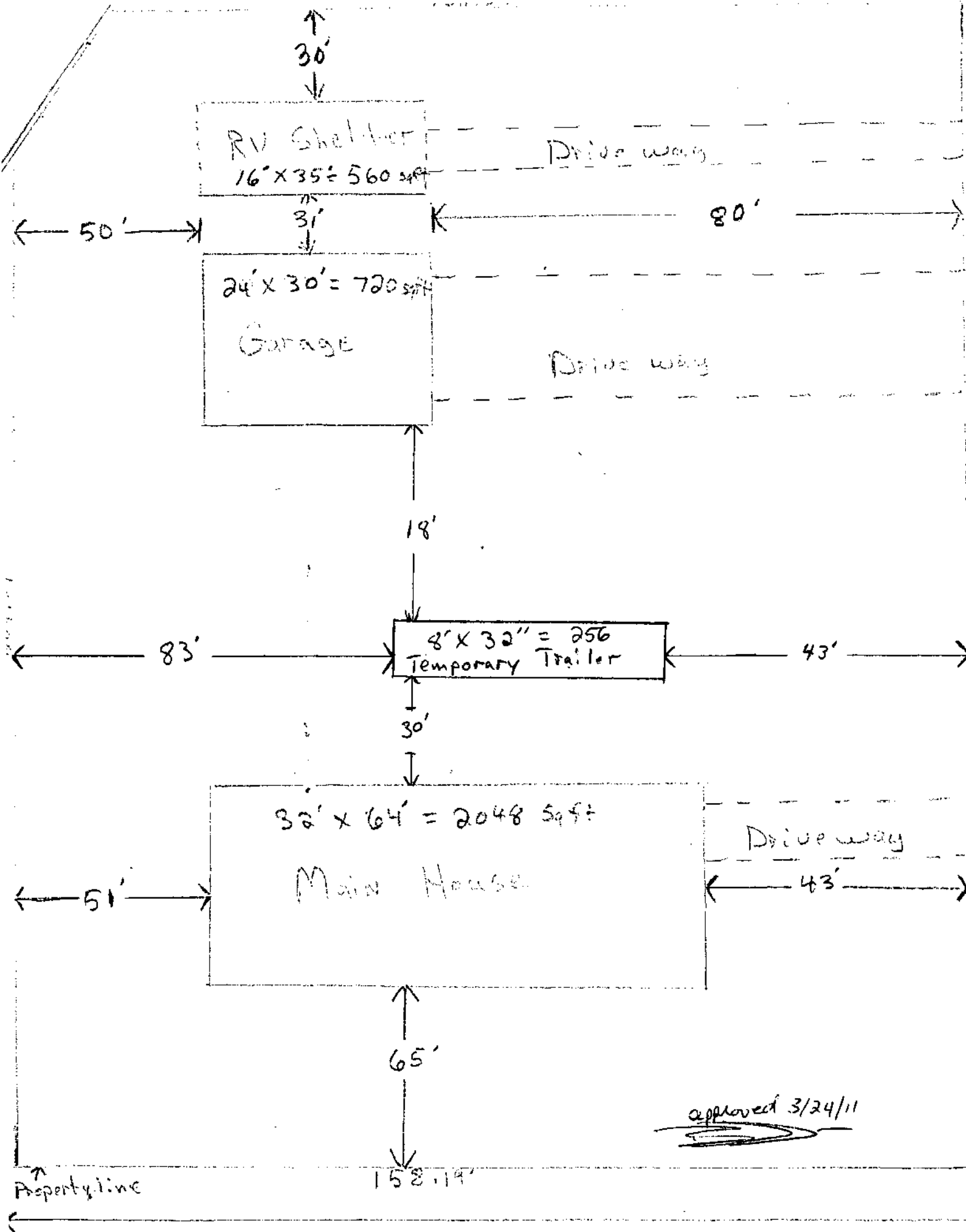

approved 3/24/11

Bumpass Creek Access #3

"Not to Scale"