

HTE# 09-5-21639

# Harnett County Department of Public Health

20890

PERMIT # 25445

## Operation Permit

New Installation  Septic Tank  Repair  Nitrification Line  Expansion

PROPERTY LOCATION: 511 Hwy 210W

Name: (owner) Marten + Samantha COX

SUBDIVISION \_\_\_\_\_

LOT # \_\_\_\_\_

System Installer: Jason Matthews

Registration # \_\_\_\_\_

Basement with plumbing:  Garage  Number of Bedrooms 4

Type of Water Supply:  Community  Public  Well Distance from well \_\_\_\_\_ feet

System Type: 25% REDUCED SYSTEM TYPE III 6-ETL Types V and VI Systems expire in 5 years.

(In accordance with Table V a) MANITEX 1/2" sch 80 valve Owner must contact Health Department 6 months prior to expiration for permit renewal.

This system has been installed in compliance with applicable North Carolina General Statutes, Rules for Sewage Treatment and Disposal, and all conditions of the Improvement Permit and Construction Authorization.

\* WATERLINE MOVED TO 12' OFF OF DRIVE LINES

\* SURVEYED WATERLINE AS CROSS ED SUPPLY IN FRONT OF HOVAC.

\* W/ RUN ON 11-6-09

\* NEEDS DRIVE ESTABLISHED FOR FILL - TO STAY OFF OF EXISTING DRIVE LINES.

DRIVE ESTABLISHED @ 3-11-10

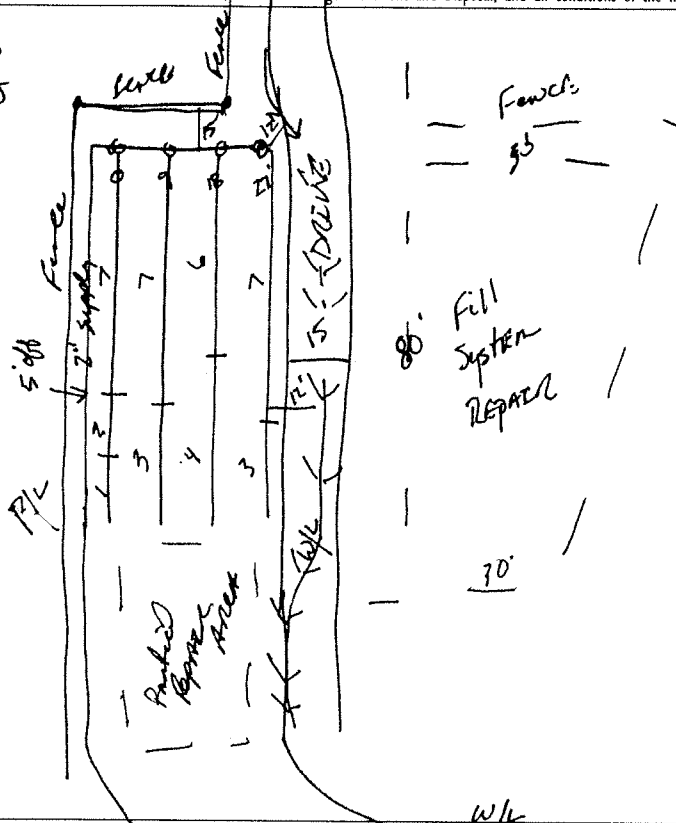

### PERMIT CONDITIONS:

I. Performance: System shall perform in accordance with Rule .1961.

II. Monitoring: As required by Rule .1961.

III. Maintenance: As required by Rule .1961. Other: \_\_\_\_\_

Subsurface system operator required? Yes  No

If yes, see attached sheet for additional operation conditions, maintenance and reporting.

IV. Operation: \_\_\_\_\_

V. Other: \_\_\_\_\_

Following are the specifications for the sewage disposal system on the above captioned property.

Type of system:  Conventional  Other MANITEX TO 25% REDUCED Septic Tank: 1000 gallons Pump Tank: 1000 gallons

Subsurface Drainage Field No. of ditches 4 exact length of each ditch 100 feet width of ditches 3 feet depth of ditches 30-18 inches

French Drain Required: \_\_\_\_\_ Linear feet

Authorized State Agent

James E. Matheson

Date

3/11/10  
James E. Matheson