

HTE# 06-5-15352

# Harris County Department of Public Health 18876

PERMIT # 23110

## Operation Permit

New Installation  Septic Tank  Repair  Nitrification Line  Expansion

PROPERTY LOCATION: SR1502 Wimberly RD

Name: (owner) PENNY DURKEE SUBDIVISION \_\_\_\_\_ LOT # \_\_\_\_\_

System Installer: ADIXX Excavation Registration # \_\_\_\_\_

Basement with plumbing:  Garage  Number of Bedrooms 3 BR

Type of Water Supply:  Community  Public  Well Distance from well \_\_\_\_\_ feet

System Type: Type III G CCR-227144 Types V and VI Systems expire in 5 years.

(In accordance with Table V a) Owner must contact Health Department 6 months prior to expiration for permit renewal.

This system has been installed in compliance with applicable North Carolina General Statutes, Rules for Sewage Treatment and Disposal, and all conditions of the Improvement Permit and Construction Authorization.

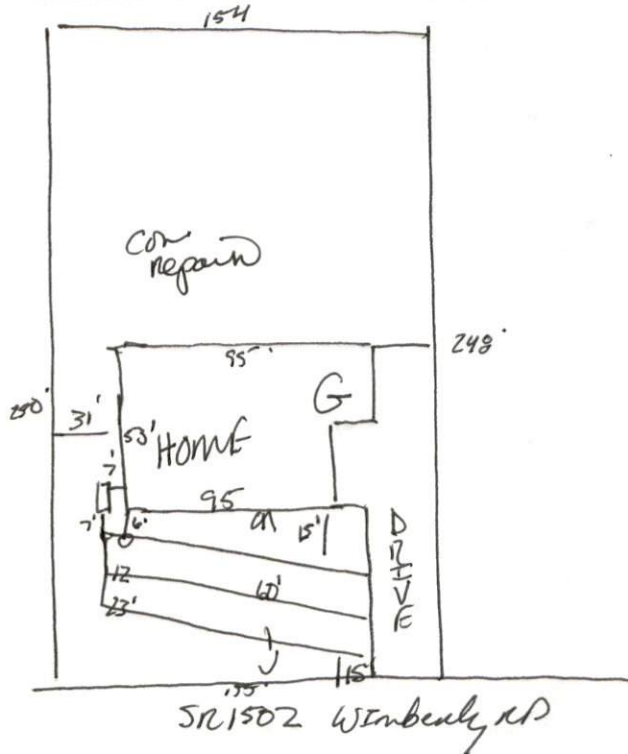

### PERMIT CONDITIONS:

- I. Performance: System shall perform in accordance with Rule .1961.
- II. Monitoring: As required by Rule .1961.
- III. Maintenance: As required by Rule .1961. Other: \_\_\_\_\_  
Subsurface system operator required? Yes  No   
If yes, see attached sheet for additional operation conditions, maintenance and reporting.
- IV. Operation: \_\_\_\_\_
- V. Other: \_\_\_\_\_

Following are the specifications for the sewage disposal system on the above captioned property.

Type of system:  Conventional  Other Type III G 250' 16" 2" 1/2" 16" 2" 1/2" Size of tank: Septic Tank: 1000 gallons Pump Tank: \_\_\_\_\_ gallons

Subsurface No. of exact length width of depth of  
Drainage Field ditches 3 of each ditch 80 feet ditches 3 feet ditches 24 inches

French Drain Required: - Linear feet

Authorized State Agent James E. Manhart Date 10-30-06