

## HARNETT COUNTY HEALTH DEPARTMENT

HTE 05-5-1178272

## IMPROVEMENT PERMIT

22176

Be it ordained by the Harnett County Board of Health as follows: Section III, Item B. "No Person shall begin construction of any building at which a septic tank system is to be used for disposal of sewage without first obtaining a written permit from the Harnett County Health Department."

Name: (owner) Carolyn Suggs Dorman☒ New Installation☒ Septic TankProperty Location: SR# 1703 RED HILL CHURCH RD☐ Repairs☒ Nitrification LineSubdivision CSDLot # 4

Tax ID # \_\_\_\_\_

Quadrant # \_\_\_\_\_

Number of Bedrooms Proposed: 3 360 GPDLot Size: .61Basement with Plumbing: ☐Garage: ☐Water Supply: ☐ Well☒ Public☐ CommunityDistance From Well: 50' ft.

Following is the minimum specifications for sewage disposal system on above captioned property. Subject to final approval.

Type of system:

☒ Conventional☐ Other \_\_\_\_\_

Size of tank:

Septic Tank: 1000 gallons

Pump Tank: \_\_\_\_\_ gallons

Subsurface

No. of

2

exact length

160

width of

depth of

Drainage Field

ditches

4

of each ditch

80

ft.

ditches

3

ft.

ditches

18-24 in.French Drain Required: -

Linear feet

Date: 8-4-05

This permit is subject to revocation if site plans or intended use change.

Signed James E. Montant

Environmental Health Specialist

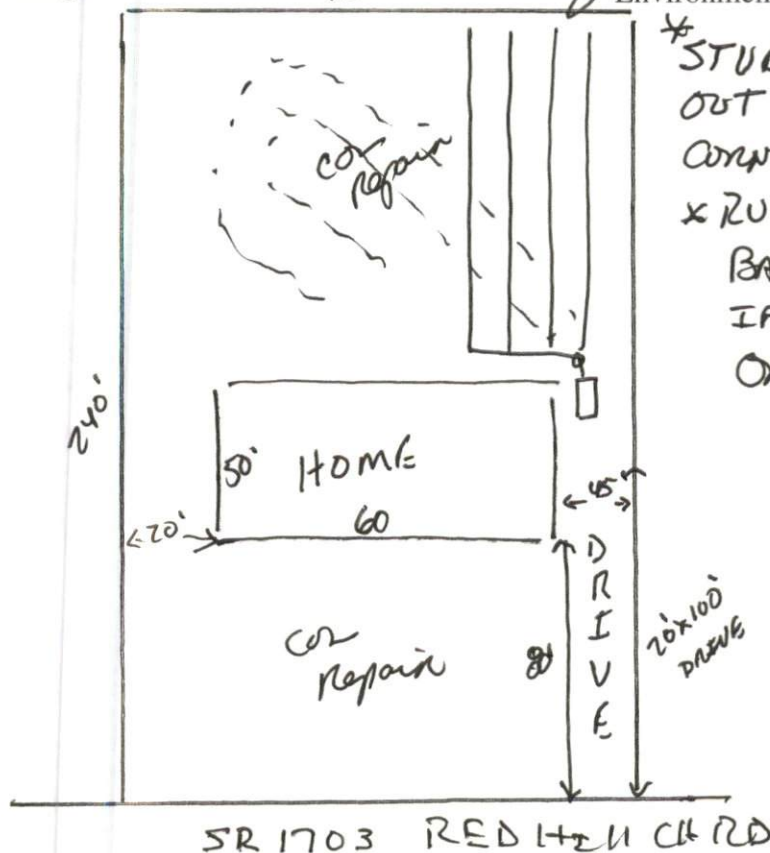

HARNETT COUNTY DEPARTMENT OF PUBLIC HEALTH  
AUTHORIZATION TO CONSTRUCT

Authorization is hereby given to construct a wastewater system to the specifications described by Harnett County Department of Public Health, Improvement Permit # 22176. This authorization shall be valid for a period not to exceed five (5) years from the date of issuance. *This authorization will be invalid if ownership, site plans, or intended use change.*

Name CAROLYN SUGGS DORMAN Telephone # 910-897-4340

Address 205 PENNELL DR Ennis N.C. 28339

Property Location SR# 1703 Road Name Red Hill CH RD

Subdivision CSD Lot # 4 # Bedrooms Proposed 3 (360 gal) Lot Size .69

**TYPE OF SYSTEM**

[ ☒ ] New Installation [ ] Repair [ ☒ ] Septic Tank [ ☒ ] Nitrification Lines

[ ☒ ] Conventional [ ] Other \_\_\_\_\_

[ ] Basement [ ] With Plumbing [ ] Without Plumbing

Water Supply: [ ] Well [ ☒ ] Public Water Supply Minimum Well Setback: \_\_\_\_\_ Ft.

Septic Tank 1000 gal Pump Chamber \_\_\_\_\_ gal

**NITRIFICATION FIELD SPECIFICATIONS**

Number of fields 2 # of lines per field 4 Length of lines 80 Ft.

Width of ditches 3 ft. Depth of ditches 18-24 <sup>max</sup> inches

French Drain: Linear feet required \_\_\_\_\_ Depth of gravel -

No wastewater system shall be covered or placed into use by any person until an inspection by the Harnett County Health Department has determined that the system has been installed according to the conditions of the Improvement Permit and that a valid Operations Permit has been issued.

James E. Manhart  
Signature of Authorized Agent for Harnett County

8-4-05  
Date