

HARNETT COUNTY HEALTH DEPARTMENT

No 19862

IMPROVEMENT PERMIT

Be it ordained by the Harnett County Board of Health as follows: Section III, Item B. "No Person shall begin construction of any building at which a septic tank system is to be used for disposal of sewage without first obtaining a written permit from the Harnett County Health Department."

Name: (owner) Gregory Inc

New Installation Septic Tank

Property Location: SR# Hwy 55

Repairs Nitrification Line

Subdivision Braxton Lot # 8

Tax ID # _____ Quadrant # _____

Number of Bedrooms Proposed: 5 Lot Size: 30,188.30 sq FT

Basement with Plumbing: Garage:

Water Supply: Well Public Community

Distance From Well: 50' ft.

Following is the minimum specifications for sewage disposal system on above captioned property. Subject to final approval.

Type of system: Conventional Other I+E SYSTEM. PAT-FEE-221147 TWWS-95-3R

Size of tank: Septic Tank: 1200 gallons Pump Tank: _____ gallons

Subsurface Drainage Field No. of ditches 5 exact length of each ditch 80 ft. width of ditches 3 ft. depth of ditches 22 → 18 in.

French Drain Required: - Linear feet

Date: 12-9-02

This permit is subject to revocation if site plans or intended use change.

Signed: James E. Marshall

Environmental Health Specialist

Maintain all setbacks

*Contractor to MEET ON SITE PRIOR TO INSTALLATION.

*STUB Plumbing OUT ABOVE GRADE AT LOCATION SHOWN ON PERMIT. prep may be required.

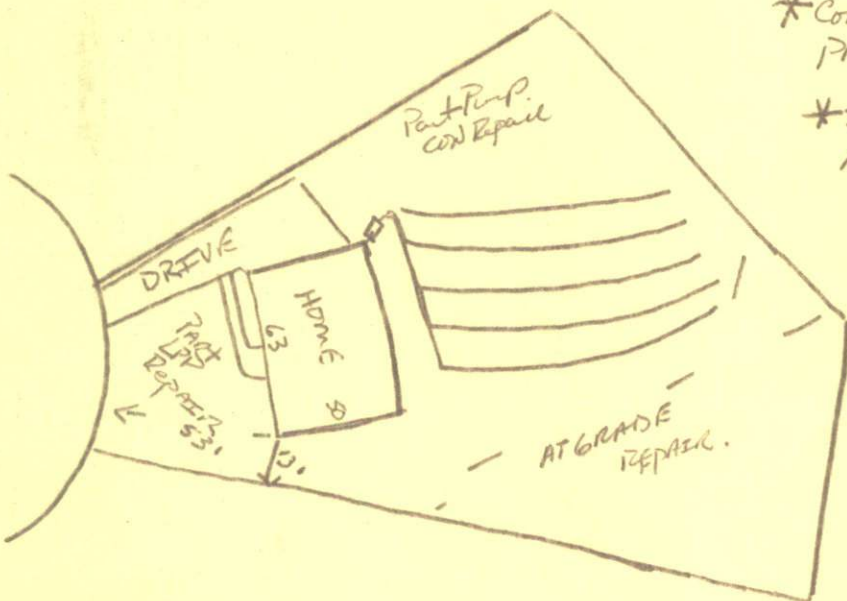

#03-5-5945

HARNETT COUNTY HEALTH DEPARTMENT
AUTORIZATION TO CONSTRUCT

Authorization is hereby given to construct a wastewater system to the specifications described by Harnett County Health Department, Improvement Permit # 19862. This authorization shall be valid for a period not to exceed five (5) years from the date of issuance. This authorization will be invalid if ownership, site plans, or intended use change.

Name Gregory Inc Telephone # 919-639-4516

Address 800-A N. Raleigh St Angier N.C. 27501

Property Location SR# Hwy 55 Road Name 55

Subdivision Braxton Lot # 8 # Bedrooms Proposed 5 Lot size 30,000 sq ft

TYPE OF SYSTEM

[] New Installation [] Repair [] Septic Tank [] Nitrification Lines
[] Conventional [] Other RFE-202UM [] Basement [] With Plumbing [] Without Plumbing

Water Supply: [] Well [] Public - Minimum Well Setback: 50 Ft.
Septic Tank 1200 Pump Chamber _____

NITRIFICATION FIELD SPECIFICATIONS

Number of fields 2 # of lines per field 5 Length of lines 50 Ft.

Width of ditches 3 ft. Depth of ditches 22-24 inches

French Drain: Linear feet required _____ Depth of gravel _____

No wastewater system shall be covered or placed into use by any person until an inspection by the Harnett County Health Department has determined that the system has been installed according to the conditions of the Improvement Permit and that a valid Operations Permit has been issued.

Signature of Authorized Agent for Harnett County James E. Marshall Date 12-9-02