

03-5-5585

HARNETT COUNTY HEALTH DEPARTMENT

No 19661

IMPROVEMENT PERMIT

Be it ordained by the Harnett County Board of Health as follows: Section III, Item B. "No Person shall begin construction of any building at which a septic tank system is to be used for disposal of sewage without first obtaining a written permit from the Harnett County Health Department."

Name: (owner) JEFF BARNES New Installation Septic Tank
Property Location: SR# HWY 210 Repairs Nitrification Line

Subdivision _____ Lot # _____

Tax ID # _____ Quadrant # _____

Number of Bedrooms Proposed: AUTO REPAIR SHOP (2 EMPLOYEES) Lot Size: _____

Basement with Plumbing: Garage:

Water Supply: Well Public Community

Distance From Well: 100 ft.

Following is the minimum specifications for sewage disposal system on above captioned property. Subject to final approval.

Type of system: Conventional Other PUMP TO CONVENTIONAL

Size of tank: Septic Tank: 1000 gallons Pump Tank: 1000 gallons

Subsurface Drainage Field No. of ditches 2 exact length of each ditch 70 ft. width of ditches 3 ft. depth of ditches 22 in. ^{MAX}

French Drain Required: _____ Linear feet

Date: 10/4/03

This permit is subject to revocation if site plans or intended use change.

Signed: [Signature] (OLIVER TOLKSDORF)

Environmental Health Specialist

DRAWING NTS

- * MAINTAIN ALL SETBACKS
- * SEPTIC FIELD LOCATION REQUESTED BY APPLICANT
- * TANKS NEED TO BE FENCED IN OR BE TRAFFIC RATED.
- * CALL WITH ANY QUESTIONS PRIOR TO INSTALLATION

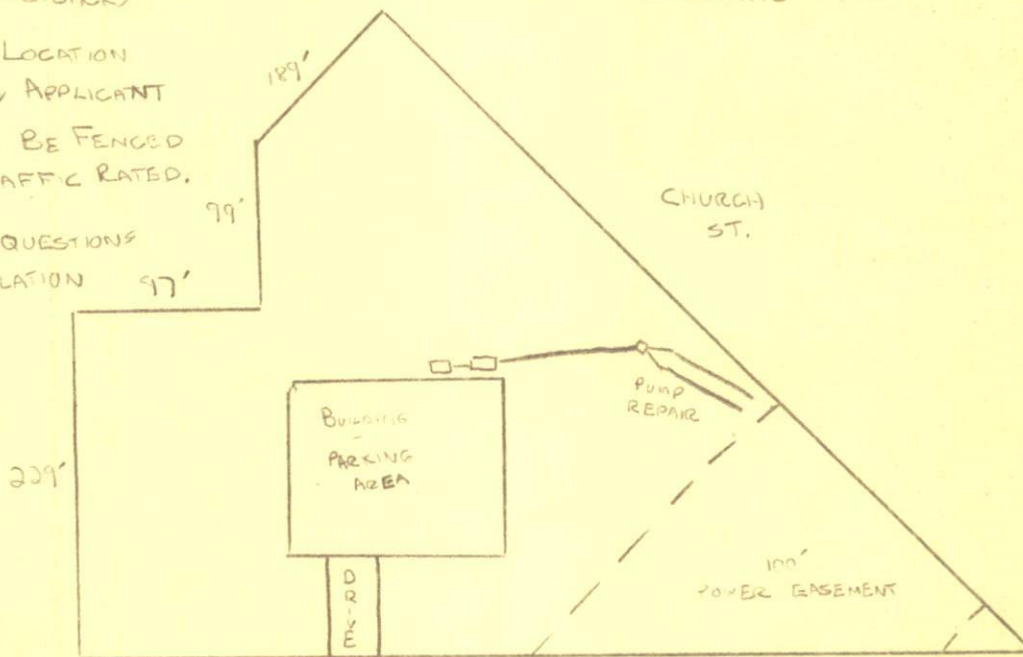

HWY 210

TANKS CHECKED BY BM ON 5/27/03

H HERT COUNTY HEALTH DEPARTMENT
AUTHORIZATION TO CONSTRUCT

Authorization is hereby given to construct a wastewater system to the specifications described by Harnett County Health Department, Improvement Permit # 19661. This authorization shall be valid for a period not to exceed five (5) years from the date of issuance. This authorization will be invalid if ownership, site plans, or intended use change.

JEFF BARNES (W) 919-639-2406
Name Telephone # (H) 919-639-7040

72 BRIGHTLEAF CT. ANGIER NC 27501
Address

NC 210 Property Location SR# Road Name

Subdivision Auto Repair Shop Lot # # Bedrooms Proposed Lot size

TYPE OF SYSTEM

New Installation Repair Septic Tank Nitrification Lines

Conventional Other: PUMP TO CONVENTIONAL

Basement With Plumbing Without Plumbing

Water Supply: Well Public - Minimum Well Setback: 100 Ft.

Septic Tank 1000 gal Pump Chamber 1000 gal

NITRIFICATION FIELD SPECIFICATIONS

Number of fields 1 # of lines per field 2 Length of lines 70 Ft.

Width of ditches 3 ft. Depth of ditches 22 inches

French Drain: Linear feet required _____ Depth of gravel _____

No wastewater system shall be covered or placed into use by any person until an inspection by the Harnett County Health Department has determined that the system has been installed according to the conditions of the Improvement Permit and that a valid Operations Permit has been issued.

[Signature]
Signature of Authorized Agent for Harnett County

10/4/12
Date