

#02-5-3857

HARNETT COUNTY HEALTH DEPARTMENT

No 18777

IMPROVEMENT PERMIT

Be it ordained by the Harnett County Board of Health as follows: Section III, Item B. "No Person shall begin construction of any building at which a septic tank system is to be used for disposal of sewage without first obtaining a written permit from the Harnett County Health Department."

Name: (owner) DEWEY M Blalock

New Installation Septic Tank

Property Location: SR# 1415 Rays Church Rd

Repairs Nitrification Line

Subdivision _____ Lot # 2

Tax ID # _____ Quadrant # _____

Number of Bedrooms Proposed: 3 Lot Size: 1.863

Basement with Plumbing: Garage:

Water Supply: Well Public Community

Distance From Well: 50' ft.

Following is the minimum specifications for sewage disposal system on above captioned property. Subject to final approval.

Type of system: Conventional Other _____

Size of tank: Septic Tank: 1000 gallons Pump Tank: _____ gallons

Subsurface Drainage Field No. of ditches 3 exact length of each ditch 100 ft. width of ditches 3 ft. depth of ditches 18-22 in.

French Drain Required: - Linear feet

Date: 2-11-02

This permit is subject to revocation if site plans or intended use change.

Signed: James E. Markant Jr. R.S.
Environmental Health Specialist

Maintain all setbacks.

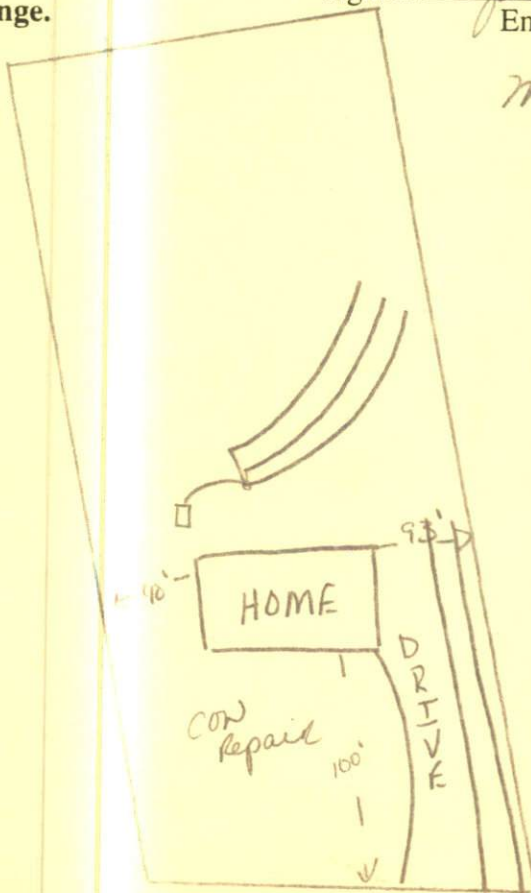

SR 1415-

HARNETT COUNTY HEALTH DEPARTMENT
AUTHORIZATION TO CONSTRUCT

Authorization is hereby given to construct a wastewater system to the specifications described by Harnett County Health Department, Improvement Permit # 18777. This authorization shall be valid for a period not to exceed five (5) years from the date of issuance. This authorization will be invalid if ownership, site plans, or intended use change.

Name DEWEY M Blalock Telephone # 910-893-2886

Address 265 Tripp Rd Lillington N.C. 27546

Property Location SR# 1415 Road Name Rawls Church

Subdivision - Lot # 1 # Bedrooms Proposed 3 Lot size 1.863

TYPE OF SYSTEM

New Installation Repair Septic Tank Nitrification Lines
 Conventional Other _____

Basement With Plumbing Without Plumbing

Water Supply: Well Public - Minimum Well Setback: _____ Ft.

NITRIFICATION FIELD SPECIFICATIONS

Number of fields 2 # of lines per field 3 Length of lines 100 Ft.

Width of ditches 3 ft. Depth of ditches 18-22 inches

French Drain: Linear feet required - Depth of gravel -

No wastewater system shall be covered or placed into use by any person until an inspection by the Harnett County Health Department has determined that the system has been installed according to the conditions of the Improvement Permit and that a valid Operations Permit has been issued.

Signature of Authorized Agent for Harnett County James E. Manhart Date 2-11-02