

Initial Application Date: 4/12/18

Application # 1850043786

CU# \_\_\_\_\_

COUNTY OF HARNETT RESIDENTIAL LAND USE APPLICATION  
Central Permitting 108 E. Front Street, Lillington, NC 27546 Phone: (910) 893-7525 ext.2 Fax: (910) 893-2793 www.harnett.org/permits

**\*\*A RECORDED SURVEY MAP, RECORDED DEED (OR OFFER TO PURCHASE) & SITE PLAN ARE REQUIRED WHEN SUBMITTING A LAND USE APPLICATION\*\***

LANDOWNER: Mark & Lori Langdon Mailing Address: 186 Huntington Dr.  
City: Dunn State: NC Zip: 28334 Contact No: 919-820-5576 Email: \_\_\_\_\_

APPLICANT\*: Same Mailing Address: \_\_\_\_\_  
City: \_\_\_\_\_ State: \_\_\_\_\_ Zip: \_\_\_\_\_ Contact No: \_\_\_\_\_ Email: \_\_\_\_\_  
\*Please fill out applicant information if different than landowner

CONTACT NAME APPLYING IN OFFICE: Mark Langdon Phone # 919-820-5576

PROPERTY LOCATION: Subdivision: Huntington Lot #: 5 Lot Size: .58  
State Road # 1918 State Road Name: Huntington Dr. Map Book & Page: - 1 -  
Parcel: 071519 0042 07 PIN: 1508-87-3616.000  
Zoning: R-30 Flood Zone: X Watershed: NO Deed Book & Page: 1339, 498 Power Company\*: \_\_\_\_\_

\*New structures with Progress Energy as service provider need to supply premise number \_\_\_\_\_ from Progress Energy.

**PROPOSED USE:**

- SFD: (Size 57x65) # Bedrooms: 5 # Baths: 4.5 Basement(w/w bath): \_\_\_\_\_ Garage:  Deck: \_\_\_\_\_ Crawl Space:  Slab: \_\_\_\_\_  
(Is the bonus room finished? ( ) yes ( ) no w/ a closet? ( ) yes ( ) no (if yes add in with # bedrooms))
- Mod: (Size \_\_\_\_\_ x \_\_\_\_\_) # Bedrooms \_\_\_\_\_ # Baths \_\_\_\_\_ Basement (w/w bath) \_\_\_\_\_ Garage: \_\_\_\_\_ Site Built Deck: \_\_\_\_\_ On Frame \_\_\_\_\_ Off Frame \_\_\_\_\_  
(Is the second floor finished? ( ) yes ( ) no Any other site built additions? ( ) yes ( ) no
- Manufactured Home: \_\_\_\_\_ SW \_\_\_\_\_ DW \_\_\_\_\_ TW (Size \_\_\_\_\_ x \_\_\_\_\_) # Bedrooms: \_\_\_\_\_ Garage: \_\_\_\_\_ (site built? \_\_\_\_\_) Deck: \_\_\_\_\_ (site built? \_\_\_\_\_)
- Duplex: (Size \_\_\_\_\_ x \_\_\_\_\_) No. Buildings: \_\_\_\_\_ No. Bedrooms Per Unit: \_\_\_\_\_
- Home Occupation: # Rooms: \_\_\_\_\_ Use: \_\_\_\_\_ Hours of Operation: \_\_\_\_\_ #Employees: \_\_\_\_\_
- Addition/Accessory/Other: (Size \_\_\_\_\_ x \_\_\_\_\_) Use: \_\_\_\_\_ Closets in addition? ( ) yes ( ) no

Water Supply: \_\_\_\_\_ County \_\_\_\_\_ Existing Well \_\_\_\_\_ New Well (# of dwellings using well \_\_\_\_\_) \*Must have operable water before final

Sewage Supply: \_\_\_\_\_ New Septic Tank (Complete Checklist) \_\_\_\_\_ Existing Septic Tank (Complete Checklist) \_\_\_\_\_ County Sewer

Does owner of this tract of land, own land that contains a manufactured home within five hundred feet (500') of tract listed above? ( ) yes ( ) no

Does the property contain any easements whether underground or overhead ( ) yes ( ) no

Structures (existing or proposed): Single family dwellings: \_\_\_\_\_ Manufactured Homes: \_\_\_\_\_ Other (specify): \_\_\_\_\_

**Required Residential Property Line Setbacks:**

	Minimum	Actual
Front	_____	_____
Rear	_____	_____
Closest Side	_____	_____
Sidestreet/corner lot	_____	_____
Nearest Building on same lot	_____	_____

Comments: Customer has a 5 bedroom home but tank is only big enough for a 3 bedroom home.

4-12-18  
N

SPECIFIC DIRECTIONS TO THE PROPERTY FROM LILLINGTON: \_\_\_\_\_

If permits are granted I agree to conform to all ordinances and laws of the State of North Carolina regulating such work and the specifications of plans submitted. I hereby state that foregoing statements are accurate and correct to the best of my knowledge. Permit subject to revocation if false information is provided.

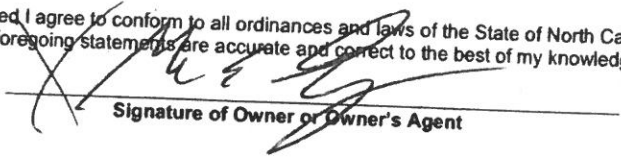
  
Signature of Owner or Owner's Agent

4-12-18  
Date

\*\*\*It is the owner/applicants responsibility to provide the county with any applicable information about the subject property, including but not limited to: boundary information, house location, underground or overhead easements, etc. The county or its employees are not responsible for any incorrect or missing information that is contained within these applications.\*\*\*

\*\*This application expires 6 months from the initial date if permits have not been issued\*\*

① Front New Road  
0-26 LS  
26-38 SLL C2@38'

②③ Rear corners Soft Bulk  
0-32 LS  
32-48 SLL

\*43ft from end last drainline  
to edge of <sup>cul de sac</sup> ~~cul de sac~~ (not P.O.L.)

\*NO Property Icons

# OPERATIONS PERMIT

Name: (owner) Ernie & JoEllen Tart  New Installation  Septic Tank  
Property Location: SR# 1703  Repairs  Nitrification Line  
Subdivision Huntington Lot # 5  
TAX ID# \_\_\_\_\_ Quadrant # \_\_\_\_\_  
Contractor: Gerard Temple Registration # \_\_\_\_\_

Basement with Plumbing:  Garage:   
Water Supply:  Well  Public  Community  
Distance From Well: 50 ft.

Following are the specifications for the sewage disposal system on above captioned property.

Type of system:  Conventional  Other \_\_\_\_\_

Size of tank: Septic Tank: 1000 gallons Pump Tank: \_\_\_\_\_ gallons

Subsurface Drainage Field No. of ditches 4 exact length of each ditch 75 ft. width of ditches 3 ft. depth of ditches 18-22 in.

French Drain: \_\_\_\_\_ Linear feet

Date: 8/25/99

PERMIT NO. 15191

Inspected by: Benjamin McSwain R.S.  
Environmental Health Specialist

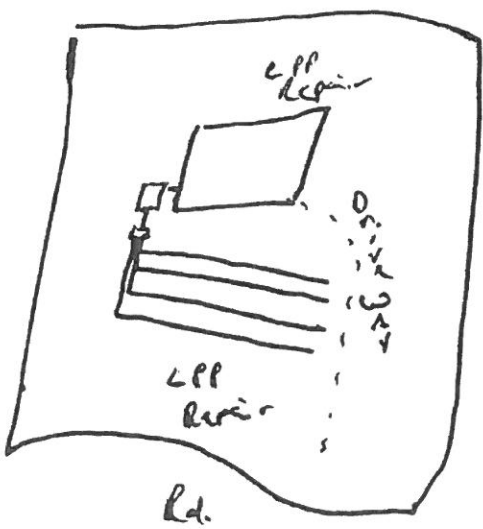

# IMPROVEMENT PERMIT

Be it ordained by the Harnett County Board of Health as follows: Section III, Item B. "No Person shall begin construction of any building at which a septic tank system is to be used for disposal of sewage without first obtaining a written permit from the Harnett County Health Department."

Name: (owner) Ernie & Jo Ellen Tart  New Installation  Septic Tank  
 Property Location: SR# 1703 Red Hill Ch. Rd.  Repairs  Nitrification Line

Subdivision Huntington Lot # 5

Tax ID # \_\_\_\_\_ Quadrant # \_\_\_\_\_

Number of Bedrooms Proposed: 3 Lot Size: \_\_\_\_\_

Basement with Plumbing:  Garage:

Water Supply:  Well  Public  Community

Distance From Well: 50 min ft.

Following is the minimum specifications for sewage disposal system on above captioned property. Subject to final approval.

Type of system:  Conventional  Other \_\_\_\_\_

Size of tank: Septic Tank: 1000 gallons Pump Tank: \_\_\_\_\_ gallons

Subsurface Drainage Field No. of 4 exact length 75 width of 3 depth of 18-20 in.  
 ditches of each ditch ft. ditches ft. ditches in.

French Drain Required: \_\_\_\_\_ Linear feet

Date: 1/6/99

This permit is subject to revocation if site plans or intended use change.

Signed: Royan McSwain R.S.  
 Environmental Health Specialist

\* Maintain all required setbacks

\* Risers will be required on the septic tank



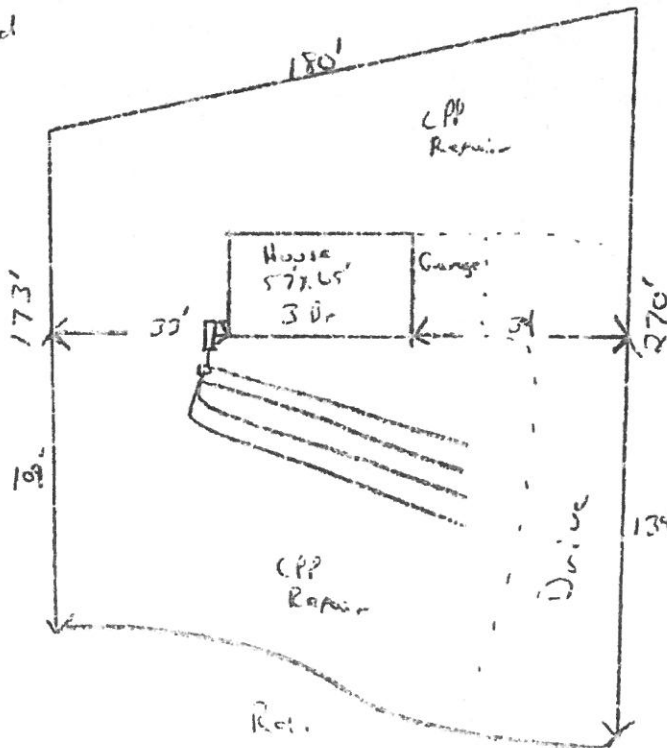













\* Filters will be required in the "Tee"

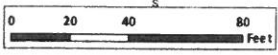

# Harnett GIS

NOT FOR LEGAL USE



 <b>Harnett COUNTY</b> FOOT PROTECTS	 Recycle Center	 City Limits	 NC	 Parcels
	 Landfills	 Address Numbers	 US	
GIS/E-911 Addressing April 12, 2018	 Surrounding County Boundaries	 Airport	 Roads	
	 Federal Property	<b>Major Roads</b>	 Mile_Markers	1 inch = 47 feet
		 Interstate	 Railroad	

REPAIR?

NAME: \_\_\_\_\_

APPLICATION #: 43780

**\*This application to be filled out when applying for a septic system inspection.\***

**County Health Department Application for Improvement Permit and/or Authorization to Construct**

IF THE INFORMATION IN THIS APPLICATION IS FALSIFIED, CHANGED, OR THE SITE IS ALTERED, THEN THE IMPROVEMENT PERMIT OR AUTHORIZATION TO CONSTRUCT SHALL BECOME INVALID. The permit is valid for either 60 months or without expiration depending upon documentation submitted. (Complete site plan = 60 months; Complete plat = without expiration)

910-893-7525 option 1

CONFIRMATION # 027219-4/12/18

**Environmental Health New Septic System** Code 800

- **All property irons must be made visible.** Place "pink property flags" on each corner iron of lot. All property lines must be clearly flagged approximately every 50 feet between corners.
- Place "orange house corner flags" at each corner of the proposed structure. Also flag driveways, garages, decks, out buildings, swimming pools, etc. Place flags per site plan developed at/for Central Permitting.
- Place orange Environmental Health card in location that is easily viewed from road to assist in locating property.
- If property is thickly wooded, Environmental Health requires that you clean out the undergrowth to allow the soil evaluation to be performed. Inspectors should be able to walk freely around site. **Do not grade property.**
- **All lots to be addressed within 10 business days after confirmation. \$25.00 return trip fee may be incurred for failure to uncover outlet lid, mark house corners and property lines, etc. once lot confirmed ready.**
- After preparing proposed site call the voice permitting system at 910-893-7525 option 1 to schedule and use code **800** (after selecting notification permit if multiple permits exist) for Environmental Health inspection. Please note confirmation number given at end of recording for proof of request.
- Use Click2Gov or IVR to verify results. Once approved, proceed to Central Permitting for permits.

**Environmental Health Existing Tank Inspections** Code 800

- Follow above instructions for placing flags and card on property.
- Prepare for inspection by removing soil over **outlet end** of tank as diagram indicates, and lift lid straight up (*if possible*) and then **put lid back in place.** (Unless inspection is for a septic tank in a mobile home park)
- **DO NOT LEAVE LIDS OFF OF SEPTIC TANK**
- After uncovering **outlet end** call the voice permitting system at 910-893-7525 option 1 & select notification permit if multiple permits, then use code **800** for Environmental Health inspection. Please note confirmation number given at end of recording for proof of request.
- Use Click2Gov or IVR to hear results. Once approved, proceed to Central Permitting for remaining permits.

**SEPTIC**

If applying for authorization to construct please indicate desired system type(s): can be ranked in order of preference, must choose one.

- Accepted       Innovative       Conventional       Any  
 Alternative       Other \_\_\_\_\_

The applicant shall notify the local health department upon submittal of this application if any of the following apply to the property in question. If the answer is "yes", applicant **MUST ATTACH SUPPORTING DOCUMENTATION**:

- YES     NO    Does the site contain any Jurisdictional Wetlands?  
 YES     NO    Do you plan to have an irrigation system now or in the future?  
 YES     NO    Does or will the building contain any drains? Please explain. \_\_\_\_\_  
 YES     NO    Are there any existing wells, springs, waterlines or Wastewater Systems on this property?  
 YES     NO    Is any wastewater going to be generated on the site other than domestic sewage?  
 YES     NO    Is the site subject to approval by any other Public Agency?  
 YES     NO    Are there any Easements or Right of Ways on this property?  
 YES     NO    Does the site contain any existing water, cable, phone or underground electric lines?

If yes please call No Cuts at 800-632-4949 to locate the lines. This is a free service.

**I Have Read This Application And Certify That The Information Provided Herein Is True, Complete And Correct. Authorized County And State Officials Are Granted Right Of Entry To Conduct Necessary Inspections To Determine Compliance With Applicable Laws And Rules.**

**I Understand That I Am Solely Responsible For The Proper Identification And Labeling Of All Property Lines And Corners And Making The Site Accessible So That A Complete Site Evaluation Can Be Performed.**

PROPERTY OWNERS OR OWNERS LEGAL REPRESENTATIVE SIGNATURE (REQUIRED)

DATE

4-12-18