

Improvement Permit

A building permit cannot be issued with only an Improvement Permit

ISSUED TO: EHC Properties LLC PROPERTY LOCATION: EX-1841 Access RD
 NEW REPAIR EXPANSION SUBDIVISION _____ LOT # 4
 Type of Structure: 100X80 METAL BLDG Site Improvements required prior to Construction Authorization Issuance: _____
 Proposed Wastewater System Type: 254 Red
 Projected Daily Flow: 375 GPD
 Number of bedrooms: _____ Number of Occupants: 15 Employee
 Basement Yes No
 Pump Required: Yes No May be required based on final location and elevations of facilities
 Type of Water Supply: Community Public Well Distance from well 50'+ feet Permit valid for: Five years
 Permit conditions: _____ No expiration

Authorized State Agent: James E Markham Date: 5-20-16 SEE ATTACHED SITE SKETCH
 The issuance of this permit by the Health Department in no way guarantees the issuance of other permits. The permit holder is responsible for checking with appropriate governing bodies in meeting their requirements. This site is subject to revocation if the site plan, plat, or the intended use changes. The Improvement Permit shall not be affected by a change in ownership of the site. This permit is subject to compliance with the provisions of the Laws and Rules for Sewage Treatment and Disposal and to conditions of this permit.

Construction Authorization

(Required for Building Permit)

The construction and installation requirements of Rules .1950, .1952, .1954, .1955, .1956, .1957, .1958, and .1959 are incorporated by references into this permit and shall be met. Systems shall be installed in accordance with the attached system layout.

ISSUED TO: EHC Properties LLC PROPERTY LOCATION: EX-1841 Access RD
 Facility Type: Metal BLDG New Expansion Repair
 Basement? Yes No Basement Fixtures? Yes No
 Type of Wastewater System** Pip to 254 Red (Initial) Wastewater Flow: 375 GPD
 (See note below, if applicable)
Pip to 204 Red (Repair)
 Installation Requirements/Conditions
 Septic Tank Size 1000 gallons Number of trenches 3
 Pump Tank Size 1000 gallons Exact length of each trench 100 feet Trench Spacing: 9 Feet on Center
 Trenches shall be installed on contour at a Soil Cover: 6 inches
 Maximum Trench Depth of: 20-1/8 inches (Maximum soil cover shall not exceed
 (Trench bottoms shall be level to +/-1/4" 36" above the trench bottom)
 in all directions)
 Pump Requirements: _____ ft. TDH vs. _____ GPM Aggregate Depth: 6 inches below pipe
2 inches above pipe
 Conditions: Contractor to meet ON SITE
prior to INSTALL
12 inches total

WATER LINES (INCLUDING IRRIGATION) MUST BE 10FT. FROM ANY PART OF SEPTIC SYSTEM OR REPAIR AREA.
NO UTILITIES ALLOWED IN INITIAL OR REPAIR DRAIN FIELD AREA.

**If applicable: I understand the system type specified is different from the type specified on the application. I accept the specifications of this permit.

Owner/Legal Representative Signature: _____ Date: _____
 This Construction Authorization is subject to revocation if the site plan, plat, or the intended use changes. The Construction Authorization shall not be transferred when there is a change in ownership of the site. This Construction Authorization is subject to compliance with the provisions of the Laws and Rules for Sewage Treatment and Disposal and to the conditions of this permit. SEE ATTACHED SITE SKETCH

Authorized State Agent: James E Markham Date: 5-20-16
 Construction Authorization Expiration Date: 5-20-21

HTE# 165-39597

Permit # 29059

Harnett County Department of Public Health Site Sketch

ISSUED TO: ELC Properties LLC PROPERTY LOCATOR: SR1841 Access Rd
SUBDIVISION _____ LOT # 4

Authorized State Agent: James E. Marban Date: 5-20-16

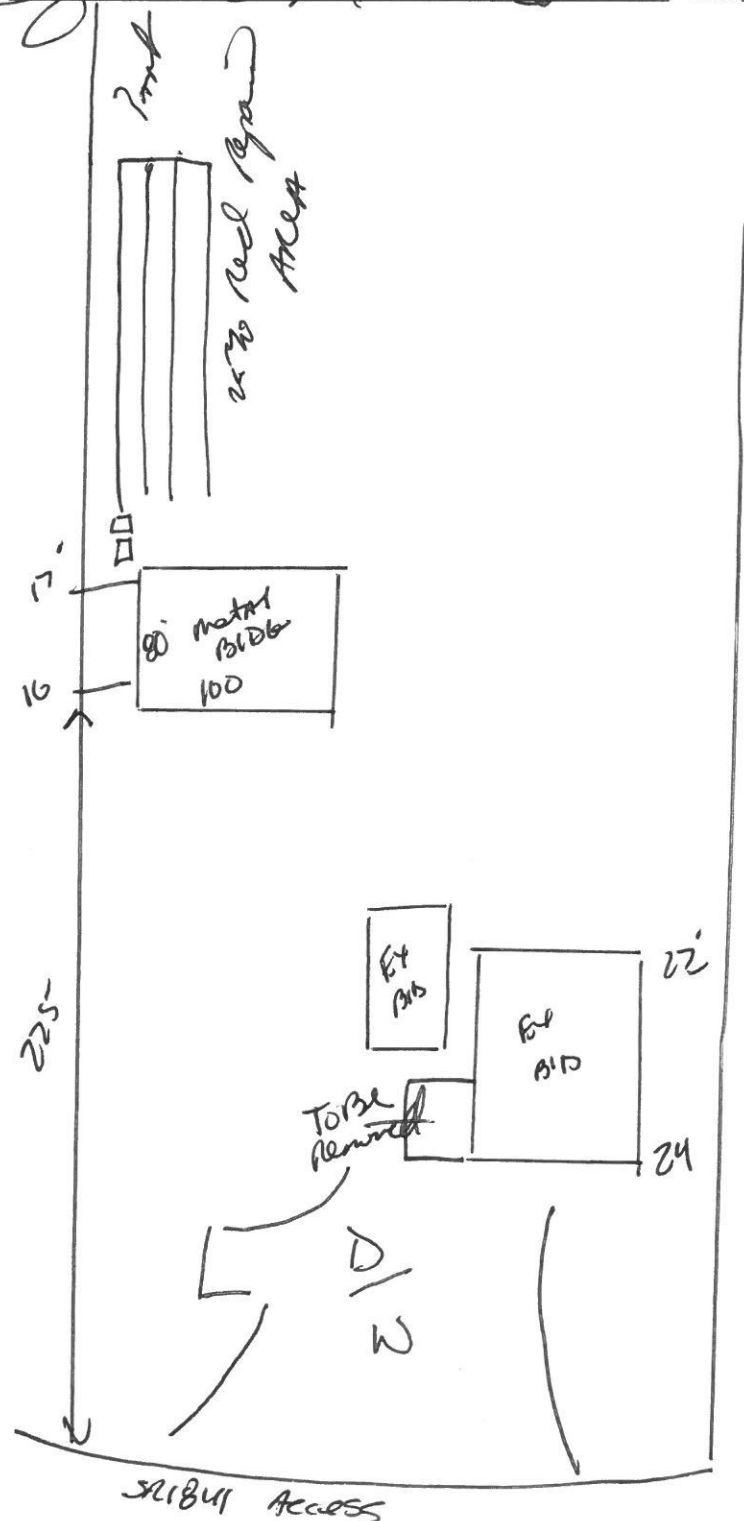

Contractor meet
ON SITE prior to
INSTALL.