

2-17-12

1250028377

# Harnett County Department of Public Health

## Well Construction Permit Application

*Need well permit ASAP*

If the information in the application for a Well Construction Permit is *falsified, changed, or the site is altered*, then the Well Construction Permit shall become invalid.

Owner: Kenneth King

### APPLICANT INFORMATION

Teddy & Bobbie Rodriguez (919) 499-8568 or 3515  
**Applicant/Owner** **Phone Number**  
912 Womack Road Broadway, NC 27505  
**Street Address, City, State, Zip Code**

The Applicant must submit a Site Plan. The Site Plan is a map/drawing of the property and must show:

1. existing and/or proposed property lines and easements with dimensions;
2. the location of the facility and appurtenance;
3. the location for the proposed well;
4. the location of existing or proposed sewer lines and/or sewage disposal systems within 100 feet of the proposed well;
5. the location of any existing wells within 100 feet of the property; surface water bodies;
6. above ground and/or underground storage tanks;
7. and any other known sources of contamination within 100 feet of the proposed well site.

The Applicant shall notify the Harnett County Health Director through or by way of the Harnett County Division of Environmental Health if any of the following occur prior to well construction:

1. there is a relocation of the proposed facility;
2. there is a change in the intended use of the facility;
3. there is a need for installing the waste water system in an area other than indicated on the well permit; or
4. there are landscape changed that affect site drainage.

**Contact information: Environmental Health Division - 910-893-7547**

### PROPERTY INFORMATION

#### Proposed use of well

Single-Family  Multifamily  Church  Restaurant  Business  Irrigation

Street Address 912 Womack Road Subdivision/Lot # \_\_\_\_\_  
Parcel # 13 0602 0131 PIN # 0612-18-2512.000

#### Directions to the Site

US 421 towards Sanford, take Right on Cool Springs Rd. (across from Munnors Post Office), Pass church on left - continue straight (do not turn right or follow to left of church), drive to end -> Turn Right at Womack Rd., Drive Approx. 5,000 ft. 912 on Right.

I have thoroughly read and completed this Application and certify that the information provided herein is true, complete and correct to the best of my knowledge and is give in good faith. Representatives of the Harnett County Health Department and state officials are granted right of entry to conduct necessary inspections to determine compliance with applicable rules.

I understand that I am solely responsible for the proper identification and labeling of all property lines, underground utility lines, and making the site accessible so that a well can be properly constructed according to the permit.

Bobbie Rodriguez 02-16-2012  
Property Owner's of \_\_\_\_\_ Date  
Owner's Legal Representative Signature Required

**HARNETT COUNTY, NORTH CAROLINA  
GIS/LAND RECORDS**

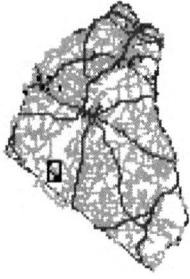

AddressPoints

Roads

MajorRoads

Rivers

parpin

County\_Boundary

CityLimits

Fort\_Bragg\_Camp\_McCa

Red: Band\_1

Green: Band\_2

Blue: Band\_3

Harnett.sid

Red: Band\_1

Green: Band\_2

Blue: Band\_3

Any use of this map shall be at the sole risk of the user of this map. Although, all effort has been taken to insure accuracy in the data presented, Harnett County makes no warranty, express or implied, as to the accuracy of this information. Harnett County, its officers, employees and agents shall hold harmless, Harnett County, its officers, employees and agents, from and against any claim, damage, loss, action, cause of action, or liability arising from the use of this GIS product.

Harnett County GIS  
305 W Cornelius Harnett Blvd, Suite 100  
Lillington NC 27546  
Phone: 910-893-7523 www.harnett.org



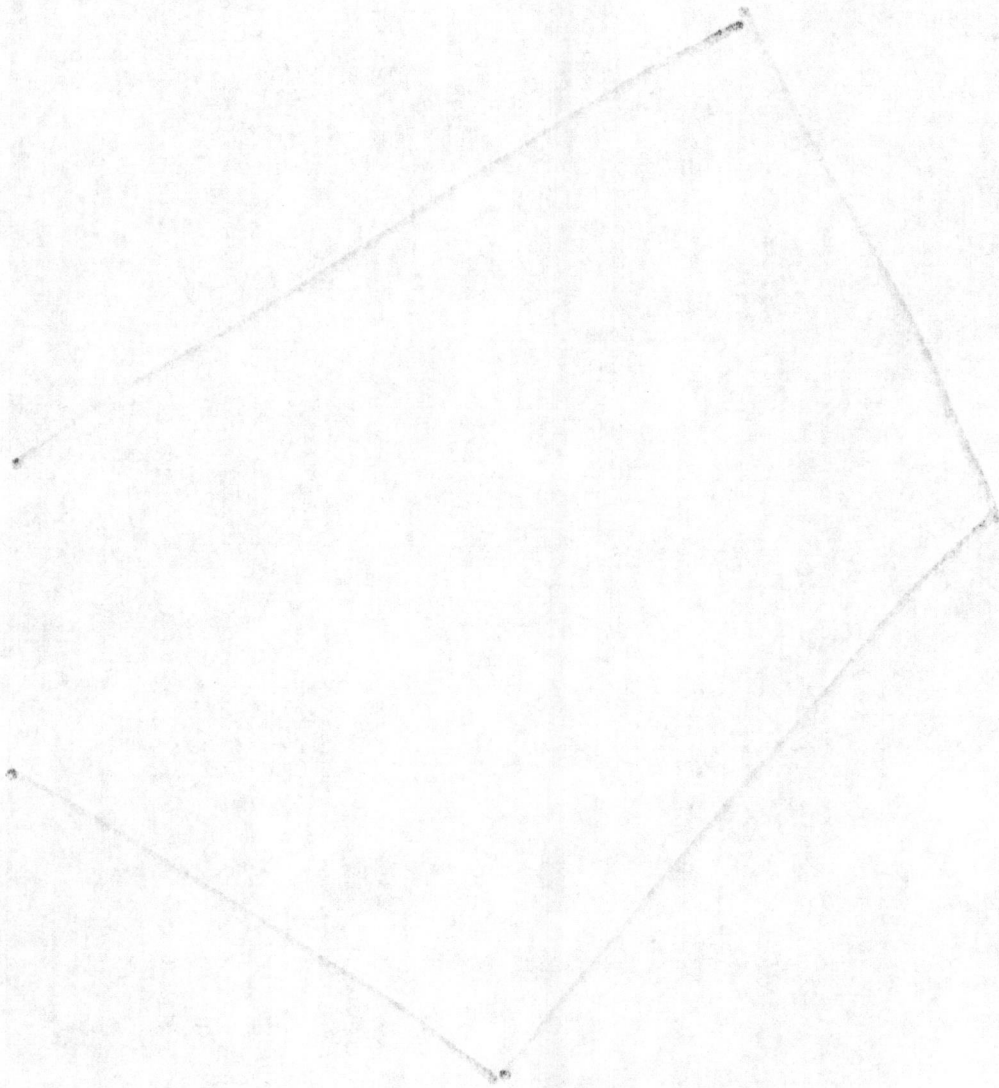

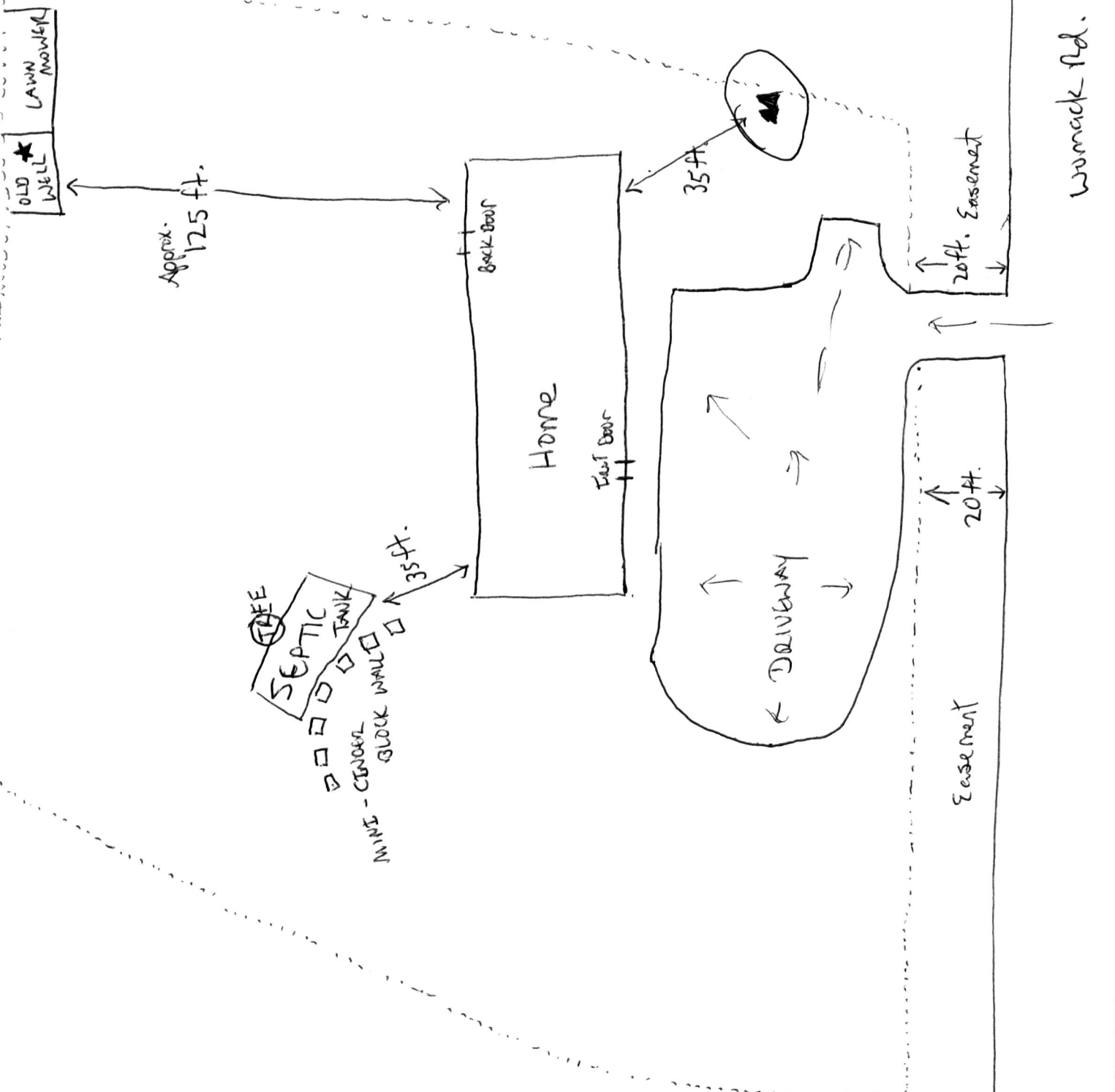

Neighbors property

Neighbors property

★ = OLD WELL  
 ▲ = possible New well location  
 IF old well used

Womack Rd.