

HTE# 07-5-19104R

Harnett County Department of Public Health

24149

Improvement Permit

A building permit cannot be issued with only an Improvement Permit

ISSUED TO: Brian Denny
PROPERTY LOCATION: 210 N
SUBDIVISION
LOT #
NEW [X] REPAIR [] EXPANSION []
Type of Structure: Existing House 50x60
Proposed Wastewater System Type: Accepted System
Projected Daily Flow: 480 GPD
Number of bedrooms: 4 Number of Occupants: 8 max
Basement [X] Yes [] No
Pump Required: [] Yes [] No [X] May be required based on final location and elevations of facilities
Type of Water Supply: [] Community [X] Public [] Well Distance from well _____ feet
Permit valid for: [X] Five years [] No expiration

Authorized State Agent: Susan McSwain, R.S. Date: 1/15/2008 SEE ATTACHED SITE SKETCH
The issuance of this permit by the Health Department in no way guarantees the issuance of other permits. The permit holder is responsible for checking with appropriate governing bodies in meeting their requirements. This site is subject to revocation if the site plan, plat, or the intended use changes. The Improvement Permit shall not be affected by a change in ownership of the site. This permit is subject to compliance with the provisions of the Laws and Rules for Sewage Treatment and Disposal and to conditions of this permit.

Construction Authorization

(Required for Building Permit)

The construction and installation requirements of Rules .1950, .1952, .1954, .1955, .1956, .1957, .1958, and .1959 are incorporated by references into this permit and shall be met. Systems shall be installed in accordance with the attached system layout.

ISSUED TO: Brian Denny
PROPERTY LOCATION: 210 N
SUBDIVISION
LOT #
Facility Type: Existing House [X] New [] Expansion [] Repair []
Basement? [X] Yes [] No Basement Fixtures? [] Yes [X] No
Type of Wastewater System** Accepted (Initial) Wastewater Flow: 480 GPD
(Pump to Accepted) (Repair)

Installation Requirements/Conditions

Septic Tank Size 1000 gallons Exact length of each trench 4 x 90 feet Trench Spacing: 9 Feet on Center
Pump Tank Size _____ gallons Trenches shall be installed on contour at a Soil Cover: 12-16 inches
Maximum Trench Depth of: 24-28 inches (Maximum soil cover shall not exceed 36" above the trench bottom)
in all directions)
Pump Requirements: _____ ft. TDH vs. _____ GPM _____ inches below pipe
Aggregate Depth: _____ inches above pipe

Conditions: Tank must be 15ft. from foundation & may need to be set shallow
Ditches to be NO DEEPER than 28 inches. Well to be filled in, H2O line to be run on other side of driveway

**If applicable: I understand the system type specified is different from the type specified on the application. I accept the specifications of this permit.

Owner/Legal Representative Signature: _____ Date: _____

This Construction Authorization is subject to revocation if the site plan, plat, or the intended use changes. The Construction Authorization shall not be transferred when there is a change in ownership of the site. This Construction Authorization is subject to compliance with the provisions of the Laws and Rules for Sewage Treatment and Disposal and to the conditions of this permit.

Authorized State Agent: Susan McSwain, R.S. Date: 1/15/2008 6/5/2008
Construction Authorization Expiration Date: 1/15/2013 6/15/2013 SEE ATTACHED SITE SKETCH

HTE# 07-5-19104 R

Permit # 24149

Harnett County Department of Public Health Site Sketch

ISSUED TO: Brian Denny PROPERTY LOCATOR: 210 N
SUBDIVISION _____ LOT # _____

Authorized State Agent: Bryan McSwain, R.S. Date: 1/15/2008 6/5/2008

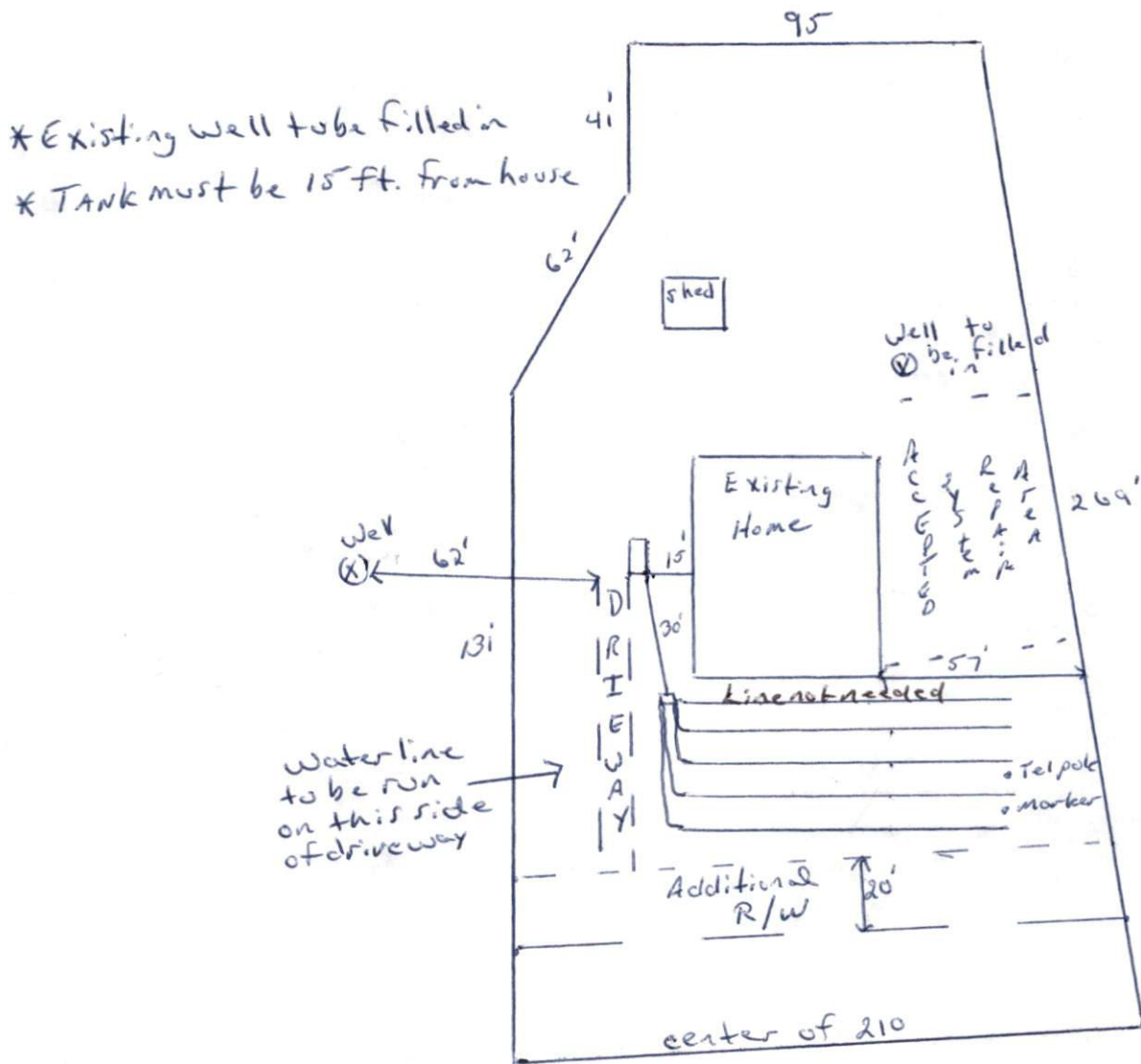

* Existing well tube filled in
* Tank must be 15 ft. from house

Waterline to be run on this side of driveway

Well to be filled in

Additional R/W 20'

center of 210