

Property ID:
 Lot #:
 File #:
 Code:

SOIL SITE EVALUATION for ON-SITE WASTEWATER SYSTEM

Owner:

Address:

Proposed Facility:

Location of Site:

Water Supply:

Evaluation Method:

Type of Wastewater:

SFP Model Design Flow (.1949): 240

- Public Individual Well
 Auger Boring Pit
 Sewage Industrial Process

07-5-

Applicant: 18419

Date Evaluated: 9-18-07
 9-20-07
 Property Size: 9-24-07

- Property Recorded:
- Spring Other
 Cut
 Mixed

Profile #	1940 Landscape Position Slope%	Horizon Depth (IN)	SOIL MORPHOLOGY 1941		OTHER PROFILE FACTORS				1942 Soil Wetness Color	1943 Soil Depth (in)	1944 Soil Saprot Class	1945 Soil Profile Class
			1941 Structure Texture	1941 Consistency Mineralogy	1946 Soil Depth (in)	1947 Soil Saprot Class	1948 Soil Profile Class					
1	L 4%	0-24	SL	FR GRN S.P.								
		24-44	SCL	FR 1/2 S.P.	40"							
2	L 4%	0-18	SL	FR GRN S.P.								
		18-42	SC - clay	FR 1/2 S.P.	38" 7.5% clay							

3
3

Description	Initial System	Repair System
available Space (.1945)	✓	✓
ystem Type(s)	15%	25%

Other Factors (.1946): _____
 Site Classification (.1948): *PS*
 Evaluated By: *[Signature]*

COMMENTS: _____

LANDSCAPE POSITIONS	GROUP	TEXTURES	.1955 LTAR	CONSISTENCE MOIST	WET
R-RIDGE	I	S-SAND	1.2 - 0.8	VFR-VERY FRIABLE	NS-NON-STICKY
S-SHOULDER SLOPE		LS-LOAMY SAND			
L-LINEAR SLOPE	II	SL-SANDY LOAM	0.8 - 0.6	FI-FIRM	S-STICKY
FS-FOOT SLOPE		L-LOAM			
N-NOSE SLOPE	III	SI-SILT-	0.6 - 0.3	VFI-VERY FIRM	VS-VERY STICKY
H-HEAD SLOPE		SIL-SILT LOAM			
CC-CONCLAVE SLOPE		CL-CLAY LOAM			
CV-CONVEX SLOPE		SCL-SANDY CLAY LOAM			
T-TERRACE		SICL-SILTY CLAY LOAM			
FP-FLOOD PLAN	IV	SIC-SILTY CLAY	0.4 - 0.1	EFI-EXTREMELY FIRM	NP-NON-PLASTIC
		C-CLAY			
		SC-SANDY CLAY			

STRUCTURE
 SG-SINGLE GRAIN
 M-MASSIVE
 CR-CRUMB
 GR-GRANULAR
 SBK-SUBANGULAR BLOCKY
 ABK-ANGULAR BLOCKY
 PL-PLATY
 PR-PRISMATIC

MINERALOGY
 SLIGHTLY EXPANSIVE
 EXPANSIVE

Show profile locations and other site features (dimensions, reference or benchmark, and North).

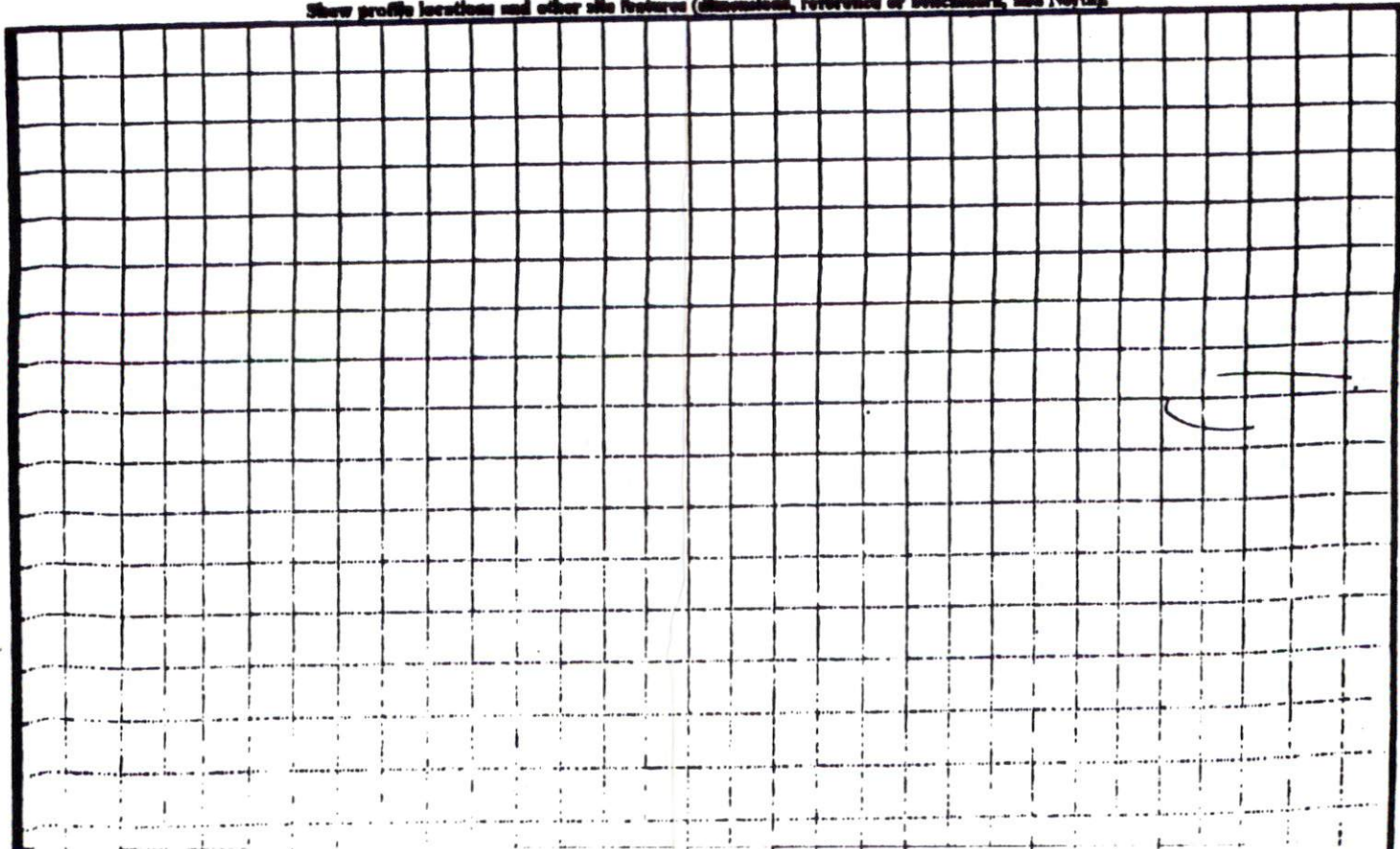

division of
ity that has

uch
gulated
nd.

or parcels of land
ange an existing street,
g or other structure,
is, or

ory, such
rt-ordered
ubdivision.

is such
the best of
ed in (A)

0 L - 2556

N 04°40'44" E
600.74'

S 83°22'10" E
879.06'

S 09°25'19" W
20.02'

N 83°22'10" W
236.77'

182.96'

Jesse T. & Kathryn Stewart
P.I.M. 1527-53-1183.000
MAP#2005-105

S 09°28'22" W

S 83°04'41" E
236.77'

Area
487,210 sq. ft.
11.18 acres

S 09°25'19" W
380.13'

N.C.S.R. 1802 (Lane Road) - 60' R/W

N 04°35'00" E
36.38'

N 03°29'32" W
23.10'

N 88°36'40" W
828.26'

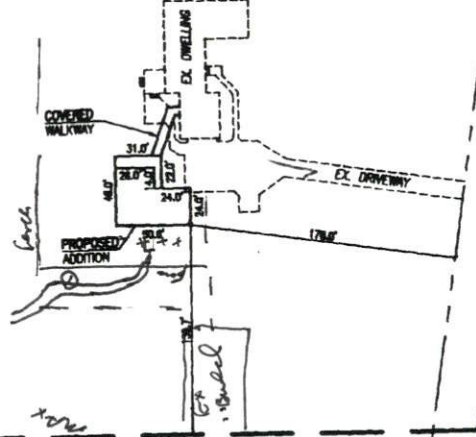

Proposed
2576
Garage

2x120
2576
24' max