

HTE# 05-50013319

# IMPROVEMENT PERMIT 22337

Be it ordained by the Harnett County Board of Health as follows: Section III, Item B. "No person shall begin construction of any building at which a septic tank system is to be used for disposal of sewage without first obtaining a written permit from the Harnett County Health Department."

Name: (owner) Joseph Boone New Installation  Septic Tank  Repair

Property Location: SR# old 421 Nitrification Line  Expansion

Subdivision \_\_\_\_\_ Lot # \_\_\_\_\_

Tax ID# \_\_\_\_\_ Quadrant # \_\_\_\_\_

Number of Bedrooms Proposed: 3 (existing) Lot Size: 17.62 ac

Basement with Plumbing:  Garage:

Water Supply:  Well  Public  Community

Distance From Well: \_\_\_\_\_ ft.

*Meet on site*

**Following is the minimum specifications for sewage disposal system on above captioned property. Subject to final approval.**

Type of system:  Conventional  Other \_\_\_\_\_

Size of tank: Septic Tank: existing 1200 gal gallons Pump Tank: \_\_\_\_\_ gallons

Subsurface Drainage Field No. of ditches 1 ft. exact length of each ditch 200 ft. width of ditches 3 ft. depth of ditches 18.24 in.

French Drain Required: \_\_\_\_\_ Linear feet

Date: 11-7-05

**This permit is subject to revocation if site plans or intended use change.**

**PERMIT EXPIRES 5 YEARS FROM ABOVE DATE**

Signed: [Signature]  
Environmental Health Specialist

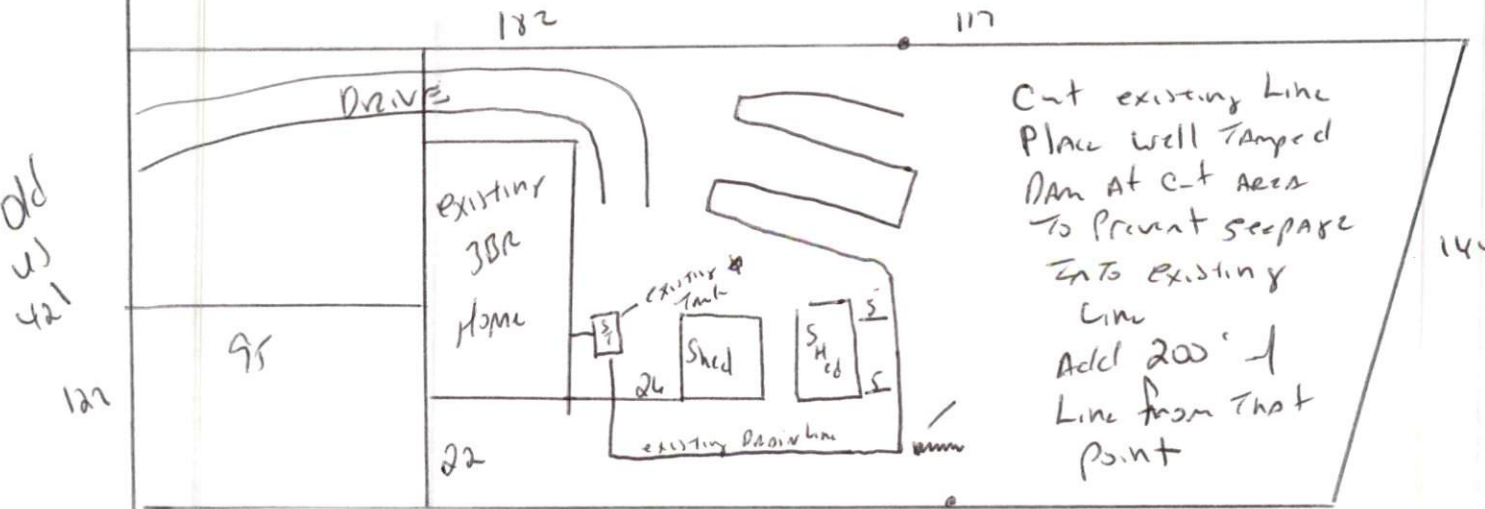

*Meet on site for layout maintain all set back*

HARNETT COUNTY DEPARTMENT OF PUBLIC HEALTH  
AUTHORIZATION TO CONSTRUCT

Authorization is hereby given to construct a wastewater system to the specifications described by Harnett County Department of Public Health, Improvement Permit # 22337. This authorization shall be valid for a period not to exceed five (5) years from the date of issuance. *This authorization will be invalid if ownership, site plans, or intended use change.*

Joseph Boone  
Name \_\_\_\_\_ Telephone # \_\_\_\_\_

Address \_\_\_\_\_

Old 421  
Property Location SR# \_\_\_\_\_ Road Name \_\_\_\_\_

Subdivision \_\_\_\_\_ Lot # \_\_\_\_\_ # Bedrooms Proposed 3 ex 8 Lot Size 1462 AC

**TYPE OF SYSTEM**

New Installation [ ] Repair  Septic Tank  Nitrification Lines

Conventional [ ] Other \_\_\_\_\_

[ ] Basement [ ] With Plumbing [ ] Without Plumbing

Water Supply: [ ] Well  Public Water Supply Minimum Well Setback: 50 Ft.

Septic Tank 1000 gal Pump Chamber \_\_\_\_\_ gal

**NITRIFICATION FIELD SPECIFICATIONS**

Number of fields 1 # of lines per field 1 Length of lines 200 Ft.

Width of ditches 3 ft. Depth of ditches 18.24 inches

French Drain: Linear feet required \_\_\_\_\_ Depth of gravel \_\_\_\_\_

No wastewater system shall be covered or placed into use by any person until an inspection by the Harnett County Health Department has determined that the system has been installed according to the conditions of the Improvement Permit and that a valid Operations Permit has been issued.

Jon West RS  
Signature of Authorized Agent for Harnett County

11-7-05  
Date