

IMPROVEMENT PERMIT

Attempt to Repair

Be it ordained by the Harnett County Board of Health as follows: Section III, Item B. "No Person shall begin construction of any building at which a septic tank system is to be used for disposal of sewage without first obtaining a written permit from the Harnett County Health Department."

Name: (owner) Ruby T. Munday
Property Location: SR# 1106
31 Paul Tysinger Lane Cameron NC 28326

- New Installation
Septic Tank
Repairs
Nitrification Line

Subdivision
Tax ID #
Quadrant #

Number of Bedrooms Proposed: 3 (existing) Lot Size: 2.00 Ac

Basement with Plumbing:
Garage:

Water Supply: Well Public Community

Distance From Well: 50 ft.

Following is the minimum specifications for sewage disposal system on above captioned property. Subject to final approval.

Type of system: Conventional Other

Size of tank: Septic Tank: 1000 gallons Pump Tank: gallons

Subsurface Drainage Field No. of ditches 1 exact length of each ditch 200 ft. width of ditches 3 ft. depth of ditches 18.24 in.

French Drain Required: Linear feet

Date: 02-27-03

This permit is subject to revocation if site plans or intended use change.

Signed: [Signature] Environmental Health Specialist

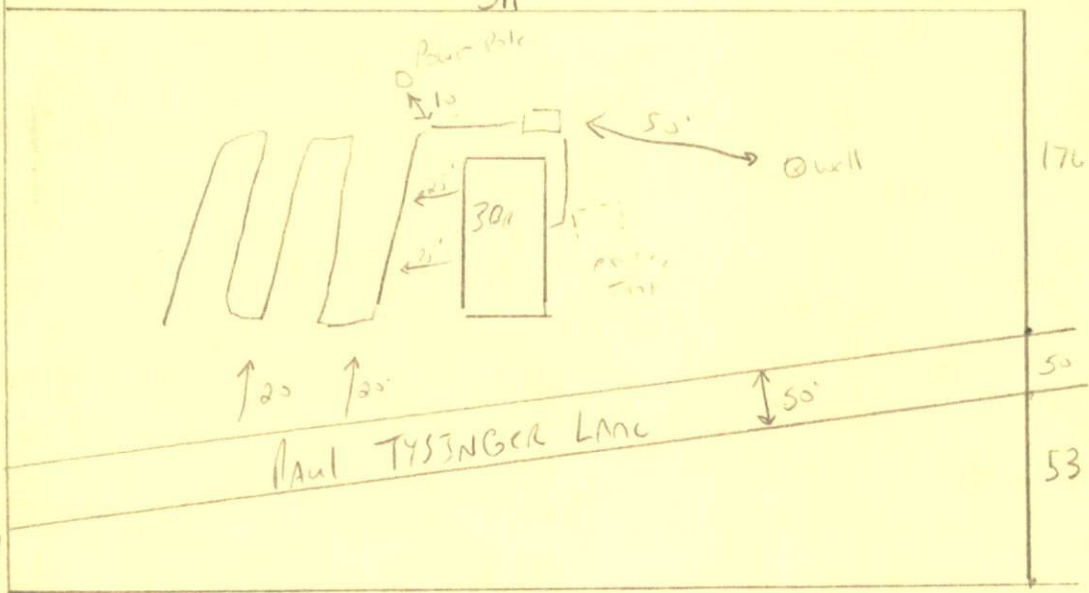

Meet on site

Place New Tank 50' from Old Well
Fill in existing Tank after Pumping it
Keep New Lines 25' from House, old lines are under house & end 25' from House

Avoid old Lines
Do not Drive on Tank on septic system
Meet onsite

HARNETT COUNTY HEALTH DEPARTMENT
AUTHORIZATION TO CONSTRUCT

Authorization is hereby given to construct a wastewater system to the specifications described by Harnett County Health Department, Improvement Permit # 19258. This authorization shall be valid for a period not to exceed five (5) years from the date of issuance. This authorization will be invalid if ownership, site plans, or intended use change.

Ruby T. Mundy
Name

697-9277
Telephone#

Address

1106

Property Location SR#

Road Name

Subdivision

Lot # 1

Bedrooms Proposed 3 ex 3

Lot Size 2.004

TYPE OF SYSTEM

New Installation Repair Septic Tank Nitrification Lines
 Conventional Other _____

Basement With Plumbing Without Plumbing

Water Supply: Well Public Water Supply Minimum Well Setback: 50 Ft.

Septic Tank 1000 gal Pump Chamber _____ gal

NITRIFICATION FIELD SPECIFICATIONS

Number of fields 1 # of lines per field _____ Length of lines 200 Ft.

Width of ditches 3 ft. Depth of ditches 18 2/4 inches

French Drain: Linear feet required _____ Depth of gravel _____

No wastewater system shall be covered or placed into use by any person until an inspection by the Harnett County Health Department has determined that the system has been installed according to the conditions of the Improvement Permit and that a valid Operations Permit has been issued.

[Signature]
Signature of Authorized Agent for Harnett County of Harnett

02-27-03

Date