

#02-5-4644

HARNETT COUNTY HEALTH DEPARTMENT

19188

IMPROVEMENT PERMIT

Be it ordained by the Harnett County Board of Health as follows: Section III, Item B. "No Person shall begin construction of any building at which a septic tank system is to be used for disposal of sewage without first obtaining a written permit from the Harnett County Health Department."

Name: (owner) Whitenton Builders Inc

New Installation  Septic Tank

Property Location: SR#  Hwy 210

Repairs  Nitrification Line

Subdivision \_\_\_\_\_ Lot # \_\_\_\_\_

Tax ID # \_\_\_\_\_ Quadrant # \_\_\_\_\_

Number of Bedrooms Proposed: \_\_\_\_\_ Lot Size: 2.356

Basement with Plumbing:  Garage:

Water Supply:  Well  Public  Community

Distance From Well: 50' ft.

Following is the minimum specifications for sewage disposal system on above captioned property. Subject to final approval.

Type of system:  Conventional  Other Pump to Conventional

Size of tank: Septic Tank: 1500 gallons Pump Tank: 1500 gallons

Subsurface Drainage Field No. of ditches 4 exact length of each ditch 110 ft. width of ditches 3 ft. depth of ditches 18-24 in.

French Drain Required: - Linear feet

Date: 5-20-07

**This permit is subject to revocation if site plans or intended use change.**

Signed: James C. Marshall  
Environmental Health Specialist

JR  
Matt Mell PD  
acc. Builder Rd

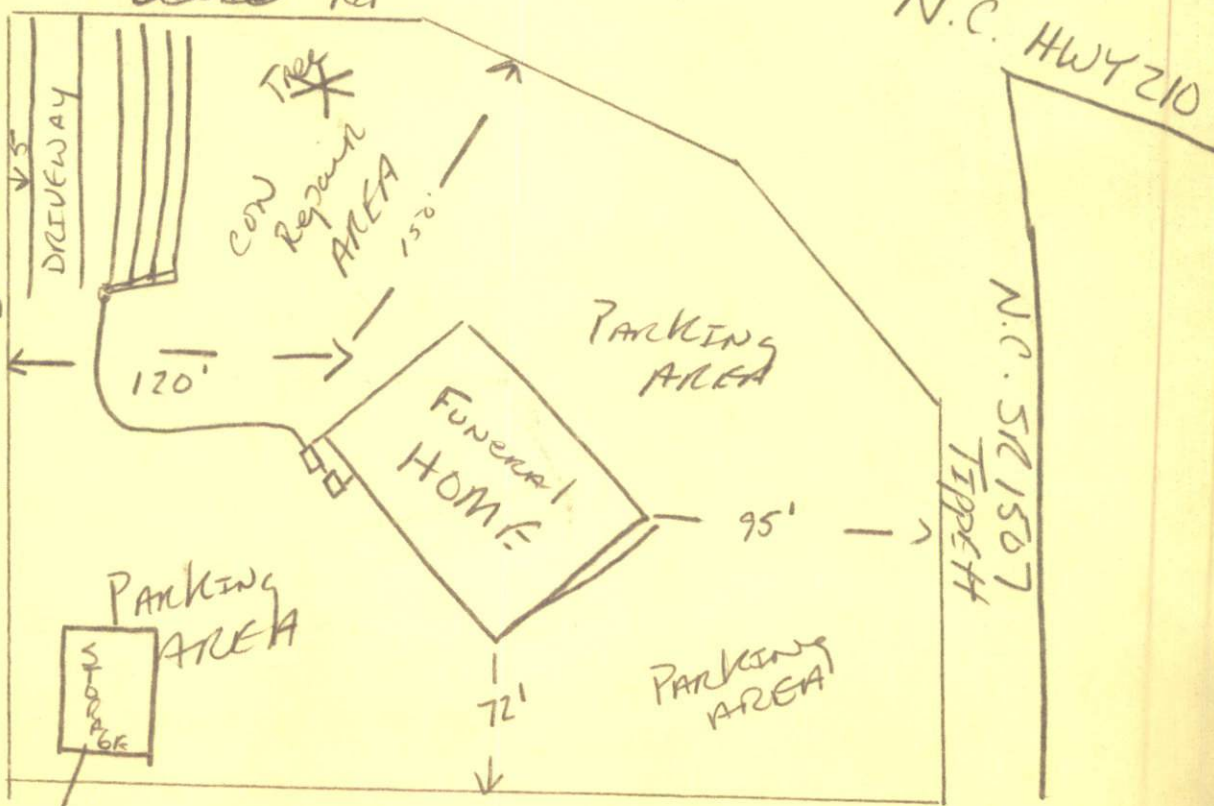

02-5-4644

HARNETT COUNTY HEALTH DEPARTMENT  
AUTORIZATION TO CONSTRUCT

Authorization is hereby given to construct a wastewater system to the specifications described by Harnett County Health Department, Improvement Permit # 19188. This authorization shall be valid for a period not to exceed five (5) years from the date of issuance. *This authorization will be invalid if ownership, site plans, or intended use change.*

Whitton Builders Inc 919-427-8465  
Name Telephone #

1055 Telshman Rd DUNN N.C. 28334  
Address

1507 + Hwy 210 Tappett + 210  
Property Location SR# Road Name

Subdivision \_\_\_\_\_ Lot # \_\_\_\_\_ # Bedrooms Proposed \_\_\_\_\_ Lot size 2.356

TYPE OF SYSTEM

New Installation [ ] Repair  Septic Tank  Nitrification Lines  
 Conventional Other Pump [ ] Basement [ ] With Plumbing [ ] Without Plumbing

Water Supply: [ ] Well  Public - Minimum Well Setback: 50' Ft.  
Septic Tank 1500 Pump Chamber 1500

NITRIFICATION FIELD SPECIFICATIONS

Number of fields 2 # of lines per field 4 Length of lines 110 Ft.

Width of ditches 3 ft. Depth of ditches 18-24 inches

French Drain: Linear feet required - Depth of gravel ✓

No wastewater system shall be covered or placed into use by any person until an inspection by the Harnett County Health Department has determined that the system has been installed according to the conditions of the Improvement Permit and that a valid Operations Permit has been issued.

James C. Merchant 5-20-02  
Signature of Authorized Agent for Harnett County Date