

-----

ADDRESS . : 220 JARCO DR SUBDIV:  
 CONTRACTOR : PHONE :  
 OWNER . . : JWR VENTURES LLC PHONE : (919) 552-7391  
 PARCEL . . : 08-0654- - -0004- -05-  
 APPL NUMBER: 08-50020121 CP NEW INDUSTRIAL  
 DIRECTIONS : FROM LILLINGTON TAKE 401 N HEADED TO  
 F-VAR APPROX 1 MILE BEFORE THE  
 HARNETT / WAKE COUNTY LINE JARCO DR  
 WILL BE ON RIGHT TURN RIGHT ONTO JARCO  
 OFF OF 401 AND GO 1/8 MILES SITE IS LOT  
 4 ON RIGHT JB

-----

STRUCTURE: 000 000 72000 SQ FT CONTR FOR CONTROL PROP  
 FLOOD ZONE . . . . : FLOOD ZONE X  
 PROPOSED USE . . . . . : INDUSTRY SEPTIC - EXISTING? . . . . : NEW

PERMIT: CBCO 00 CP BUILDING COMMERCIAL

TYP/SQ	REQUESTED COMPLETED	INSP RESULT	DESCRIPTION RESULTS/COMMENTS
C151 01	7/03/08 <u>7.3.08</u>	TI <u>APBS</u>	C*BLDG FOOTING VRU #: 001636108

----- COMMENTS AND NOTES -----

-----  
ADDRESS : 220 JARCO DR SUBDIV:  
CONTRACTOR : PHONE :  
OWNER : JWR VENTURES LLC PHONE : (919) 552-7391  
PARCEL : 08-0654- - -0004- -05-  
APPL NUMBER: 08-50020121 CP NEW INDUSTRIAL  
DIRECTIONS : FROM LILLINGTON TAKE 401 N HEADED TO  
F-VAR APPROX 1 MILE BEFORE THE  
HARNETT / WAKE COUNTY LINE JARCO DR  
WILL BE ON RIGHT TURN RIGHT ONTO JARCO  
OFF OF 401 AND GO 1/8 MILES SITE IS LOT  
4 ON RIGHT JB  
-----

STRUCTURE: 000 000 72000 SQ FT CONTR FOR CONTROL PROP  
FLOOD ZONE . . . . : FLOOD ZONE X  
PROPOSED USE . . . . : INDUSTRY SEPTIC - EXISTING? . . . . : NEW  
-----

PERMIT: CPPC 00 CP PLUMBING COMMERCIAL

TYP/SQ	REQUESTED	INSP	DESCRIPTION
	COMPLETED	RESULT	RESULTS/COMMENTS
P357 01	7/08/08 <u>7-8-08</u>	TI <u>APBS</u>	C*PLUMB UNDER SLAB VRU #: 001637919 VOICE MESSAGE LEFT

----- COMMENTS AND NOTES -----

# Cruse And Associates, P.A.

414 E. EDGERTON ST.  
DUNN, NC 28334  
PHONE NUMBER (910) 892-4429  
FAX NUMBER (910) 892-5162

## Fax Transmittal Form

To: Mr. Brad Sutton

From:

Company Name: Harnett Co. Insp.

Date Sent:

Phone:

Number of Pages:

Fax: 910-814-8277

RE: ECS bldg

Message 5

NOTE TO INSPECTIONS 7-8-08  
 WATER SUPPLY LINE IS ACCEPTABLE AT 1" INSTEAD OF ORIGINAL 1-1/4", AND PEX PIPING MAY BE USED WHERE ALLOWED BY NC PLUMBING CODE.

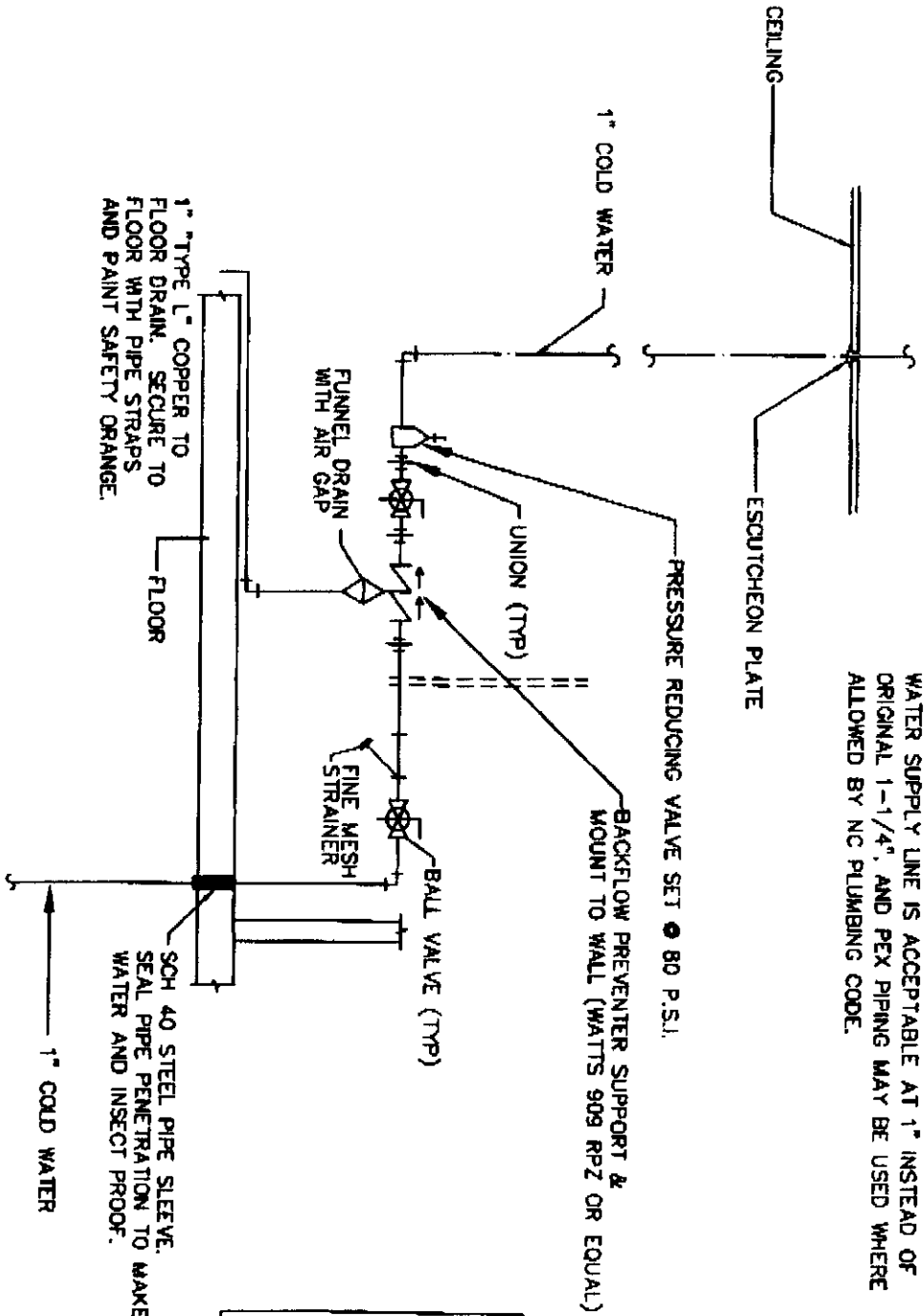

DETAIL - WATER SERVICE ENTRANCE  
 NOT TO SCALE

ENGINEERED CONTROL SOLUTIONS

220 JARCO DRIVE  
 FUQUAY-VARINA, NORTH CAROLINA

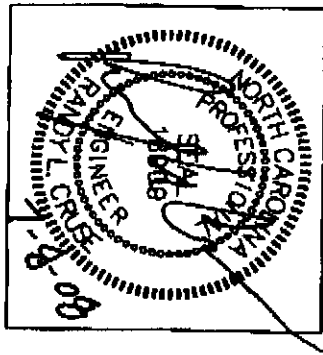

-----  
ADDRESS . . : 220 JARCO DR  
CONTRACTOR :  
OWNER . . . : JWR VENTURES LLC  
PARCEL . . . : 08-0654- - -0004- -05-  
APPL NUMBER: 08-50020121 CP NEW INDUSTRIAL  
DIRECTIONS : FROM LILLINGTON TAKE 401 N HEADED TO  
F-VAR APPROX 1 MILE BEFORE THE  
HARNETT / WAKE COUNTY LINE JARCO DR  
WILL BE ON RIGHT TURN RIGHT ONTO JARCO  
OFF OF 401 AND GO 1/8 MILES SITE IS LOT  
4 ON RIGHT JB  
-----

STRUCTURE: 000 000 72000 SQ FT CONTR FOR CONTROL PROP  
FLOOD ZONE . . . . : FLOOD ZONE X  
-----

PERMIT: CBCO 00 CP BUILDING COMMERCIAL

TYP/SQ	REQUESTED COMPLETED	INSP RESULT	DESCRIPTION RESULTS/COMMENTS
C151 01	7/03/08	BS	C*BLDG FOOTING VRU #: 001636108
	7/03/08	AP	
C159 01	7/09/08	TI	C*BLDG SLAB INSP VRU #: 001638847
	<u>7-9-8</u>	<u>APBS</u>	

----- COMMENTS AND NOTES -----

ADDRESS : 220 JARCO DR  
CONTRACTOR :  
OWNER : JWR VENTURES LLC  
PARCEL : 08-0654- - -0004- -05-  
APPL NUMBER: 08-50020121 CP NEW INDUSTRIAL

SUBDIV:  
PHONE :  
PHONE : (919) 552-7391

PERMIT: CBCO 00 CP BUILDING COMMERCIAL

TYP/SQ	REQUESTED COMPLETED	INSP RESULT	DESCRIPTION RESULTS/COMMENTS
C151 01	7/03/08	BS	C*BLDG FOOTING VRU #: 001636108
	7/03/08	AP	
C159 01	7/09/08	BS	C*BLDG SLAB INSP VRU #: 001638847
	7/09/08	AP	
C153 01	9/19/08 <u>9-19-08</u>	TI <u>DABS</u>	C*BLDG ROUGH IN TIME: 17:00 VRU #: 001680388

COMMENTS AND NOTES

-----

ADDRESS : 220 JARCO DR SUBDIV:  
 CONTRACTOR : PHONE :  
 OWNER : JWR VENTURES LLC PHONE : (919) 552-7391  
 PARCEL : 08-0654- - -0004- -05-  
 APPL NUMBER: 08-50020121 CP NEW INDUSTRIAL  
 DIRECTIONS : FROM LILLINGTON TAKE 401 N HEADED TO  
 F-VAR APPROX 1 MILE BEFORE THE  
 HARNETT / WAKE COUNTY LINE JARCO DR  
 WILL BE ON RIGHT TURN RIGHT ONTO JARCO  
 OFF OF 401 AND GO 1/8 MILES SITE IS LOT  
 4 ON RIGHT JB

-----

STRUCTURE: 000 000 72000 SQ FT CONTR FOR CONTROL PROP  
 FLOOD ZONE . . . . : FLOOD ZONE X  
 PROPOSED USE . . . . . : INDUSTRY SEPTIC - EXISTING? . . . . : NEW

-----

PERMIT: CPEC 00 CP ELECTRICAL COMMERCIAL

TYP/SQ	REQUESTED COMPLETED	INSP RESULT	DESCRIPTION RESULTS/COMMENTS	
E251 01	9/19/08 <i>9/19/08</i>	TI <i>APBS</i>	C*ELEC ROUGH IN	VRU #: 001679414

-----

PERMIT: CPMC 00 CP MECHANICAL COMMERCIAL

TYP/SQ	REQUESTED COMPLETED	INSP RESULT	DESCRIPTION RESULTS/COMMENTS	
M459 01	9/19/08	TI <i>APBS</i>	C*MECH ROUGH IN	VRU #: 001679422

-----

PERMIT: CPPC 00 CP PLUMBING COMMERCIAL

TYP/SQ	REQUESTED COMPLETED	INSP RESULT	DESCRIPTION RESULTS/COMMENTS	
P357 01	7/08/08	BS	C*PLUMB UNDER SLAB	VRU #: 001637919
	7/08/08	AP	VOICE MESSAGE LEFT	
P351 01	9/19/08	TI <i>DABJ</i>	C*PLUMB ROUGH IN	VRU #: 001679398

-----

----- COMMENTS AND NOTES -----

# Cruse And Associates, P.A.

414 E. EDGERTON ST.  
DUNN, NC 28334  
PHONE NUMBER (910) 892-4429  
FAX NUMBER (910) 892-5162

## Fax Transmittal Form

To: Mr. Brad Sutton

From:

Company Name: Harnett Co. Insp.

Date Sent:

Phone:

Number of Pages:

Fax: 910-814-8277

RE: ECS bldg

Message 5



NOTE TO INSPECTIONS 7-8-08  
 WATER SUPPLY LINE IS ACCEPTABLE AT 1" INSTEAD OF ORIGINAL 1-1/4". AND PEX PIPING MAY BE USED WHERE ALLOWED BY NC PLUMBING CODE.

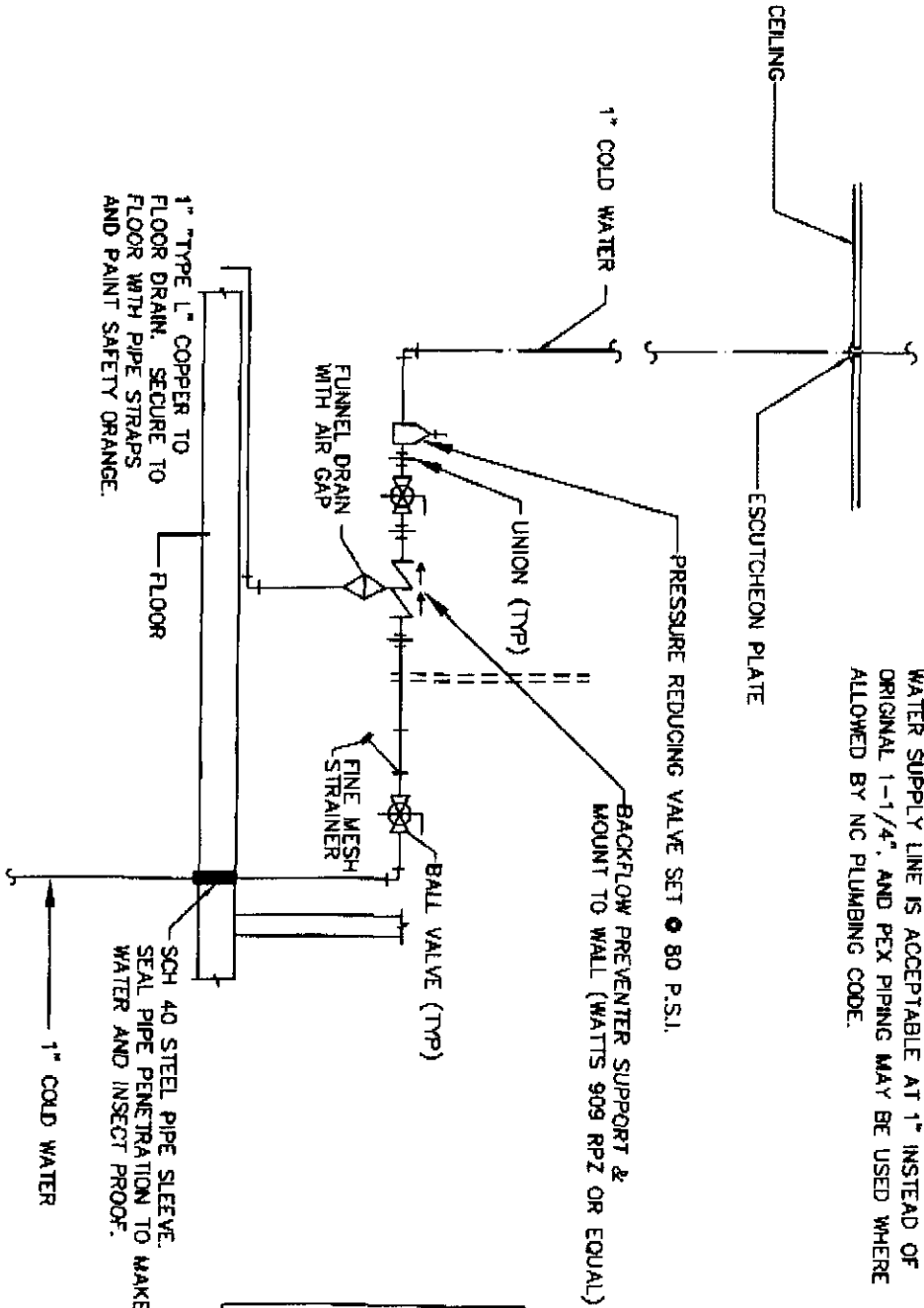

DETAIL - WATER SERVICE ENTRANCE  
 NOT TO SCALE

**ENGINEERED CONTROL SOLUTIONS**

**220 JARCO DRIVE  
 FUQUAY-VARINA, NORTH CAROLINA**

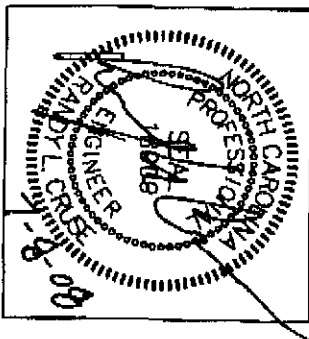

ADDRESS : 220 JARCO DR  
CONTRACTOR :  
OWNER : JWR VENTURES LLC  
PARCEL : 08-0654- - -0004- -05-  
APPL NUMBER: 08-50020121 CP NEW INDUSTRIAL

SUBDIV:  
PHONE :  
PHONE : (919) 552-7391

PERMIT: CBCO 00 CP BUILDING COMMERCIAL

TYP/SQ	REQUESTED COMPLETED	INSP RESULT	DESCRIPTION RESULTS/COMMENTS
C151 01	7/03/08 7/03/08	BS AP	C*BLDG FOOTING VRU #: 001636108
C159 01	7/09/08 7/09/08	BS AP	C*BLDG SLAB INSP VRU #: 001638847
C153 01	9/19/08 9/19/08	BS DA	C*BLDG ROUGH IN TIME: 17:00 VRU #: 001680388 need steel certification letter. 2. Fireblock wall between bathroom walls. 3. Need letter on 2-2x10 beam carrying floor load at 8 ft span. Check at insulation inspection
I185 01	9/23/08 9/22/08	TI CA	C*INSULATION INSPECTION VRU #: 001681105
C153 02	9/23/08 <u>9/23/08</u>	TI <u>APRS</u>	C*BLDG ROUGH IN TIME: 17:00 VRU #: 001681246

PERMIT: CPIC 00 CP INSULATION COMMERCIAL

TYP/SQ	REQUESTED COMPLETED	INSP RESULT	DESCRIPTION RESULTS/COMMENTS
I185 01	9/23/08	TI	C*INSULATION INSPECTION VRU #: 001681113

PERMIT: CPPG 00 CP PLUMBING COMMERCIAL

TYP/SQ	REQUESTED COMPLETED	INSP RESULT	DESCRIPTION RESULTS/COMMENTS
P357 01	7/08/08 7/08/08	BS AP	C*PLUMB UNDER SLAB VRU #: 001637919 VOICE MESSAGE LEFT
P351 01	9/19/08 9/19/08	BS DA	C*PLUMB ROUGH IN VRU #: 001679398 no plumbing tests on
P351 02	9/23/08	TI	C*PLUMB ROUGH IN TIME: 17:00 VRU #: 001681576

COMMENTS AND NOTES

# Cruse And Associates, P.A.

*Engineering Services*



414 E. Edgerton Street • Dunn, NC 28334 • Phone (910) 892-4429 • Fax (910) 892-5182

9-22-08

To: Lee Revis

From: Randy L. Cruse, PE

ECS Office Building

Our firm checked the bolted connections for tightness in this facility on 9-22-08. The connections in the steel building frame were checked at random locations for frame-to-frame connections and frame-to-column connections. All of the connections checked met the requirements specified on the drawings sealed by the building manufacturer's engineer.

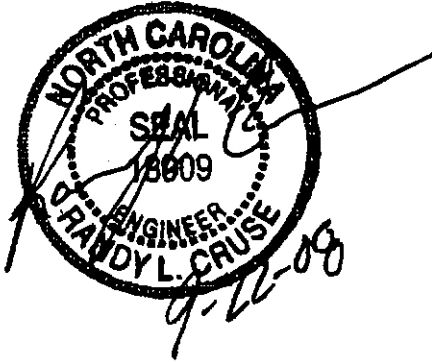

# Cruse And Associates, P.A.

414 E. EDGERTON ST.  
DUNN, NC 28334  
PHONE NUMBER (910) 892-4429  
FAX NUMBER (910) 892-5162

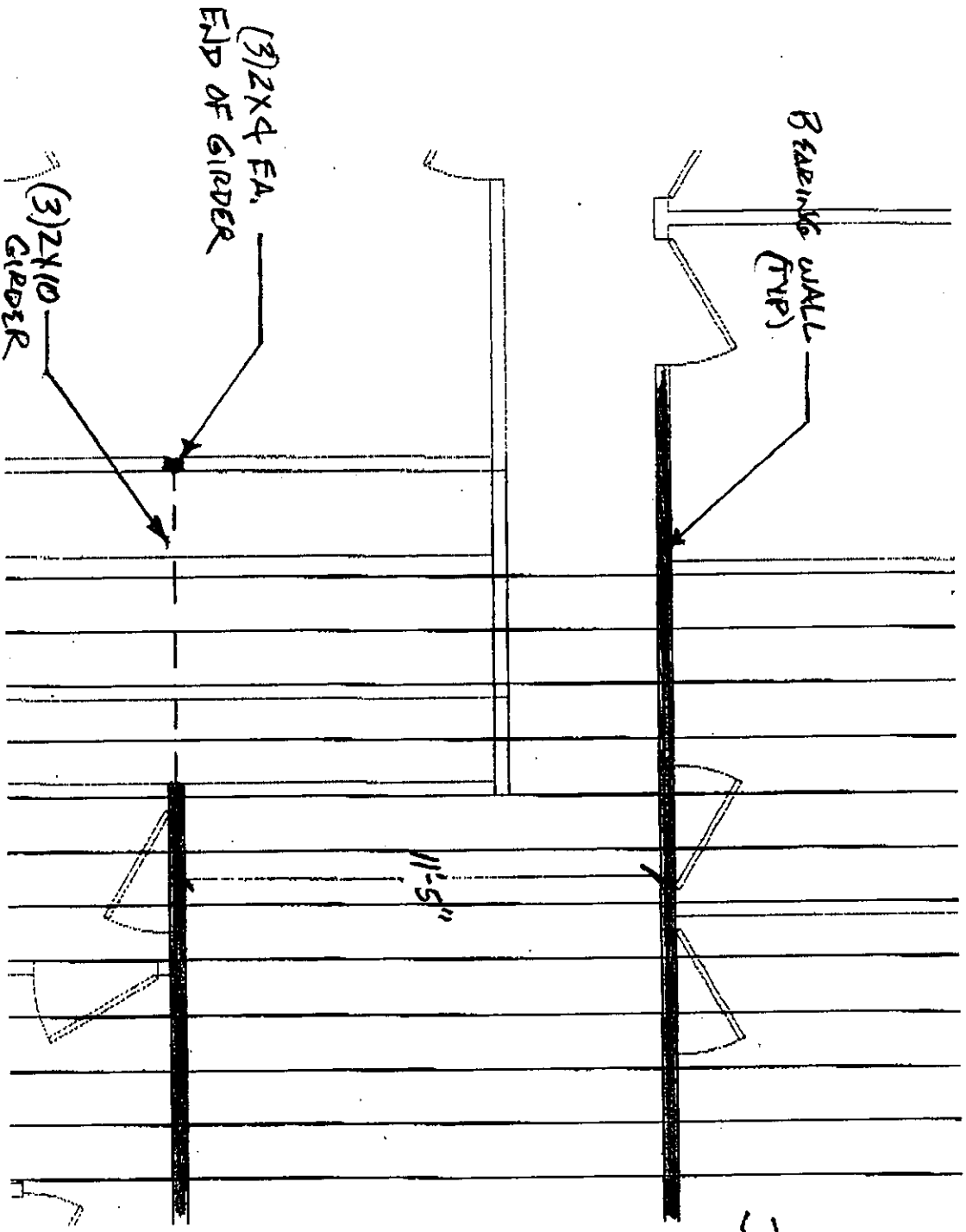

ECS BUILDING  
JOB # 07-109  
9-23-08



-----

ADDRESS . . : 220 JARCO DR SUBDIV:  
 CONTRACTOR : PHONE :  
 OWNER . . : JWR VENTURES LLC PHONE : (919) 552-7391  
 PARCEL . . : 08-0654- - -0004- -05-  
 APPL NUMBER: 08-50020121 CP NEW INDUSTRIAL  
 DIRECTIONS : FROM LILLINGTON TAKE 401 N HEADED TO  
 F-VAR APPROX 1 MILE BEFORE THE  
 HARNETT / WAKE COUNTY LINE JARCO DR  
 WILL BE ON RIGHT TURN RIGHT ONTO JARCO  
 OFF OF 401 AND GO 1/8 MILES SITE IS LOT  
 4 ON RIGHT JB

-----

STRUCTURE: 000 000 72000 SQ FT CONTR FOR CONTROL PROP  
 FLOOD ZONE . . . . : FLOOD ZONE X  
 PROPOSED USE . . . . . : INDUSTRY SEPTIC - EXISTING? . . . . : NEW

-----

PERMIT: CPPC 00 CP PLUMBING COMMERCIAL

TYP/SQ	REQUESTED COMPLETED	INSP RESULT	DESCRIPTION RESULTS/COMMENTS
P357 01	7/08/08	BS	C*PLUMB UNDER SLAB VRU #: 001637919
	7/08/08	AP	VOICE MESSAGE LEFT
P351 01	9/19/08	BS	C*PLUMB ROUGH IN VRU #: 001679398
	9/19/08	DA	no plumbing tests on
P351 02	9/23/08	BS	C*PLUMB ROUGH IN TIME: 17:00 VRU #: 001681576
	9/23/08	AP	
P355 01	10/15/08	TI	C*PLUMB SEWER CONNECTION VRU #: 001692350

*10-15-08* *APBS*

----- COMMENTS AND NOTES -----

Harnett County

INSPECTOR: IVR

DATE 11/26/08

ADDRESS : 220 JARCO DR

SUBDIV:

CONTRACTOR:

PHONE :

OWNER : JWR VENTURES LLC

PHONE : (919) 552-7391

PARCEL : 08-0654- - -0004- -05-

APPL NUMBER: 08-50020121 CP NEW INDUSTRIAL

DIRECTIONS : FROM LILLINGTON TAKE 401 N HEADED TO  
F-VAR APPROX 1 MILE BEFORE THE  
HARNETT / WAKE COUNTY LINE JARCO DR  
WILL BE ON RIGHT TURN RIGHT ONTO JARCO  
OFF OF 401 AND GO 1/8 MILES SITE IS LOT  
4 ON RIGHT JB

STRUCTURE: 000 000 72000 SQ FT CONTR FOR CONTROL PROP

FLOOD ZONE : FLOOD ZONE X

PROPOSED USE : INDUSTRY

SEPTIC - EXISTING? : NEW

PERMIT: CPCC 00 CP ELECTRICAL COMMERCIAL

TYP/SQ	REQUESTED COMPLETED	INSP RESULT	DESCRIPTION RESULTS/COMMENTS
E251 01	9/19/08	BS	C*ELEC ROUGH IN VRU #: 001679414
	9/19/08	AP	
E253 01	11/26/08 <i>11/26/08</i>	TI <i>APBS</i>	C*ELEC TEMP POWER CERT VRU #: 001710706

COMMENTS AND NOTES

EXPIRE DATE \_\_\_\_\_

T 5488

# TEMPORARY POWER CERTIFICATE

JOB NAME JWR Ventures

OWNER JWR Ventures ADDRESS 220 Jarco PHONE \_\_\_\_\_

LOCATION 220 Jarco Dr. FVNC

Progress Energy The power company shall not be required to terminate electric service supplied to the premises described above on or after the expiration date specified in this certificate, unless and until it is notified in writing by the Harnett County Electrical Inspector to do so.

I the undersigned understand that this certificate is for Temporary Power only and that a final inspection is required before permanent power will be approved. I shall also comply with any special requirement requested by the Harnett County Inspection Department.

Date 11.26.08

K B Jervis  
Owner or Authorized Signature

This certificate issued pursuant to the requirements of Section 105 of the North Carolina State Building Code certifying at the time of issuance this structure was in temporary compliance with the various ordinances of the County of Harnett regulating building construction or use.

Date 11.26.08

Brody  
Building Official

ADDRESS : 220 JARCO DR  
 CONTRACTOR :  
 OWNER : JWR VENTURES LLC  
 PARCEL : 08-0654- - -0004- -05-  
 APPL NUMBER: 08-50020121 CP NEW INDUSTRIAL  
 DIRECTIONS : FROM LILLINGTON TAKE 401 N HEADED TO  
 F-VAR APPROX 1 MILE BEFORE THE  
 HARNETT / WAKE COUNTY LINE JARCO DR  
 WILL BE ON RIGHT TURN RIGHT ONTO JARCO  
 OFF OF 401 AND GO 1/8 MILES SITE IS LOT  
 4 ON RIGHT JB

SUBDIV:  
 PHONE :  
 PHONE : (919) 552-7391

STRUCTURE: 000 000 72000 SQ FT CONTR FOR CONTROL PROP  
 FLOOD ZONE . . . . : FLOOD ZONE X  
 PROPOSED USE . . . . : INDUSTRY SEPTIC - EXISTING? . . . . : NEW

PERMIT: CPEC 00 CP ELECTRICAL COMMERCIAL

TYP/SQ	REQUESTED COMPLETED	INSP RESULT	DESCRIPTION RESULTS/COMMENTS
E251 01	9/19/08 9/19/08	BS AP	C*ELEC ROUGH IN VRU #: 001679414
E253 01	11/26/08 11/26/08	BS AP	C*ELEC TEMP POWER CERT VRU #: 001710706
E257 01	1/22/09	TI	C*ELEC OVERHEAD VRU #: 001727643

PERMIT: CPPC 00 CP PLUMBING COMMERCIAL

TYP/SQ	REQUESTED COMPLETED	INSP RESULT	DESCRIPTION RESULTS/COMMENTS
P357 01	7/08/08 7/08/08	BS AP	C*PLUMB UNDER SLAB VRU #: 001637919 VOICE MESSAGE LEFT
P351 01	9/19/08 9/19/08	BS DA	C*PLUMB ROUGH IN VRU #: 001679398 no plumbing tests on
P351 02	9/23/08 9/23/08	BS AP	C*PLUMB ROUGH IN TIME: 17:00 VRU #: 001681576
P355 01	10/15/08 10/15/08	BS AP	C*PLUMB SEWER CONNECTION VRU #: 001692350
P353 01	1/22/09 <i>1-22-09</i>	TI <i>APBS</i>	C*PLUMB WATER CONNECTION VRU #: 001727635
P359 01	1/22/09	TI	C*PLUMB OVERHEAD VRU #: 001727619
P361 01	1/22/09	TI	C*PLUMB FINAL VRU #: 001727627

COMMENTS AND NOTES



-----

ADDRESS . . : 220 JARCO DR  
 CONTRACTOR :  
 OWNER . . . : JWR VENTURES LLC  
 PARCEL . . . : 08-0654- - -0004- -05-  
 APPL NUMBER: 08-50020121 CP NEW INDUSTRIAL  
 DIRECTIONS : FROM LILLINGTON TAKE 401 N HEADED TO  
 F-VAR APPROX 1 MILE BEFORE THE  
 HARNETT / WAKE COUNTY LINE JARCO DR  
 WILL BE ON RIGHT TURN RIGHT ONTO JARCO  
 OFF OF 401 AND GO 1/8 MILES SITE IS LOT  
 4 ON RIGHT JB

-----

STRUCTURE: 000 000 72000 SQ FT CONTR FOR CONTROL PROP  
 FLOOD ZONE . . . . : FLOOD ZONE X  
 PROPOSED USE . . . . . : INDUSTRY SEPTIC - EXISTING? . . . . : NEW

-----

PERMIT: CPMC 00 CP MECHANICAL COMMERCIAL

TYP/SQ	REQUESTED COMPLETED	INSP RESULT	DESCRIPTION RESULTS/COMMENTS
M459 01	9/19/08	BS	C*MECH ROUGH IN VRU #: 001679422
	9/19/08	AP	
M463 01	1/23/09 <i>1-23-09</i>	TI <i>DABS</i>	C*MECH OVERHEAD VRU #: 001728005

----- COMMENTS AND NOTES -----

-----

ADDRESS . . : 220 JARCO DR  
 CONTRACTOR :  
 OWNER . . : JWR VENTURES LLC  
 PARCEL . . : 08-0654- - -0004- -05-  
 APPL NUMBER: 08-50020121 CP NEW INDUSTRIAL  
 DIRECTIONS : FROM LILLINGTON TAKE 401 N HEADED TO  
 F-VAR APPROX 1 MILE BEFORE THE  
 HARNETT / WAKE COUNTY LINE JARCO DR  
 WILL BE ON RIGHT TURN RIGHT ONTO JARCO  
 OFF OF 401 AND GO 1/8 MILES SITE IS LOT  
 4 ON RIGHT JB

-----

STRUCTURE: 000 000 72000 SQ FT CONTR FOR CONTROL PROP  
 FLOOD ZONE . . . . : FLOOD ZONE X  
 PROPOSED USE . . . . . : INDUSTRY SEPTIC - EXISTING? . . . . : NEW

-----

PERMIT: CPMC 00 CP MECHANICAL COMMERCIAL

TYP/SQ	REQUESTED COMPLETED	INSP RESULT	DESCRIPTION RESULTS/COMMENTS
M459 01	9/19/08 9/19/08	BS AP	C*MECH ROUGH IN VRU #: 001679422
M463 01	1/23/09 1/23/09	BS DA	C*MECH OVERHEAD VRU #: 001728005 Ok to cover all ceilings excepts mens and womens restrooms
M463 02	1/28/09 <u>1-28-09</u>	TI <u>APBS</u>	C*MECH OVERHEAD VRU #: 001729201

----- COMMENTS AND NOTES -----

-----

ADDRESS : 220 JARCO DR SUBDIV:  
 CONTRACTOR : PHONE :  
 OWNER : JWR VENTURES LLC PHONE : (919) 552-7391  
 PARCEL : 08-0654- - -0004- -05-  
 APPL NUMBER: 08-50020121 CP NEW INDUSTRIAL  
 DIRECTIONS : FROM LILLINGTON TAKE 401 N HEADED TO  
 F-VAR APPROX 1 MILE BEFORE THE  
 HARNETT / WAKE COUNTY LINE JARCO DR  
 WILL BE ON RIGHT TURN RIGHT ONTO JARCO  
 OFF OF 401 AND GO 1/8 MILES SITE IS LOT  
 4 ON RIGHT JB

-----

STRUCTURE: 000 000 72000 SQ FT CONTR FOR CONTROL PROP  
 FLOOD ZONE . . . . : FLOOD ZONE X  
 PROPOSED USE . . . . . : INDUSTRY SEPTIC - EXISTING? . . . . : NEW

-----

PERMIT: CPEC 00 CP ELECTRICAL COMMERCIAL

TYP/SQ	REQUESTED COMPLETED	INSP RESULT	DESCRIPTION RESULTS/COMMENTS
E251 01	9/19/08 9/19/08	BS AP	C*ELEC ROUGH IN VRU #: 001679414
E253 01	11/26/08 11/26/08	BS AP	C*ELEC TEMP POWER CERT VRU #: 001710706
E257 01	1/22/09 1/22/09	BS AP	C*ELEC OVERHEAD VRU #: 001727643
E265 01	3/13/09 <u>3-13-09</u>	TI <u>APBS</u>	C*ELEC FINAL VRU #: 001743574

-----

PERMIT: CPMC 00 CP MECHANICAL COMMERCIAL

TYP/SQ	REQUESTED COMPLETED	INSP RESULT	DESCRIPTION RESULTS/COMMENTS
M459 01	9/19/08 9/19/08	BS AP	C*MECH ROUGH IN VRU #: 001679422
M463 01	1/23/09 1/23/09	BS DA	C*MECH OVERHEAD VRU #: 001728005 Ok to cover all ceilings excepts mens and womens restrooms
M463 02	1/28/09 1/28/09	BS AP	C*MECH OVERHEAD VRU #: 001729201
M465 01	3/13/09 <u>3-13-09</u>	TI <u>APBS</u>	C*MECH FINAL VRU #: 001743566

-----

COMMENTS AND NOTES

ADDRESS : 220 JARCO DR  
CONTRACTOR :  
OWNER : JWR VENTURES LLC  
PARCEL : 08-0654- - -0004- -05-  
APPL NUMBER: 08-50020121 CP NEW INDUSTRIAL

SUBDIV:  
PHONE :  
PHONE : (919) 552-7391

DIRECTIONS : FROM LILLINGTON TAKE 401 N HEADED TO  
F-VAR APPROX 1 MILE BEFORE THE  
HARNETT / WAKE COUNTY LINE JARCO DR  
WILL BE ON RIGHT TURN RIGHT ONTO JARCO  
OFF OF 401 AND GO 1/8 MILES SITE IS LOT  
4 ON RIGHT JB

STRUCTURE: 000 000 72000 SQ FT CONTR FOR CONTROL PROP  
FLOOD ZONE . . . . : FLOOD ZONE X  
PROPOSED USE . . . . . : INDUSTRY SEPTIC - EXISTING? . . . . : NEW

PERMIT: CPLU 00 CP LAND USE PERMIT

TYP/SQ	REQUESTED COMPLETED	INSP RESULT	DESCRIPTION RESULTS/COMMENTS	TIME	VRU #
Z820 01	3/16/09	TI	PZ*ZONING/FINAL INSPECTION	17:00	001744218

*3/16/09 JS*

COMMENTS AND NOTES

*\*landscaping to be installed after  
Construction trailers are removed (~ 1 wk)*

ADDRESS : 220 JARCO DR  
CONTRACTOR :  
OWNER : JWR VENTURES LLC  
PARCEL : 08-0654- - -0004- -05-  
APPL NUMBER: 08-50020121 CP NEW INDUSTRIAL

SUBDIV:  
PHONE :  
PHONE : (919) 552-7391

DIRECTIONS : FROM LILLINGTON TAKE 401 N HEADED TO  
F-VAR APPROX 1 MILE BEFORE THE  
HARNETT / WAKE COUNTY LINE JARCO DR  
WILL BE ON RIGHT TURN RIGHT ONTO JARCO  
OFF OF 401 AND GO 1/8 MILES SITE IS LOT  
4 ON RIGHT JB

STRUCTURE: 000 000 72000 SQ FT CONTR FOR CONTROL PROP  
FLOOD ZONE : FLOOD ZONE X  
PROPOSED USE : INDUSTRY SEPTIC - EXISTING? : NEW

PERMIT: CBCO 00 CP BUILDING COMMERCIAL

TYP/SQ	REQUESTED COMPLETED	INSP RESULT	DESCRIPTION RESULTS/COMMENTS
C151 01	7/03/08	BS	C*BLDG FOOTING VRU #: 001636108
	7/03/08	AP	
C159 01	7/09/08	BS	C*BLDG SLAB INSP VRU #: 001638847
	7/09/08	AP	
C153 01	9/19/08	BS	C*BLDG ROUGH IN TIME: 17:00 VRU #: 001680388
	9/19/08	DA	need steel certification letter. 2. Fireblock wall between bathroom walls. 3. Need letter on 2-2x10 beam carrying floor load at 8 ft span. Check at insulation inspection
I185 01	9/23/08	TI	C*INSULATION INSPECTION VRU #: 001681105
	9/22/08	CA	
C153 02	9/23/08	BS	C*BLDG ROUGH IN TIME: 17:00 VRU #: 001681246
	9/23/08	AP	
H824 01	10/15/08	JM	ENVIR. OPERATIONS PERMIT TIME: 17:00 VRU #: 001694074
	10/15/08	AP	
F854 01	3/24/09	TM	FM*FINAL INSPECTION TIME: 17:00 VRU #: 001747138
	3/24/09	AP	
A814 01	3/25/09	TI	ADDRESS CONFIRMATION TIME: 17:00 VRU #: 001747120
	3/25/09	AP	220 JARCO DR LOT 4
C179 01	3/26/09	TI	C*BLDG FINAL TIME: 17:00 VRU #: 001748300

3-26-09 APBS

COMMENTS AND NOTES

**COUNTY OF HARNETT  
DEPARTMENT OF BUILDING INSPECTION  
AND PLANNING/DEVELOPMENT  
CERTIFICATE OF OCCUPANCY**

This certificate issued pursuant to the requirements of Section 105 of the North Carolina State Building Code and the Harnett County Zoning Ordinance certifies at the time of issuance this structure was in compliance with the various ordinances of the County of Harnett regulating development and building construction or use. For the following:

Use Classification: Business

Type of Construction: V

Owner of Building: JWR Ventures LLC

Building Address: 220 Jarco Drive

Zoning District: NA

Zoning Permit No.: NA

Date: 03/26/09

Brad Sutton

Building Official

Conditional Use Permit No.: NA

Building Permit No.: 08-50020121

Electrical Permit No.: 08-50020121

Insulation Permit No.: 08-50020121

Plumbing Permit No.: 08-50020121

Mech. Permit No.: 08-50020121

Envir. C.O. No.: 08-50020121

NA

Zoning Official