

1

Initial Application Date: 5-6-14

Application # 1450033589

CU# _____

COUNTY OF HARNETT RESIDENTIAL LAND USE APPLICATION
Central Permitting 108 E. Front Street, Lillington, NC 27546 Phone: (910) 893-7525 ext:2 Fax: (910) 893-2793 www.harnett.org/permits

A RECORDED SURVEY MAP, RECORDED DEED (OR OFFER TO PURCHASE) & SITE PLAN ARE REQUIRED WHEN SUBMITTING A LAND USE APPLICATION

LANDOWNER: Larry Cameron Mailing Address: 104 Hodges ave

City: Dunn State: NC Zip: 28324 Contact No: _____ Email: _____

APPLICANT: Larry Cameron Mailing Address: 104 Hodges ave

City: Dunn State: NC Zip: 28324 Contact No: _____ Email: _____

*Please fill out applicant information if different than landowner

CONTACT NAME APPLYING IN OFFICE: _____ Phone # _____

PROPERTY LOCATION: Subdivision: _____ Lot #: 8 Lot Size: _____

State Road # 2021 State Road Name: Titon Roberts Map Book & Page: PF, 4320

Parcel: 12 0586 0031 30 PIN: 0586-37-9304,000

Zoning: R120 Flood Zone: X Watershed: NA Deed Book & Page: 1114, 33 Power Company*: _____

*New structures with Progress Energy as service provider need to supply premise number _____ from Progress Energy.

PROPOSED USE:

SFD: (Size _____ x _____) # Bedrooms: _____ # Baths: _____ Basement(w/w bath): _____ Garage: _____ Deck: _____ Crawl Space: _____ Slab: _____ Slab: _____
(Is the bonus room finished? () yes () no w/ a closet? () yes () no (if yes add in with # bedrooms)

Mod: (Size _____ x _____) # Bedrooms _____ # Baths _____ Basement (w/w bath) _____ Garage: _____ Site Built Deck: _____ On Frame _____ Off Frame _____
(Is the second floor finished? () yes () no Any other site built additions? () yes () no

Manufactured Home: _____ SW _____ DW _____ TW (Size _____ x _____) # Bedrooms: _____ Garage: _____ (site built? _____) Deck: _____ (site built? _____)

Duplex: (Size _____ x _____) No. Buildings: _____ No. Bedrooms Per Unit: _____

Home Occupation: # Rooms: _____ Use: _____ Hours of Operation: _____ #Employees: _____

Addition/Accessory/Other: (Size 60x68) Use: Moved House 2 Blr Closets in addition? () yes () no

Water Supply: County _____ Existing Well _____ New Well (# of dwellings using well _____) *Must have operable water before final

Sewage Supply: New Septic Tank (Complete Checklist) _____ Existing Septic Tank (Complete Checklist) _____ County Sewer

Does owner of this tract of land, own land that contains a manufactured home within five hundred feet (500') of tract listed above? () yes () no

Does the property contain any easements whether underground or overhead () yes () no

Structures (existing or proposed): Single family dwellings: _____ Manufactured Homes: _____ Other (specify): _____

Required Residential Property Line Setbacks:

Front Minimum 35 Actual 180

Rear 25

Closest Side 10

Sidestreet/corner lot _____

Nearest Building on same lot _____

Comments: 2 plus acreage, only plan's to use front half + 30x14 Front Porch

30 X 14 Front Porch
Moved House

SITE PLAN APPROVAL
DISTRICT RA 20 USE 60 X 68
#BEDROOMS 2
5-6-14 V. CEL
Date Zoning Administrator

210

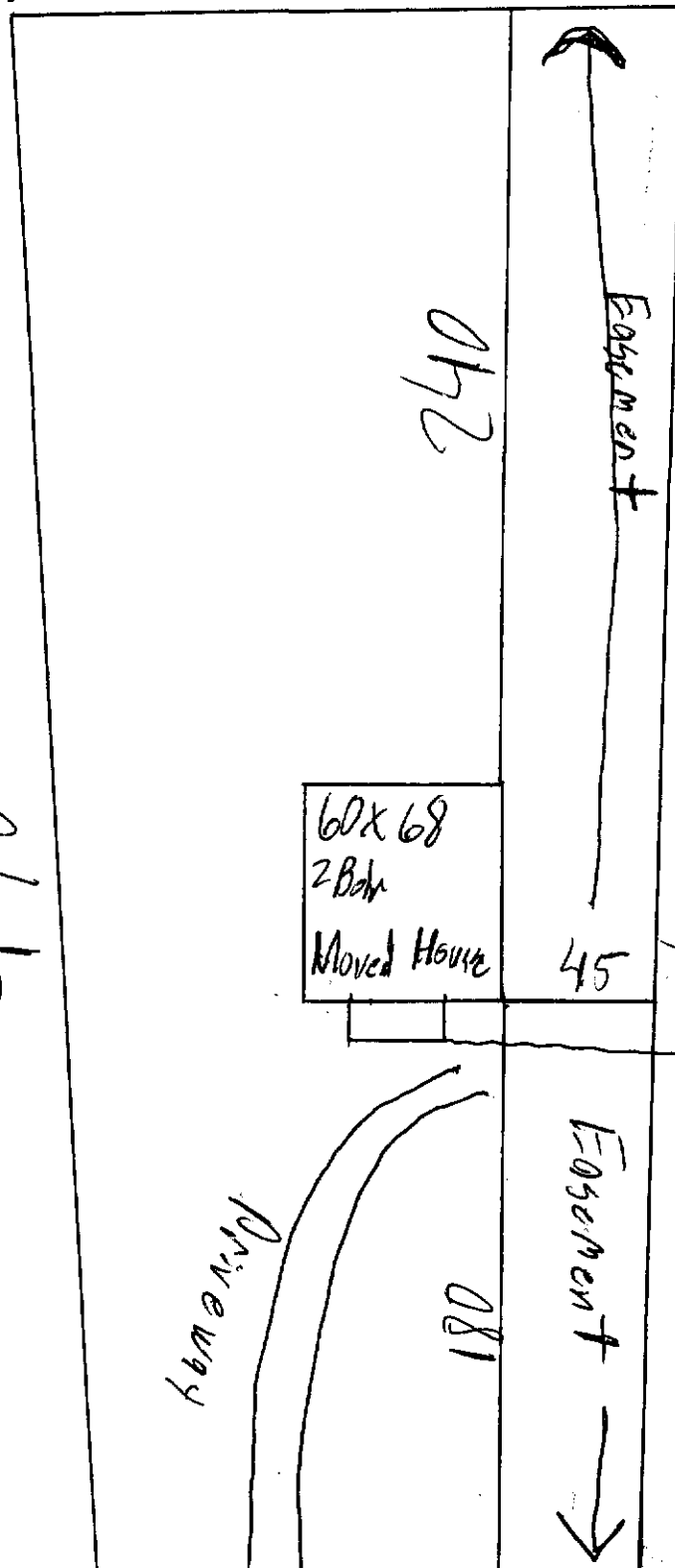

490

490

30 X 14 Front Porch

170

Titan Roberts Rd

SR #

~~Lyb. Co.~~

NAME: Larry Cameron

APPLICATION #: _____

This application to be filled out when applying for a septic system inspection.

County Health Department Application for Improvement Permit and/or Authorization to Construct

IF THE INFORMATION IN THIS APPLICATION IS FALSIFIED, CHANGED, OR THE SITE IS ALTERED, THEN THE IMPROVEMENT PERMIT OR AUTHORIZATION TO CONSTRUCT SHALL BECOME INVALID. The permit is valid for either 60 months or without expiration depending upon documentation submitted. (Complete site plan = 60 months; Complete plat = without expiration)

910-893-7525 option 1

CONFIRMATION # _____

Environmental Health New Septic System Code 800

- **All property irons must be made visible.** Place "pink property flags" on each corner iron of lot. All property lines must be clearly flagged approximately every 50 feet between corners.
- Place "orange house corner flags" at each corner of the proposed structure. Also flag driveways, garages, decks, out buildings, swimming pools, etc. Place flags per site plan developed at/for Central Permitting.
- Place orange Environmental Health card in location that is easily viewed from road to assist in locating property.
- If property is thickly wooded, Environmental Health requires that you clean out the undergrowth to allow the soil evaluation to be performed. Inspectors should be able to walk freely around site. **Do not grade property.**
- **All lots to be addressed within 10 business days after confirmation. \$25.00 return trip fee may be incurred for failure to uncover outlet lid, mark house corners and property lines, etc, once lot confirmed ready.**
- After preparing proposed site call the voice permitting system at 910-893-7525 option 1 to schedule and use code 800 (after selecting notification permit if multiple permits exist) for Environmental Health inspection. **Please note confirmation number given at end of recording for proof of request.**
- Use Click2Gov or IVR to verify results. Once approved, proceed to Central Permitting for permits.

Environmental Health Existing Tank Inspections Code 800

- Follow above instructions for placing flags and card on property.
- Prepare for inspection by removing soil over outlet end of tank as diagram indicates, and lift lid straight up (if possible) and then **put lid back in place.** (Unless inspection is for a septic tank in a mobile home park)
- **DO NOT LEAVE LIDS OFF OF SEPTIC TANK**
- After uncovering outlet end call the voice permitting system, at 910-893-7525 option 1 & select notification permit if multiple permits, then use code 800 for Environmental Health inspection. **Please note confirmation number given at end of recording for proof of request.**
- Use Click2Gov or IVR to hear results. Once approved, proceed to Central Permitting for remaining permits.

SEPTIC

If applying for authorization to construct please indicate desired system type(s): can be ranked in order of preference, must choose one.

- Accepted Innovative Conventional Any
- Alternative Other _____

The applicant shall notify the local health department upon submittal of this application if any of the following apply to the property in question. If the answer is "yes", applicant **MUST ATTACH SUPPORTING DOCUMENTATION**:

- YES NO Does the site contain any Jurisdictional Wetlands?
- YES NO Do you plan to have an irrigation system now or in the future?
- YES NO Does or will the building contain any drains? Please explain. drains off house roof
- YES NO Are there any existing wells, springs, waterlines or Wastewater Systems on this property?
- YES NO Is any wastewater going to be generated on the site other than domestic sewage?
- YES NO Is the site subject to approval by any other Public Agency?
- YES NO Are there any Easements or Right of Ways on this property?
- YES NO Does the site contain any existing water, cable, phone or underground electric lines?

If yes please call No Cuts at 800-632-4949 to locate the lines. This is a free service.

I Have Read This Application And Certify That The Information Provided Herein Is True, Complete And Correct. Authorized County And State Officials Are Granted Right Of Entry To Conduct Necessary Inspections To Determine Compliance With Applicable Laws And Rules. Understand That I Am Solely Responsible For The Proper Identification And Labeling Of All Property Lines And Corners And Making The Site Accessible So That A Complete Site Evaluation Can Be Performed.

Larry Cameron
PROPERTY OWNERS OR OWNERS LEGAL REPRESENTATIVE SIGNATURE (REQUIRED) DATE 14

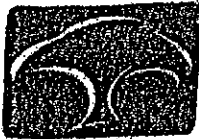

HARNETT COUNTY ENVIROMENTAL HEALTH SITE PREPARATION

Harnett
COUNTY
NORTH CAROLINA
strong roots - new growth

HOW TO PROPERLY MARK PROPERTY FOR SOIL EVALUATION

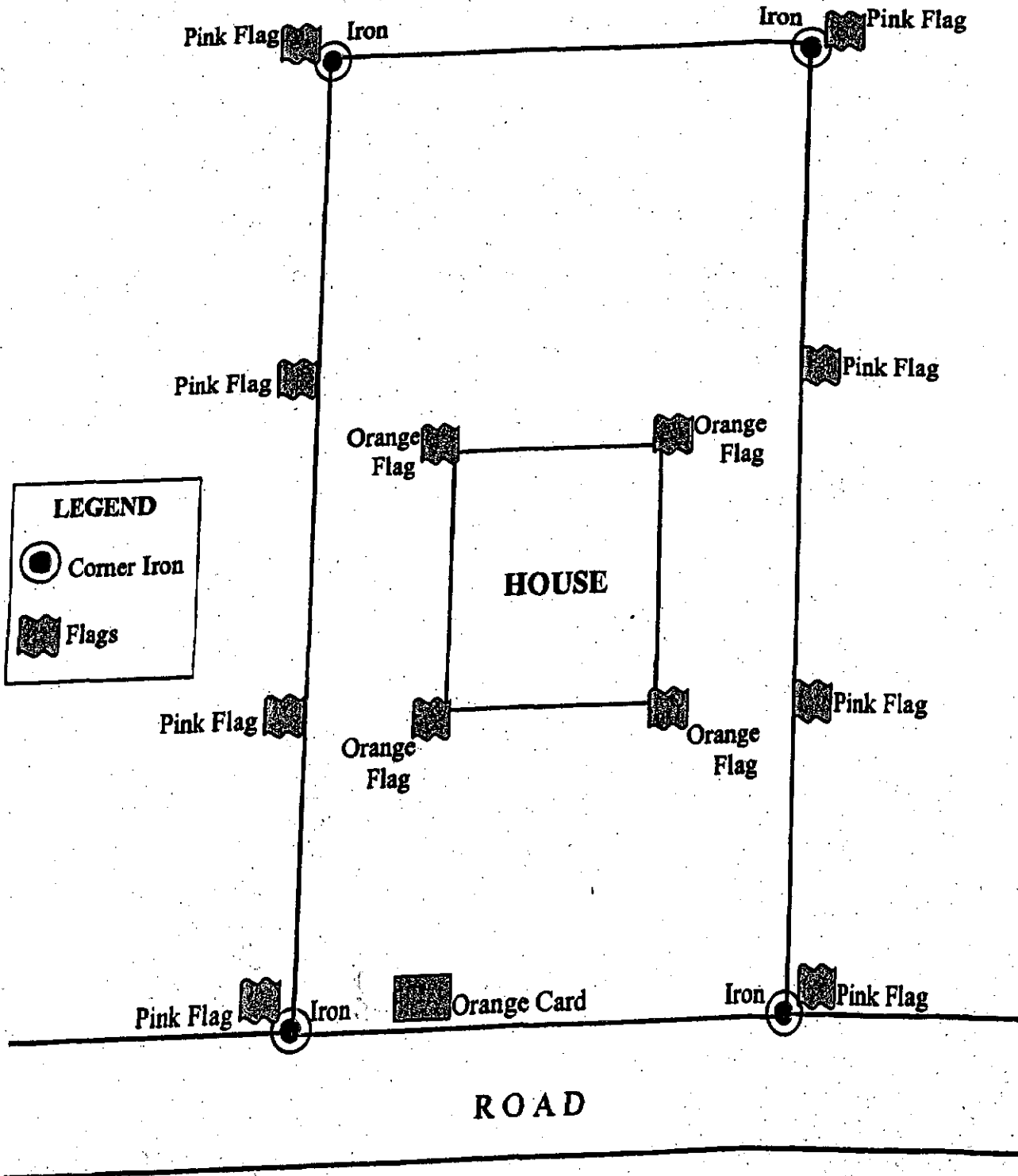

*Each section below must be filled out by whoever is performing the work. Must be owner or licensed contractor. Address, company name & phone must match information on state license.

Application # 33589
Harnett County Central Permitting
PO Box 65 Lillington, NC 27546
910-893-7525 Fax 910-893-2793 www.harnett.org/permits

COMMERCIAL Res.

Application for Building and Trades Permit

Owner's Name: Larry Cameron Date: 6-15-15

Site Address: Tition Roberts Rd. Phone: 910-890-6511

Directions to job site from Lillington: Take prison Camp Rd. East. to tition Roberts Rd. Left
Cross over Burnlevel / Erwin Rd., the lot is on the right
approx. 2.5 miles, yellow caution tape in Drive way

Subdivision: _____ Lot: _____

Description of Proposed Work: _____

Heated SF _____ Unheated SF _____

General Contractor Information: Building Cost \$ _____

Building Contractor's Company Name _____

Larry Cameron (owner)
Address _____

910-897-3467
Telephone _____

910-890-6511
Email Address Cameron60@yahoo.com

Signature of Owner/Contractor/Officer(s) of Corporation _____

License # _____

Electrical Contractor Information: Electrical Cost \$ _____
Description of Work new service? Service Size: _____ Amps #T-Poles _____
Old service

Electrical Contractor's Company Name _____

Larry Cameron
Address _____

Telephone _____

Email Address _____

Signature of Owner/Contractor/Officer(s) of Corporation _____

License # _____

Mechanical Contractor Information: Mechanical Cost \$ _____

Description of Work Heat / air Cond # Units _____

Larry Cameron (ARS)
Mechanical Contractor's Company Name _____

919-865-7777
Telephone _____

Address _____

Email Address _____

Signature of Owner/Contractor/Officer(s) of Corporation _____

License # _____

Plumbing Contractor Information: Plumbing Cost \$ _____

Description of Work _____ # Baths _____

Larry Cameron
Plumbing Contractor's Company Name _____

Telephone _____

Address _____

Email Address _____

Signature of Owner/Contractor/Officer(s) of Corporation _____

License # _____

Insulation Contractor Information

Larry Cameron
Insulation Contractor's Company Name & Address _____

Telephone _____

*NOTE: General Contractor must fill out and sign the second page of this application

basic
bdg.
permit
for
porch.
roof
already
shill

Sprinkler Contractor Information

Sprinkler Contractor's Company Name _____

Telephone _____

Address _____

Email Address _____

Signature of Officer(s) of Corporation _____

License # _____

Fire Alarm Contractor Information

Fire Alarm Contractor's Company Name _____

Telephone _____

Address _____

Email Address _____

Signature of Officer(s) of Corporation _____

License # _____

Driveway Access - NC Department of Transportation Driveway Access/Permit? Yes No

I hereby certify that I have the authority to make necessary application, that the application is correct and that the construction will conform to the regulations in the Building, Electrical, Plumbing and Mechanical codes, and the Harnett County Zoning Ordinance. I state the information on the above contractors is correct as known to me and if **any** changes occur including listed contractors, site plan, number of bedrooms, building and trade plans, Environmental Health permit changes or proposed use changes, I certify it is my responsibility to notify the Harnett County Central Permitting Department of any and all changes.

Expired Permit Fees - 6 months to 2 years permit re-issue fee is \$150.00. After 2 years re-issue fee is charged at full price per current fee schedule.

[Signature]
Signature of Owner/Contractor/Officer(s) of Corporation

6-15-15
Date

Affidavit for Worker's Compensation N.C.G.S. 87-14

The undersigned applicant being the:

General Contractor Owner Officer/Agent of the Contractor or Owner

Do hereby confirm under penalties of perjury that the person(s), firm(s) or corporation(s) performing the work set forth in the permit:

Has three (3) or more employees and has obtained workers' compensation insurance to cover them.

Has one (1) or more subcontractors(s) and has obtained workers' compensation insurance to cover them.

Has one (1) or more subcontractors(s) who has their own policy of workers' compensation insurance covering themselves.

Has no more than two (2) employees and no subcontractors.

While working on the project for which this permit is sought it is understood that the Central Permitting Department issuing the permit may require certificates of coverage of worker's compensation insurance prior to issuance of the permit and at any time during the permitted work from any person, firm or corporation carrying out the work.

Company or Name _____

[Signature]
Sign w/Title: _____

Date: 6-15-15