

HTE# 06-50015860

Hannett County Department of Public Health

23352

Improvement Permit

A building permit cannot be issued with only an Improvement Permit

ISSUED TO: Julie Dawn Wester PROPERTY LOCATION: 1229
 SUBDIVISION: Julie Dawn Wester LOT # _____
 NEW REPAIR EXPANSION
 Site Improvements required prior to Construction Authorization Issuance: _____
 Type of Structure: SFD (45x78) 3BR
 Proposed Wastewater System Type: Conventional
 Projected Daily Flow: 360 GPD
 Number of bedrooms: 3 Number of Occupants: 6 max
 Basement Yes No
 Pump Required: Yes No May be required based on final location and elevations of facilities
 Type of Water Supply: Community Public Well Distance from well 50 feet Permit valid for: Five years
 Permit conditions: Meet onsite - maintain all setbacks - keep Pool 15' from septic system - No expiration
I repair - do not farm or drive over septic system - ST4B out plumbing shallow at
ground level or higher

Authorized State Agent: J. W. [Signature] Date: 10-12-06 SEE ATTACHED SITE SKETCH
 The issuance of this permit by the Health Department in no way guarantees the issuance of other permits. The permit holder is responsible for checking with appropriate governing bodies in meeting their requirements. This site is subject to revocation if the site plan, plat, or the intended use changes. The Improvement Permit shall not be affected by a change in ownership of the site. This permit is subject to compliance with the provisions of the Laws and Rules for Sewage Treatment and Disposal and to conditions of this permit.

Construction Authorization

(Required for Building Permit)

The construction and installation requirements of Rules .1950, .1952, .1954, .1955, .1956, .1957, .1958, and .1959 are incorporated by references into this permit and shall be met. Systems shall be installed in accordance with the attached system layout.

ISSUED TO: Julie Dawn Wester PROPERTY LOCATION: 1229
 SUBDIVISION: Julie Dawn Wester LOT # 1
 Facility Type: SFD (45x78) 3BR New Expansion Repair
 Basement? Yes No Basement Fixtures? Yes No
 Type of Wastewater System** Conventional (Initial) Wastewater Flow: 360 GPD
 (See note below, if applicable
LPA (290 LF) (Repair)

Installation Requirements/Conditions

Septic Tank Size 1000 gallons Exact length of each trench 1x240 feet Trench Spacing: 9 Feet on Center
 Pump Tank Size _____ gallons Trenches shall be installed on contour at a Soil Cover: 6 inches
 Maximum Trench Depth of: 18-24 inches (Maximum soil cover shall not exceed
 (Trench bottoms shall be level to +1/4" 36" above the trench bottom)
 in all directions)
 Pump Requirements: _____ ft. TDH vs. _____ GPM Aggregate Depth: 6 inches below pipe
 _____ inches above pipe
 Conditions: _____ 12 inches total

**If applicable: I understand the system type specified is different from the type specified on the application. I accept the specifications of this permit.

Owner/Legal Representative Signature: _____ Date: _____

This Construction Authorization is subject to revocation if the site plan, plat, or the intended use changes. The Construction Authorization shall not be transferred when there is a change in ownership of the site. This Construction Authorization is subject to compliance with the provisions of the Laws and Rules for Sewage Treatment and Disposal and to the conditions of this permit.

Authorized State Agent: J. W. [Signature] Date: 10-12-06 SEE ATTACHED SITE SKETCH
 Construction Authorization Expiration Date: 10-12-2011

HTE# 06-50015860

Permit # 23352

Harnett County Department of Public Health Site Sketch

ISSUED TO: Julie Dawn Wester

PROPERTY LOCATOR: 1229

SUBDIVISION Julie Dawn Wester

LOT # 1

Authorized State Agent: J. Wester

Date: 10-12-06

Note Pool must be 15' from
Any part of septic system & Repair Area
Pool may need to move to accommodate
The septic system

Once septic system has been installed
Do not FARM or DRIVE on top of septic
System AREA

STAB out Plumbing shallow (at ground level
or higher) where shown

MAINTAIN All setbacks

Line 1 = 120'

Line 2 = 120'

Total 240' of conventional Line
meet onsite for Final
Layout

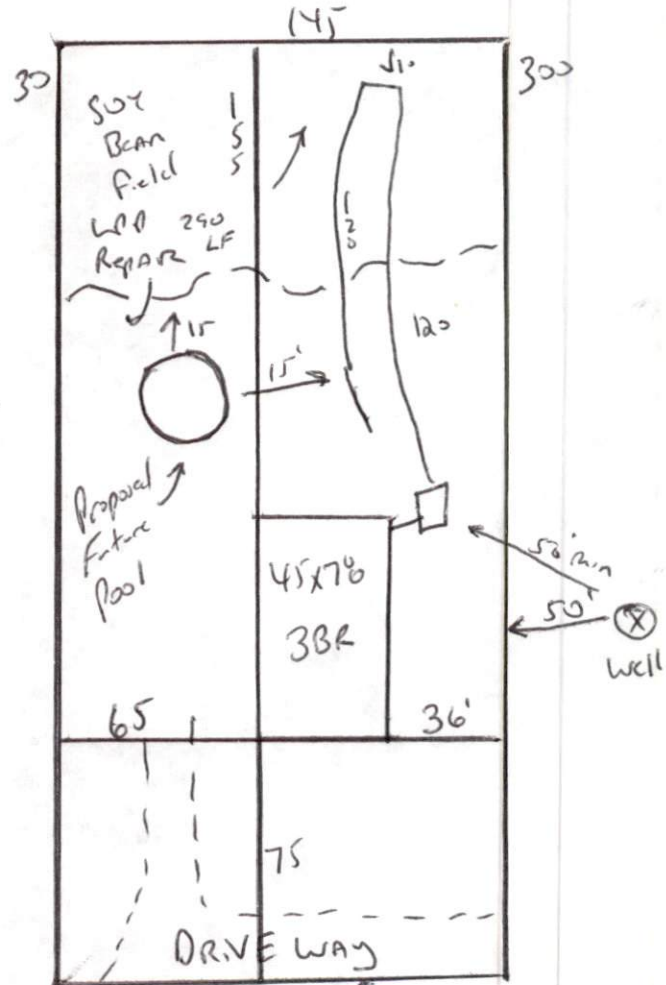

50' Easement
to SR
1229