

03-5-6194 R

HARNETT COUNTY HEALTH DEPARTMENT

No 19737

IMPROVEMENT PERMIT

Be it ordained by the Harnett County Board of Health as follows: Section III, Item B. "No Person shall begin construction of any building at which a septic tank system is to be used for disposal of sewage without first obtaining a written permit from the Harnett County Health Department."

Name: (owner) Eugene Ertle Chance III

New Installation Septic Tank

Property Location: SR# 1481 Blackmon Rd

Repairs Nitrification Line

Subdivision Eugene Chance III Lot # A

Tax ID # _____ Quadrant # _____

Number of Bedrooms Proposed: 3 1/2 Lot Size: .90 Ac

Basement with Plumbing: Garage:

Water Supply: Well Public Community

Distance From Well: 50 m. ft.

Following is the minimum specifications for sewage disposal system on above captioned property. Subject to final approval.

Type of system: Conventional Other 25% Reduct. in System 11/4/2004

Size of tank: Septic Tank: 1000 gallons Pump Tank: _____ gallons

Subsurface Drainage Field No. of ditches 5 exact length of each ditch 80 ft. width of ditches 3 ft. depth of ditches 18 2/4 in.

French Drain Required: _____ Linear feet

Date: 1/24/2003

Signed: [Signature] Environmental Health Specialist

This permit is subject to revocation if site plans or intended use change.

* Maintain all setbacks

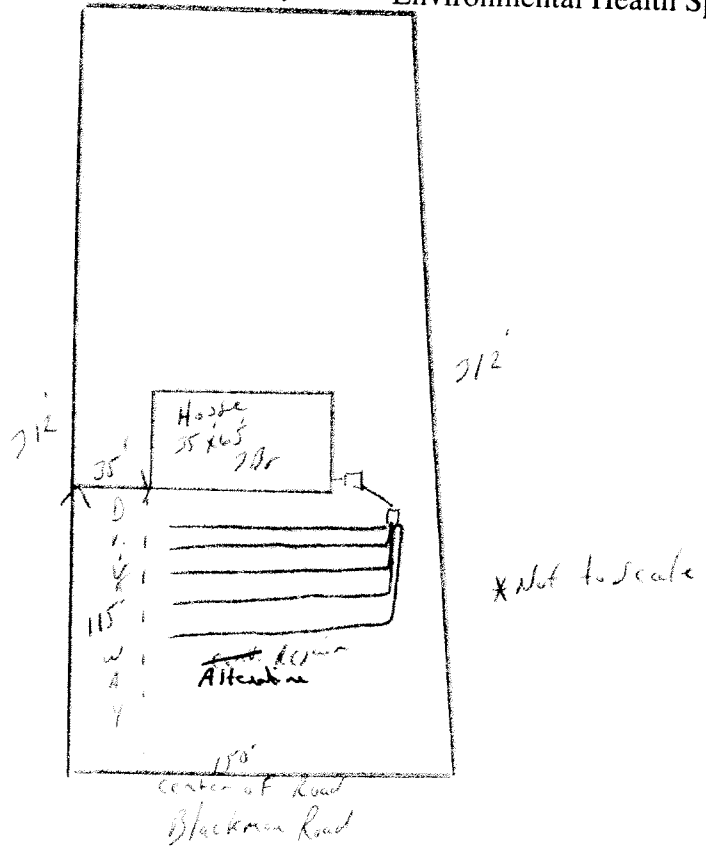

HARNETT COUNTY HEALTH DEPARTMENT
AUTHORIZATION TO CONSTRUCT

Authorization is hereby given to construct a wastewater system to the specifications described by Harnett County Health Department, Improvement Permit # 19737. This authorization shall be valid for a period not to exceed five (5) years from the date of issuance. This authorization will be invalid if ownership, site plans, or intended use change.

Name Eugene Ertle Chance III Telephone# 892-5573

Address 1799 W. Blackmon Rd. Dunn, N.C. 28334

Property Location SR# 1481 Road Name Blackmon

Subdivision Eugene Ertle Chance III Lot # A # Bedrooms Proposed 3 Lot Size 90 Ac

TYPE OF SYSTEM

New Installation Repair Septic Tank Nitrification Lines

Conventional Other 25% Reduc. flow system

Basement With Plumbing Without Plumbing

Water Supply: Well Public Water Supply Minimum Well Setback: 50 Ft.

Septic Tank 1000 gal Pump Chamber _____

NITRIFICATION FIELD SPECIFICATIONS

Number of fields 1 # of lines per field 5 Length of lines 80 Ft.

Width of ditches 3 ft. Depth of ditches 18-24 inches

French Drain: Linear feet required _____ Depth of gravel _____

No wastewater system shall be covered or placed into use by any person until an inspection by the Harnett County Health Department has determined that the system has been installed according to the conditions of the Improvement Permit and that a valid Operations Permit has been issued.

Bryan McLean R.S.
Signature of Authorized Agent for Harnett County of Harnett

1/24/2005
11/4/2004 Date