

HTE 03-5-6676

16426

# OPERATIONS PERMIT

Name: (owner) Feliciano Avilez

New Installation  Septic Tank

Property Location: SR# 1412 Christian Light

Repairs  Nitrification Line

Subdivision Severed Forest

Lot # \_\_\_\_\_

Tax ID # \_\_\_\_\_

Quadrant # \_\_\_\_\_

Contractor: Ed Hudson

Registration # \_\_\_\_\_

Basement with Plumbing:  Garage:

Water Supply:  Well  Public  Community

Distance From Well: 50' ft.

**Following are the specifications for the sewage disposal system on above captioned property.**

Type of system:  Conventional  Other Pump to Conventional

Size of tank: Septic Tank: 1000 gallons Pump Tank: 1000 gallons

Subsurface Drainage Field No. of ditches 3 exact length of each ditch 115 ft. width of ditches 3 ft. depth of ditches 18 in.

French Drain Required: - Linear feet

Date: 11-10-03

PERMIT NO. 1996Z

Inspected by: James E. Manhart @KS  
Environmental Health Specialist

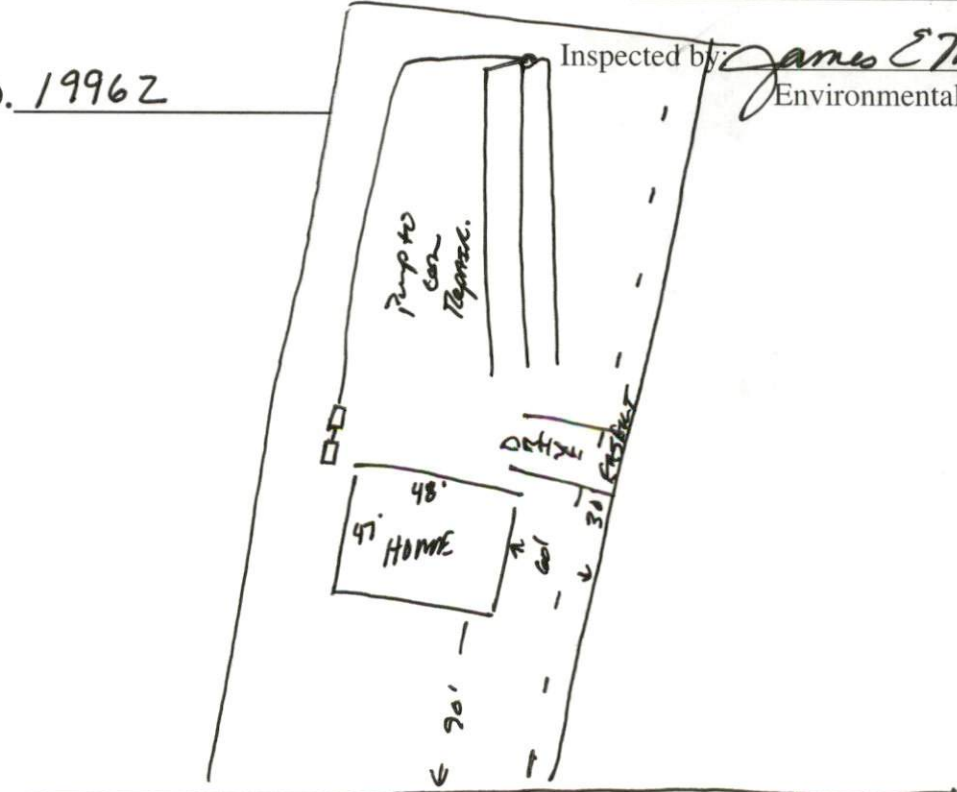

SR 1412 CHRISTIAN LIGHT RD