

HTE# 18-543628

# Harnett County Department of Public Health

25252

PERMIT # 30028

## Operation Permit

New Installation  Septic Tank  Nitrification Line  Repair  Expansion

PROPERTY LOCATION: RAY RD

Name: (owner) GEORGE FINK SUBDIVISION \_\_\_\_\_ LOT # \_\_\_\_\_

System Installer: LARRY SHARPE Registration # \_\_\_\_\_

Basement with plumbing:  Garage  Number of Bedrooms 3

Type of Water Supply:  Community  Public  Well Distance from well \_\_\_\_\_ feet

System Type: III Types V and VI Systems expire in 5 years.

(In accordance with Table V a)

Owner must contact Health Department 6 months prior to expiration for permit renewal.

This system has been installed in compliance with applicable North Carolina General Statutes, Rules for Sewage Treatment and Disposal, and all conditions of the Improvement Permit and Construction Authorization.

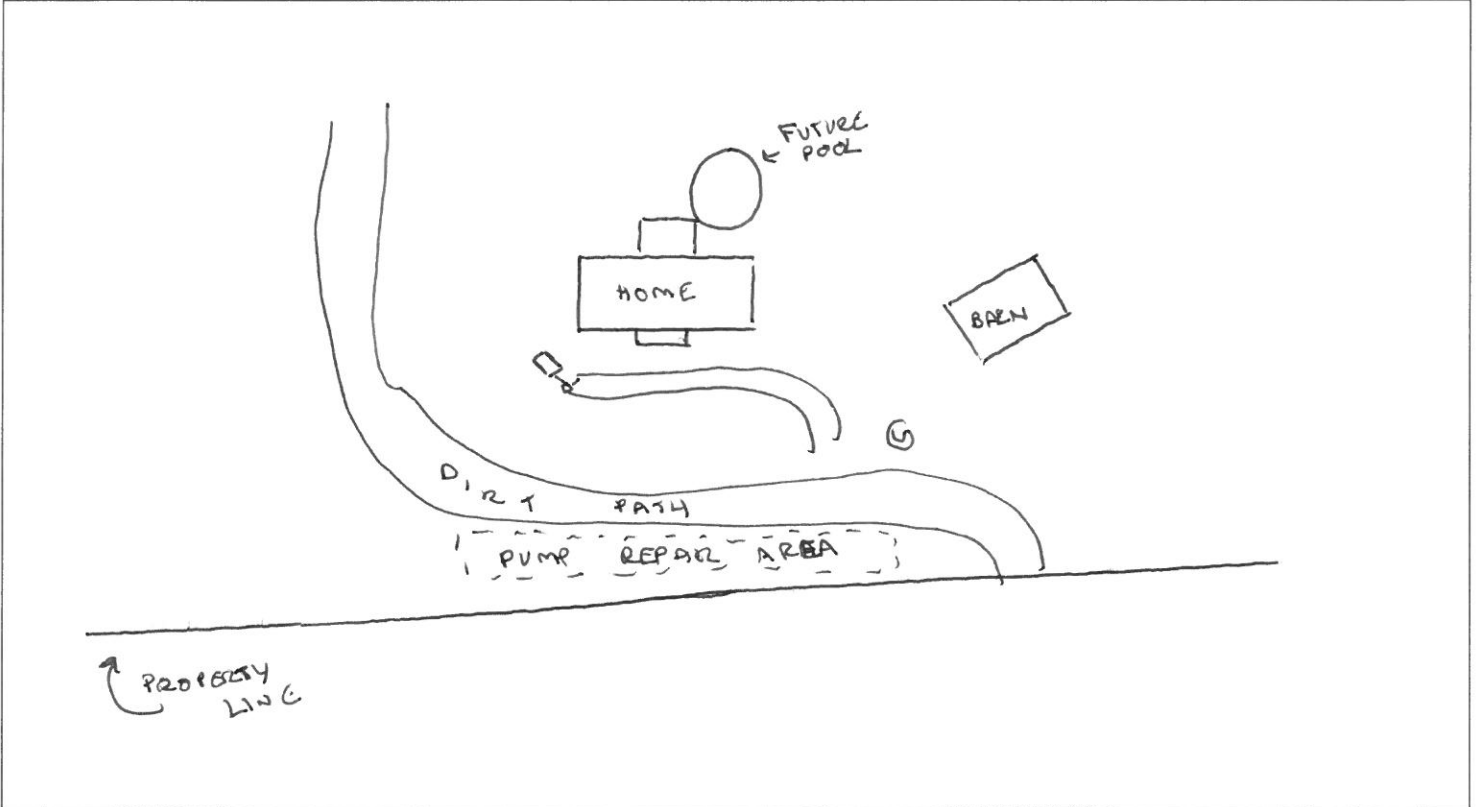

### PERMIT CONDITIONS:

- I. Performance: System shall perform in accordance with Rule .1961.
- II. Monitoring: As required by Rule .1961.
- III. Maintenance: As required by Rule .1961. Other: \_\_\_\_\_  
Subsurface system operator required? Yes  No   
If yes, see attached sheet for additional operation conditions, maintenance and reporting.
- IV. Operation: \_\_\_\_\_
- V. Other: \_\_\_\_\_

D-Box  Pump  Alarm  H2O Line  PWR Line

Following are the specifications for the sewage disposal system on the above captioned property.

Type of system:  Conventional  Other TIRE CHIPS Septic Tank: 1000 gallons Pump Tank: \_\_\_\_\_ gallons

Subsurface Drainage Field: No. of ditches 2 exact length of each ditch 110 feet width of ditches 3 feet depth of ditches 18 inches

French Drain Required: \_\_\_\_\_ Linear feet

Authorized State Agent \_\_\_\_\_

RGHS

Date 12/4/18

Customer: 0369650001 / Larry Sharpes

Scale  
Gross: 42640 LBS Out Manual Wt  
Tare: 22300 LBS In Manual Wt  
Net: 20340 LBS

Generator: NA / Not Applicable  
Dest: DEST: CUSTOMER / Customer  
Truck: LARRY

Comment:

| Origin              | Wastes & Sevices            | Quantity Unit | Rate/Unit     | Amount   |
|---------------------|-----------------------------|---------------|---------------|----------|
| NA / Not Applicable | DFMT116/Drain Fill Material | 10.17 TON     | \$25.00/TN    | \$254.25 |
|                     |                             |               | Total Taxes:  | \$17.80  |
|                     |                             |               | Total Amount: | \$272.05 |

Driver: \_\_\_\_\_

Deputy Weighmaster: Elizabeth Nipper

*Larry Sharpes*

This load of fire chips is from the Fuel Grade location and meets the Nc specification as stated in innovative Wastewater system approval IWWS-2002-03R for fire chip Substitution for Rock Aggregate in Nitrification Fields.