

HTE# 14-5-33061

Harnett County Department of Public Health

23111

PERMIT # 27909

Operation Permit

New Installation Septic Tank Nitrification Line Repair Expansion

PROPERTY LOCATION: 24/27

Name: (owner) Charles Wickman SUBDIVISION _____ LOT # _____

System Installer: Larry Sharpe Registration # _____

Basement with plumbing: Garage Number of Bedrooms 3

Type of Water Supply: Community Public Well Distance from well _____ feet

System Type: III G Types V and VI Systems expire in 5 years.

(In accordance with Table V a)

Owner must contact Health Department 6 months prior to expiration for permit renewal.

This system has been installed in compliance with applicable North Carolina General Statutes, Rules for Sewage Treatment and Disposal, and all conditions of the Improvement Permit and Construction Authorization.

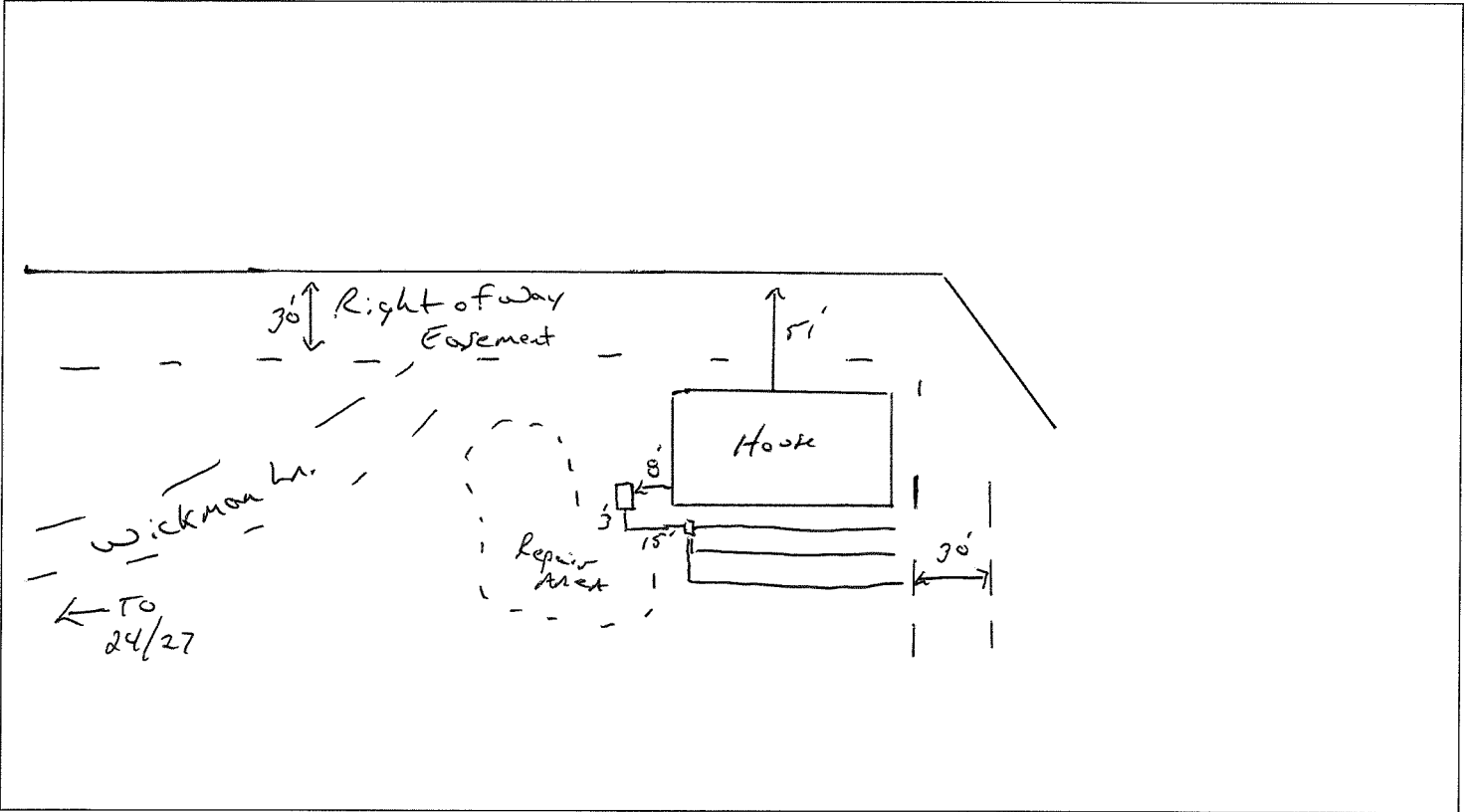

PERMIT CONDITIONS:

- I. Performance: System shall perform in accordance with Rule .1961.
- II. Monitoring: As required by Rule .1961.
- III. Maintenance: As required by Rule .1961. Other: _____
Subsurface system operator required? Yes No
If yes, see attached sheet for additional operation conditions, maintenance and reporting.

IV. Operation: _____

V. Other: _____

D-Box Pump Alarm H2O Line PWR Line

Following are the specifications for the sewage disposal system on the above captioned property.

Type of system: Conventional Other E2Flow Septic Tank: 1000 gallons Pump Tank: _____ gallons
 Subsurface Drainage Field: No. of ditches 3 exact length of each ditch 40 feet width of ditches 3 feet depth of ditches 18-24 inches
 French Drain Required: _____ Linear feet

Authorized State Agent Bryan McLean REHS Date 4/17/2014

14-5-33061

