

HTE# 11-5-261982

Harnett County Department of Public Health

PERMIT # 26426

Operation Permit

22070

New Installation Septic Tank Nitrification Line Repair Expansion

PROPERTY LOCATION: 821708 Hodge Chapel CH RD

Name: (owner) KURT STABIRA SUBDIVISION _____ LOT # _____

System Installer: Kenneth Peck Registration # _____

Basement with plumbing: Garage Number of Bedrooms 4

Type of Water Supply: Community Public Well Distance from well 104' feet

System Type: 25% BOD System Type III G Bury Types V and VI Systems expire in 5 years.

(In accordance with Table V a) Owner must contact Health Department 6 months prior to expiration for permit renewal.

This system has been installed in compliance with applicable North Carolina General Statutes, Rules for Sewage Treatment and Disposal, and all conditions of the Improvement Permit and Construction Authorization.

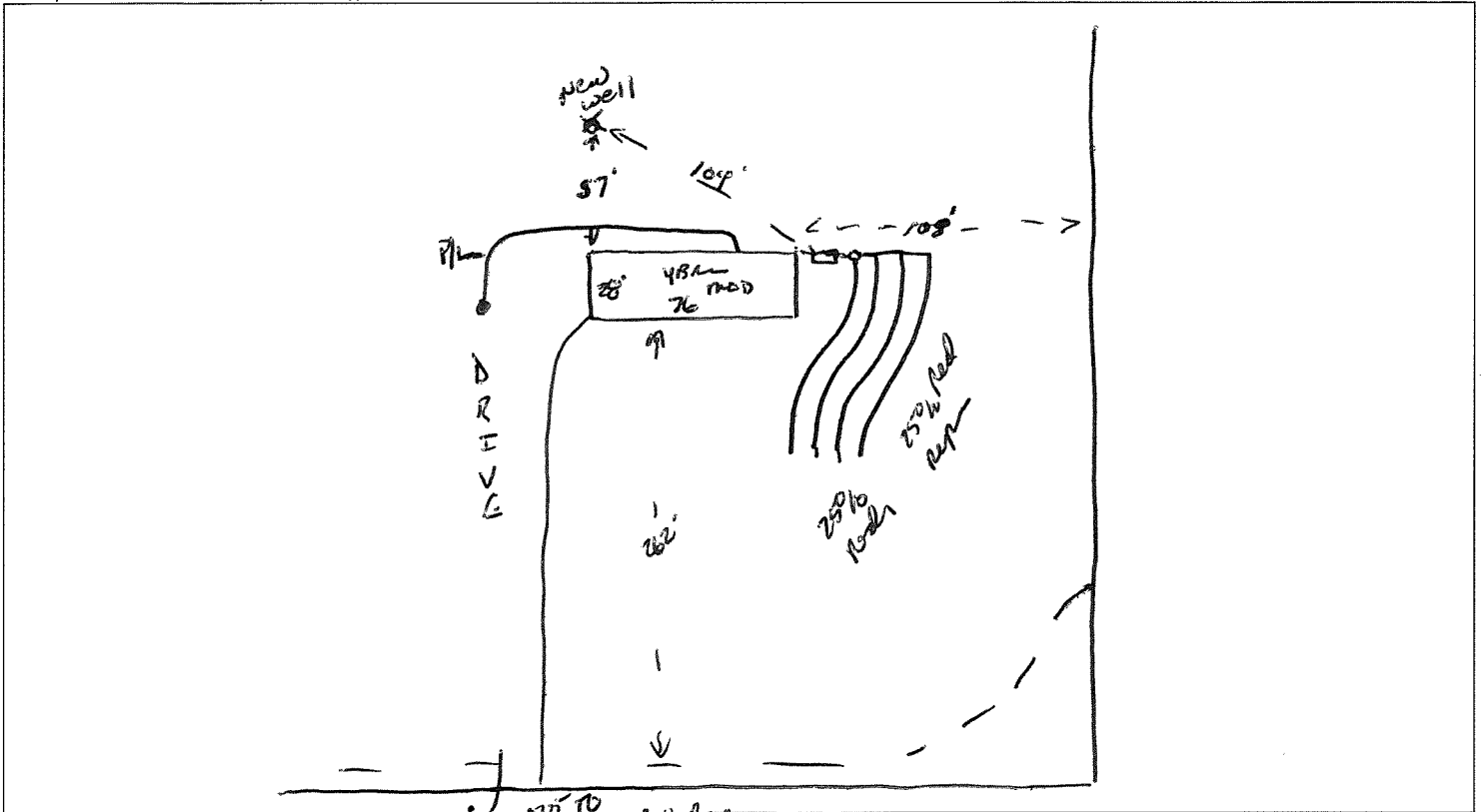

PERMIT CONDITIONS:

- I. Performance: System shall perform in accordance with Rule .1961.
- II. Monitoring: As required by Rule .1961.
- III. Maintenance: As required by Rule .1961. Other: _____

Subsurface system operator required? Yes No

If yes, see attached sheet for additional operation conditions, maintenance and reporting.

IV. Operation: _____

V. Other: _____

D-Box Pump Alarm H2O Line PWR Line

Following are the specifications for the sewage disposal system on the above captioned property.

Type of system: Conventional Other 25% BOD Type III G Bury Septic Tank: 2200 gallons Pump Tank: _____ gallons

Subsurface Drainage Field No. of ditches 4 exact length of each ditch 100 feet width of ditches 3 feet depth of ditches 20 inches

French Drain Required: _____ Linear feet

Authorized State Agent Jones E. [Signature] Date 10-4-11