

HTE# 08-5-20318

Harris County Department of Public Health

24820

Improvement Permit

A building permit cannot be issued with only an Improvement Permit

ISSUED TO: Betty L Lee
NEW REPAIR EXPANSION

PROPERTY LOCATION: JR 1705 OLD FAIRGROUND RD
SUBDIVISION McLamb/Johnson LOT # 11

Site Improvements required prior to Construction Authorization Issuance:

Type of Structure: SFD

Proposed Wastewater System Type:

Projected Daily Flow: 360 GPD

Number of bedrooms: 3 Number of Occupants: 6 max

Basement Yes No

Pump Required: Yes No May be required based on final location and elevations of facilities

Type of Water Supply: Community Public Well Distance from well 106 + 130 feet

Permit valid for: Five years No expiration

Permit conditions:

Authorized State Agent: James E. Mahan Date: 6-26-08 SEE ATTACHED SITE SKETCH

The issuance of this permit by the Health Department in no way guarantees the issuance of other permits. The permit holder is responsible for checking with appropriate governing bodies in meeting their requirements. This site is subject to revocation if the site plan, plat, or the intended use changes. The Improvement Permit shall not be affected by a change in ownership of the site. This permit is subject to compliance with the provisions of the Laws and Rules for Sewage Treatment and Disposal and to conditions of this permit.

Construction Authorization

(Required for Building Permit)

The construction and installation requirements of Rules .1950, .1952, .1954, .1955, .1956, .1957, .1958, and .1959 are incorporated by references into this permit and shall be met. Systems shall be installed in accordance with the attached system layout.

ISSUED TO: Betty L Lee

PROPERTY LOCATION: SJ 1705 OLD FAIRGROUND RD
SUBDIVISION McLamb/Johnson LOT # 11

Facility Type: SFD New Expansion Repair

Basement? Yes No Basement Fixtures? Yes No

Type of Wastewater System** 25% REDUCTION SYSTEM (Initial) Wastewater Flow: 360 GPD

(See note below, if applicable) 25% REDUCTION SYSTEM (Repair)

Installation Requirements/Conditions

Septic Tank Size 1000 gallons Number of trenches 3

Pump Tank Size _____ gallons Exact length of each trench 80 feet Trench Spacing: 9 Feet on Center

Maximum Trench Depth of: 28-18 inches (Trench bottoms shall be level to +/- 1/4" in all directions) Trenches shall be installed on contour at a Soil Cover: 6 inches (Maximum soil cover shall not exceed 36" above the trench bottom)

Pump Requirements: _____ ft. TDH vs. _____ GPM Aggregate Depth: 6 inches below pipe

Conditions: _____ 2 inches above pipe 12 inches total

**If applicable: I understand the system type specified is different from the type specified on the application. I accept the specifications of this permit.

Owner/Legal Representative Signature: _____ Date: _____

This Construction Authorization is subject to revocation if the site plan, plat, or the intended use changes. The Construction Authorization shall not be transferred when there is a change in ownership of the site. This Construction Authorization is subject to compliance with the provisions of the Laws and Rules for Sewage Treatment and Disposal and to the conditions of this permit. SEE ATTACHED SITE SKETCH

Authorized State Agent: James E. Mahan Date: 6-26-08
Construction Authorization Expiration Date: 6-26-13

HTE# 08-5-20318

Permit # 24820

Harnett County Department of Public Health Site Sketch

ISSUED TO: Betty L Lee

PROPERTY LOCATOR: 5121705 OLD FARMGROUNDS RD

SUBDIVISION McLamb/Johnson

LOT # 11

Authorized State Agent: James E. Mowbray

Date: 6-26-08

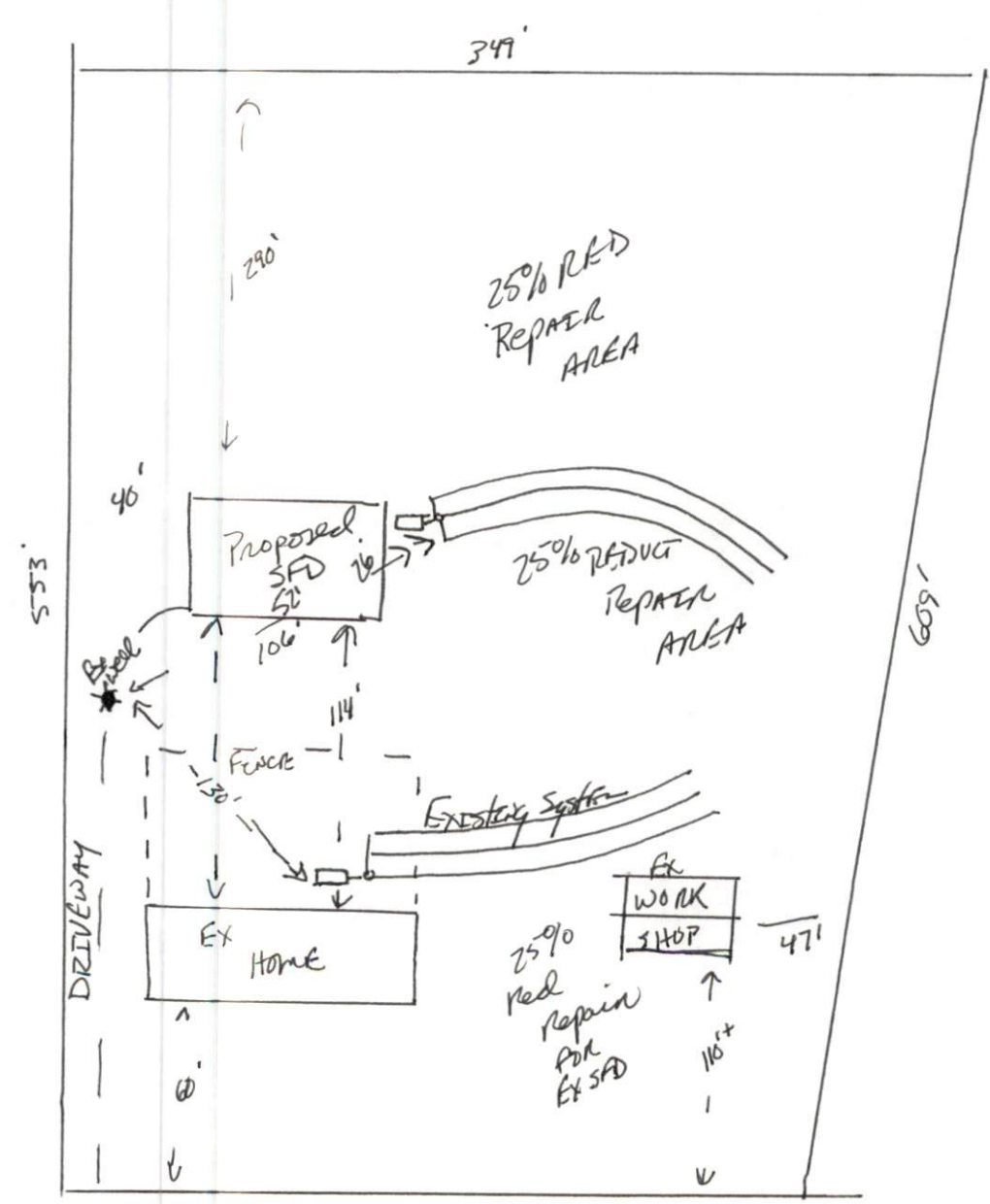

SR 1705



294
East to OLD FARMGROUNDS RD SR 1705

