

HTE# 08-500-20097

Harnett County Department of Public Health

24862

Improvement Permit

A building permit cannot be issued with only an Improvement Permit

ISSUED TO: Alicia W. Shytle
NEW [X] REPAIR [ ] EXPANSION [ ]
Type of Structure: Mod 58x34 3BR
Proposed Wastewater System Type: Pump to Gravel
Projected Daily Flow: 360 GPD
Number of bedrooms: 3 Number of Occupants: 6 max
Basement [ ] Yes [X] No

PROPERTY LOCATION: Old 421
SUBDIVISION: Alicia W. Shytle LOT # 1
Site Improvements required prior to Construction Authorization Issuance: 6.41m
Do not DRIVE OR park on
Any part of septic system

Pump Required: [ ] Yes [ ] No [X] May be required based on final location and elevations of facilities
Type of Water Supply: [ ] Community [X] Public [ ] Well Distance from well 50 feet
Permit valid for: [X] Five years [ ] No expiration
Permit conditions: Mod on site maintain all set back -
STUB out Plumbing shallow, at ground level or higher where shown
And P 18" P. Tech Digging can be maintained then pump may not be required.

Authorized State Agent: J. L. LAM Date: 06-19-08 SEE ATTACHED SITE SKETCH
The issuance of this permit by the Health Department in no way guarantees the issuance of other permits. The permit holder is responsible for checking with appropriate governing bodies in meeting their requirements. This site is subject to revocation if the site plan, plat, or the intended use changes. The Improvement Permit shall not be affected by a change in ownership of the site. This permit is subject to compliance with the provisions of the Laws and Rules for Sewage Treatment and Disposal and to conditions of this permit.

Construction Authorization

(Required for Building Permit)

The construction and installation requirements of Rules .1950, .1952, .1954, .1955, .1956, .1957, .1958, and .1959 are incorporated by references into this permit and shall be met. Systems shall be installed in accordance with the attached system layout.

ISSUED TO: Alicia W. Shytle
Facility Type: Mod 58x34 3BR [X] New [ ] Expansion [ ] Repair
Basement? [ ] Yes [X] No Basement Fixtures? [ ] Yes [X] No
Type of Wastewater System\*\* Pump to Gravel (Initial) Wastewater Flow: GPD
(See note below, if applicable [X] Gravel (Repair)

PROPERTY LOCATION: Old 421
SUBDIVISION: Alicia W. Shytle LOT # 1
6.41 ac

Installation Requirements/Conditions
Septic Tank Size 1000 gallons
Pump Tank Size 1000 gallons
ZF Needed
Number of trenches 1
Exact length of each trench 300 feet
Trenches shall be installed on contour at a
Maximum Trench Depth of: 18 inches
(Trench bottoms shall be level to +/- 1/4" in all directions)
Trench Spacing: 9 Feet on Center
Soil Cover: 6 inches
(Maximum soil cover shall not exceed 36" above the trench bottom)
Pump Requirements: ft. TDH vs. GPM
Aggregate Depth: 6 inches below pipe
2 inches above pipe
12 inches total

\*\*If applicable: I understand the system type specified is different from the type specified on the application. I accept the specifications of this permit.
Owner/Legal Representative Signature: Date:

This Construction Authorization is subject to revocation if the site plan, plat, or the intended use changes. The Construction Authorization shall not be transferred when there is a change in ownership of the site. This Construction Authorization is subject to compliance with the provisions of the Laws and Rules for Sewage Treatment and Disposal and to the conditions of this permit. SEE ATTACHED SITE SKETCH

Authorized State Agent: J. L. LAM Date: 06-19-08
Construction Authorization Expiration Date: 06-19-2013

HTE# 08-500-20097

Permit # 24862

# Harnett County Department of Public Health Site Sketch

ISSUED TO: Alicia W. Shytle PROPERTY LOCATOR: Old 421  
 SUBDIVISION: Alicia W Shytle LOT # 1  
 Authorized State Agent: Joe [Signature] Date: 06-19-08  
 6.41 ac

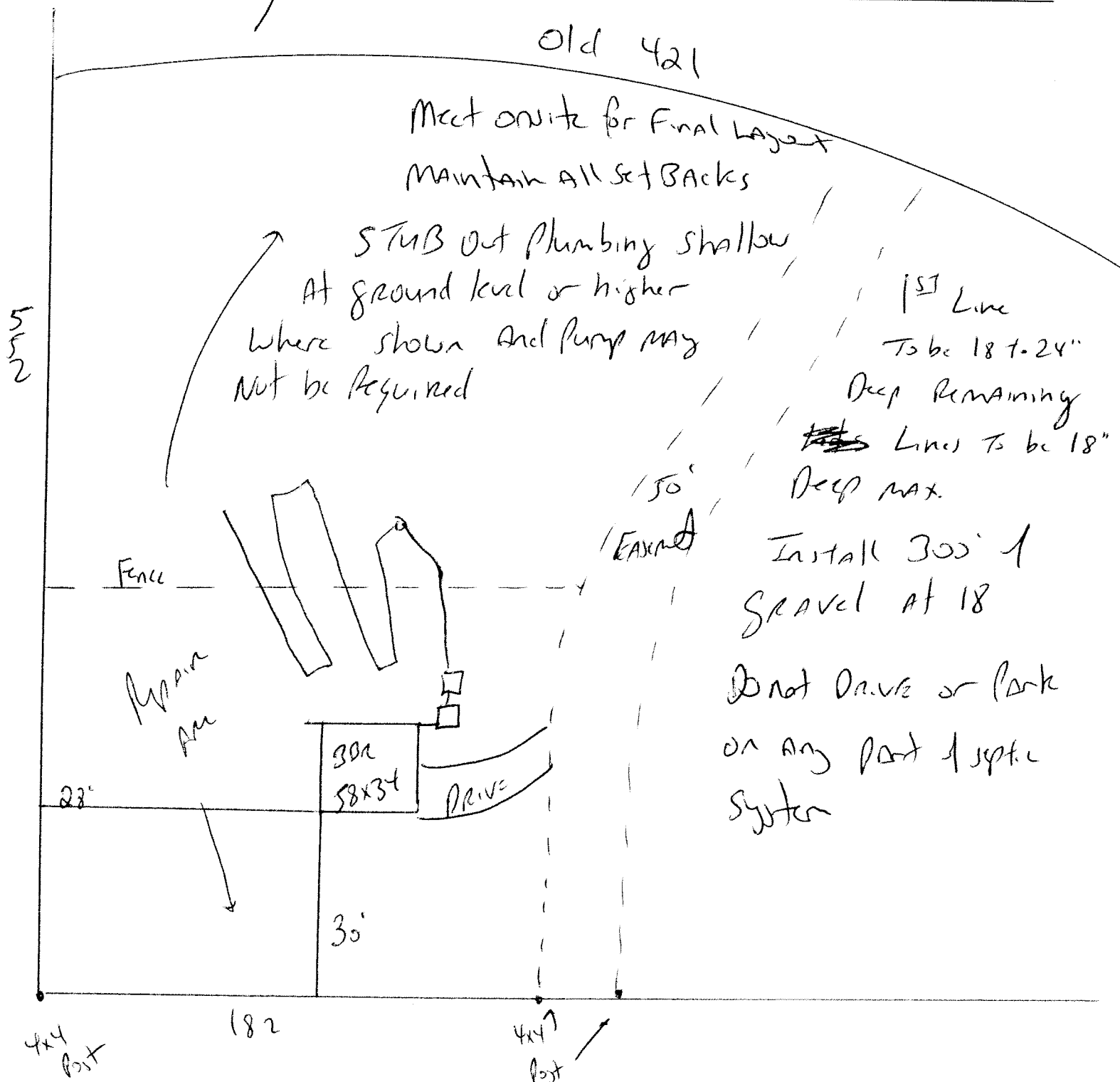

Old 421  
 Meet onsite for Final Layout  
 Maintain All Setbacks

STUB out Plumbing shallow  
 At ground level or higher  
 Where shown and Pump may  
 Not be Required

15' Line  
 To be 18"-24"  
 Deep Remaining  
~~the~~ Lines To be 18"  
 Deep Max.

Install 300' of  
 Gravel at 18"  
 Do not Drive or Park  
 on any part of septic  
 system

552

4x4 Post

4x4 Post