

Initial Application Date: 8-7-07

Application # 0750018185

COUNTY OF HARNETT LAND USE APPLICATION

Central Permitting 108 E. Front Street, Lillington, NC 27546 Phone: (910) 893-7525 Fax: (910) 893-2793 www.harnett.org

LANDOWNER: DURANE CURRIN Mailing Address: 1044 FLEMING Rd.

City: COATS State: N.C. Zip: 27521 Home #: 9192077640 Contact #: 9192077640

APPLICANT\*: GORDON T. SMITH Mailing Address: \_\_\_\_\_

City: \_\_\_\_\_ State: \_\_\_\_\_ Zip: \_\_\_\_\_ Home #: \_\_\_\_\_ Contact #: 9108921722

\*Please fill out applicant information if different than landowner

PROPERTY LOCATION: Subdivision: QUAIL HOLLOW Lot #: 20 Lot Size: .60 Acres

Parcel: 07 1611 0058 20 PIN: 1611-24-7075-000

Zoning: RAZDM Flood Plain: X Panel: 1100 Watershed: 01A Deed Book&Page: 1836/370 Map Book&Page: D/174 B

SPECIFIC DIRECTIONS TO THE PROPERTY FROM LILLINGTON: TAKE 421 TO BUSSER CREEK - TL ON Hwy 27 GO TO COATS, TL ON EBENEZER CH. RD. - 2 MILES - TL ON JOHNSON RD. - TR ON ST. LAS MARE RD - LOT IS ON LEFT. (BOTH LOTS ON LEFT IN SUBDIV.)

PROPOSED USE:

Circle:

- SFD (Size 30 x 62) # Bedrooms 3 # Baths 2 Basement (w/wo bath) \_\_\_\_\_ Garage \_\_\_\_\_ Deck \_\_\_\_\_ Crawl Space / Slab \_\_\_\_\_
- Modular:  On frame  Off frame (Size 30 x 62) # Bedrooms 3 # Baths 2 Garage NO (site built? \_\_\_\_\_) Deck NO (site built? \_\_\_\_\_)
- Multi-Family Dwelling No. Units \_\_\_\_\_ No. Bedrooms/Unit \_\_\_\_\_
- Manufactured Home: SW DW TW (Size 30 x 62) # Bedrooms \_\_\_\_\_ Garage \_\_\_\_\_ (site built? \_\_\_\_\_) Deck \_\_\_\_\_ (site built? \_\_\_\_\_)
- Business Sq. Ft. Retail Space \_\_\_\_\_ Type \_\_\_\_\_ # Employees: \_\_\_\_\_ Hours of Operation: \_\_\_\_\_
- Industry Sq. Ft. \_\_\_\_\_ Type \_\_\_\_\_ # Employees: \_\_\_\_\_ Hours of Operation: \_\_\_\_\_
- Church Seating Capacity \_\_\_\_\_ # Bathrooms \_\_\_\_\_ Kitchen \_\_\_\_\_
- Home Occupation (Size 30 x 62) # Rooms \_\_\_\_\_ Use \_\_\_\_\_ Hours of Operation: \_\_\_\_\_
- Accessory/Other (Size 30 x 62) Use \_\_\_\_\_
- Addition to Existing Building (Size 30 x 62) Use \_\_\_\_\_ Closets in addition ( ) yes ( ) no

Water Supply:  County ( ) Well (No. dwellings \_\_\_\_\_) **MUST** have operable water before final

Sewage Supply:  New Septic Tank (Complete **New Tank Checklist**) ( ) Existing Septic Tank ( ) County Sewer ( ) Other

Property owner of this tract of land own land that contains a manufactured home w/in five hundred feet (500') of tract listed above?  YES ( ) NO

Structures on this tract of land: Single family dwellings 1 PROP Manufactured Homes \_\_\_\_\_ Other (specify) \_\_\_\_\_

Required Residential Property Line Setbacks: \_\_\_\_\_ Comments: \_\_\_\_\_

| Front                        | Minimum | Actual  |
|------------------------------|---------|---------|
|                              | 35      | 63      |
| Rear                         | 25      | 147     |
| Side                         | 10      | 18 + 30 |
| Sidestreet/corner lot        | 20      |         |
| Nearest Building on same lot | 6       |         |

UID 44019

If permits are granted I agree to conform to all ordinances and the laws of the State of North Carolina regulating such work and the specifications of plans submitted. I hereby state that the foregoing statements are accurate and correct to the best of my knowledge. This permit is subject to revocation if false information is provided on this form.

Gordon T. Smith  
Signature of Owner or Owner's Agent

8-7-07  
Date

\*\*This application expires 6 months from the initial date if no permits have been issued\*\*

A RECORDED SURVEY MAP, RECORDED DEED (OR OFFER TO PURCHASE) AND PLAT ARE REQUIRED WHEN APPLYING FOR LAND USE APPLICATION

Please use Blue or Black Ink ONLY

\* INCLUDES BUILT IN PORCH (UNDER ROOF) 5' x 40'

PROPERTY OF DURANE CURTIN  
 Lot 20 QUAIL HOLLOW SUBDIV  
 911 Address: 951 Silas Moore Rd., COATS, NC.



SITE PLAN APPROVAL  
 DISTRICT R20M USE GMOD  
 #BEDROOMS 3  
JO 8/7/07  
 ZONING ADMINISTRATOR  
 X [Signature]

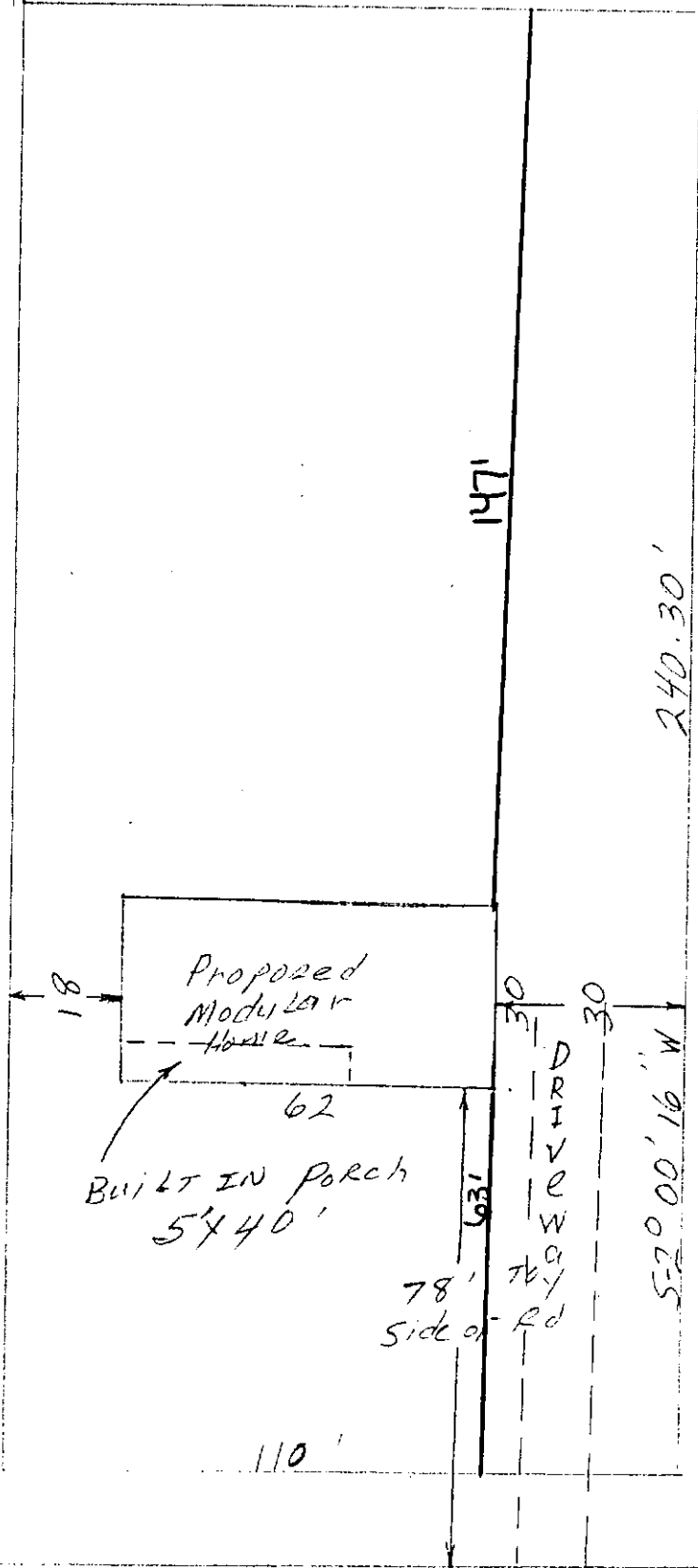

Many home CO in 2001  
 on parcel per He but  
 a tank said never  
 new one

Dig 12" Deep  
6" CONCRETE  
 CUT-A-WAY OF FOURS

SR 1557 Silas Moore Rd.

OWNER NAME: DURANE CURRAN

APPLICATION #: 0750018185

**\*This application to be filled out only when applying for a new septic system.\***

**County Health Department Application for Improvement Permit and/or Authorization to Construct**

IF THE INFORMATION IN THIS APPLICATION IS FALSIFIED, CHANGED, OR THE SITE IS ALTERED, THEN THE IMPROVEMENT PERMIT OR AUTHORIZATION TO CONSTRUCT SHALL BECOME INVALID. The permit is valid for either 60 months or without expiration depending upon documentation submitted. (complete site plan = 60 months; complete plat = without expiration)

**DEVELOPMENT INFORMATION**

- New single family residence
- Expansion of existing system
- Repair to malfunctioning sewage disposal system
- Non-residential type of structure

**WATER SUPPLY**

- New well
- Existing well
- Community well
- Public water
- Spring

Are there any existing wells, springs, or existing waterlines on this property?

yes  no  unknown

**SEPTIC**

If applying for authorization to construct please indicate desired system type(s): can be ranked in order of preference, must choose one.

- Accepted  Innovative
- Alternative  Other \_\_\_\_\_
- Conventional  Any

The applicant shall notify the local health department upon submittal of this application if any of the following apply to the property in question. If the answer is "yes", applicant must attach supporting documentation.

- YES  NO Does the site contain any Jurisdictional Wetlands?
- YES  NO Does the site contain any existing Wastewater Systems?
- YES  NO Is any wastewater going to be generated on the site other than domestic sewage?
- YES  NO Is the site subject to approval by any other Public Agency?
- YES  NO Are there any easements or Right of Ways on this property?
- YES  NO Does the site contain any existing water, cable, phone or underground electric lines?

If yes please call No Cuts at 800-632-4949 to locate the lines. This is a free service.

**I Have Read This Application And Certify That The Information Provided Herein Is True, Complete And Correct. Authorized County And State Officials Are Granted Right Of Entry To Conduct Necessary Inspections To Determine Compliance With Applicable Laws And Rules. I Understand That I Am Solely Responsible For The Proper Identification And Labeling Of All Property Lines And Corners And Making The Site Accessible So That A Complete Site Evaluation Can Be Performed.**

*Durane Curran*  
PROPERTY OWNERS OR OWNERS LEGAL REPRESENTATIVE SIGNATURE (REQUIRED)

8.7.07  
DATE

**Harnett County Central Permitting Department**

PO Box 65, Lillington, NC 27546  
910-893-7525

#1 #1

CONF# \_\_\_\_\_

**Environmental Health New Septic Systems Test**  
**Environmental Health Code 800**

- Place "property flags" on each corner iron of lot. All property lines must be clearly flagged approximately every 50 feet between corners.
- Place "house corner flags" at each corner of where the house/manufactured home will sit. Use additional flagging to outline driveways, garages, decks, out buildings, swimming pools, etc.
- Place flags at locations as developed on site plan by Customer Service Technician and you.
- Place Environmental Health "orange" card in location that is easily viewed from road.
- If property is thickly wooded, Environmental Health requires that you clean out the undergrowth to allow the soil evaluation to be performed. Inspectors should be able to walk freely around site. *No grading of property should be done.*
- Call No Cuts to locate utility lines prior to scheduling inspection. 800-632-4949 (This is a free service)
- After preparing proposed site call the voice permitting system at 910-893-7525 and give code **800** for Environmental Health confirmation. **Please note confirmation number given at end of recording for proof of request.**
- Use Click2Gov or IVR to hear results. Once approved, proceed to Central Permitting for permits.

**Environmental Health Existing Tank Inspections**  
**Environmental Health Code 800**

- Place Environmental Health "orange" card in location that is easily viewed from road. Follow above instructions for placing flags on property.
- Prepare for inspection by removing soil over door as diagram indicates. Loosen trap door cover. (Unless inspection is for a septic tank in a mobile home park)
- After preparing trapdoor call the voice permitting system at 910-893-7525 and give code **800** for Environmental Health confirmation. **Please note confirmation number given at end of recording for proof of request.**
- Use Click2Gov or IVR to hear results. Once approved, proceed to Central Permitting for remaining permits.

**Health and Sanitation Inspections**

- After submitting plans for food and lodging to Central Permitting, please allow approximately 7-10 working days for plan status. Use Click2Gov or IVR to hear results.
- Once **all** plans are approved, proceed to Central Permitting for remaining permits.

**Fire Marshal Inspections**

- After submitting plans for Fire Marshal review to Central Permitting, please allow approximately 7-10 working days for approval. Use Click2Gov or IVR to hear results. Once **all** plans are approved, proceed to Central Permitting for permits.
- Fire Marshal's letter must be placed on job site until work is completed.

**Public Utilities**

- Place stake with "orange" tape/name thirty feet (30) from the center of the road at the location you wish to have water tap installed.
- Allow four to six weeks after application for water/sewer taps. Call Utilities at 893-7575 for technical assistance.

**Building Inspections**

- After submitting plans for Building Inspections, please allow approximately 3 working days for review. Use Click2Gov or IVR to hear results. Once **all** plans are approved, proceed to Central Permitting for permits.
- For new housing/set up permits must meet E 911 / Addressing guidelines prior to scheduling final inspection.
- Use Click2Gov or IVR to hear results.

**E911 Addressing**

- **Addressing Confirmation Code 814**
- Address numbers shall be mounted on the house, 3 inches high (5" for commercial).
- Numbers must be a contrasting color from house, must be clearly visible night and day at entrance of driveway if home is 100 ft or more from road, or if mailbox is on opposite side of road.
- Once you purchase permits and footing inspection has been approved call the voice permitting system at 910-893-7525 and give code **814** for address confirmation. This must be called in even if you have contacted E911 for verbal confirmation. Check Click2Gov for results and address.

• **Inspection results can be viewed online at <http://www.harnett.org/services-213.asp> then select Click2Gov**

Applicant/Owner Signature [Signature] Date 8.7.07

