

HTE# 07-10016605

Harnett County Department of Public Health 23622

Improvement Permit

A building permit cannot be issued with only an Improvement Permit

ISSUED TO: Moss Develop PROPERTY LOCATION: 1264
 NEW REPAIR EXPANSION SUBDIVISION: Grande Pine LOT # 2
 Type of Structure: Modular 52x26 33n Site Improvements required prior to Construction Authorization Issuance:
 Proposed Wastewater System Type: Conventional Gravel
 Projected Daily Flow: 360 GPD
 Number of bedrooms: 3 Number of Occupants: 6 max
 Basement Yes No
 Pump Required: Yes No May be required based on final location and elevations of facilities
 Type of Water Supply: Community Public Well Distance from well 50 feet
 Permit conditions: Stub out Plumbing shallow where shown maintain all set back Permit valid for: Five years No expiration

Authorized State Agent: [Signature] Date: 01-24-07 SEE ATTACHED SITE SKETCH
 The issuance of this permit by the Health Department in no way guarantees the issuance of other permits. The permit holder is responsible for checking with appropriate governing bodies in meeting their requirements. This site is subject to revocation if the site plan, plat, or the intended use changes. The Improvement Permit shall not be affected by a change in ownership of the site. This permit is subject to compliance with the provisions of the Laws and Rules for Sewage Treatment and Disposal and to conditions of this permit.

Construction Authorization

(Required for Building Permit)

The construction and installation requirements of Rules .1950, .1952, .1954, .1955, .1956, .1957, .1958, and .1959 are incorporated by references into this permit and shall be met. Systems shall be installed in accordance with the attached system layout.

ISSUED TO: Moss Developers PROPERTY LOCATION: 1264
 Facility Type: Modular 52x26 33n New Expansion Repair LOT # 2
 Basement? Yes No Basement Fixtures? Yes No
 Type of Wastewater System** Conventional Gravel (Initial) Wastewater Flow: 360 GPD
 (See note below, if applicable) 360 LF of LPP (Repair)

Installation Requirements/Conditions

Septic Tank Size 1000 gallons Exact length of each trench 1x300 feet Trench Spacing: 9 Feet on Center
 Pump Tank Size _____ gallons Trenches shall be installed on contour at a Soil Cover: 6 inches
 Maximum Trench Depth of: 18 inches (Maximum soil cover shall not exceed 36" above the trench bottom)
 Pump Requirements: _____ ft. TDH vs. _____ GPM in all directions) Aggregate Depth: 6 inches below pipe
 Conditions: _____ 2 inches above pipe
 _____ 12 inches total

**If applicable: I understand the system type specified is different from the type specified on the application. I accept the specifications of this permit.

Owner/Legal Representative Signature: _____ Date: _____

This Construction Authorization is subject to revocation if the site plan, plat, or the intended use changes. The Construction Authorization shall not be transferred when there is a change in ownership of the site. This Construction Authorization is subject to compliance with the provisions of the Laws and Rules for Sewage Treatment and Disposal and to the conditions of this permit.

Authorized State Agent: [Signature] Date: 01-24-07 SEE ATTACHED SITE SKETCH
 Construction Authorization Expiration Date: 01-24-2012

HTE# 07-50516605

Permit # 23622

Harnett County Department of Public Health Site Sketch

ISSUED TO: Moxxi Developers

PROPERTY LOCATOR: 1264

SUBDIVISION Grande Pines

LOT # 2

Authorized State Agent: J. L. [Signature]

Date: 01-24-07

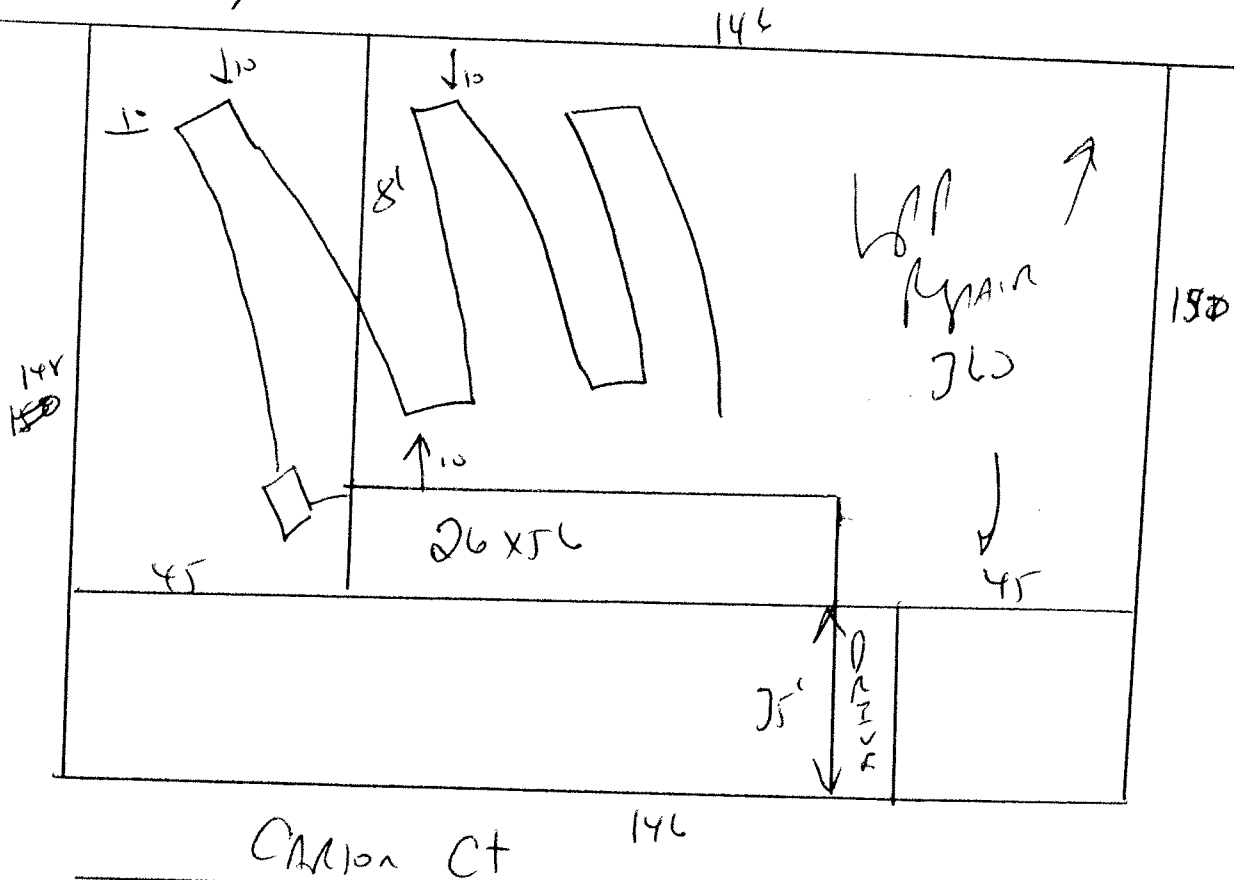

STUB out Plumbing shallow, at ground level or higher
where shown - MAINTAIN ALL SET BACKS
Install 1x300 AT 18"