

Initial Application Date: 1-3-07

Application # 0750016498
1333435

COUNTY OF HARNETT LAND USE APPLICATION
Central Permitting 108 E. Front Street, Lillington, NC 27546 Phone: (910) 893-7525 Fax: (910) 893-2793 www.harnett.org

LANDOWNER: JRS Enterprise on NC LLC Mailing Address: 8125 Robincrest Court.

City: Fuquay-Varina State: NC Zip: 27526 Home #: 919 741-8410 Contact #:

APPLICANT: Palm Harbor Homes Mailing Address: 5429 Fayetteville Rd.

City: Raleigh State: NC Zip: 27603 Home #: 919 669-0966 Contact #: 919 669-0966

PROPERTY LOCATION: State Road #: 1425 State Road Name: Hardee Rd

Parcel: 080643 0002 01 PIN: 0643-07-4287.000

Zoning: RA30 Subdivision: JRS Enter. of NC LLC Lot #: 1 Lot Size: 1.01 AC

Flood Plain: X Panel: 20 Watershed: IV Deed Book/Page: OTP/2114 Plat Book/Page: 2005/1043

SPECIFIC DIRECTIONS TO THE PROPERTY FROM LILLINGTON:
Take 401 N towards Fuquay. Turn left on Christian Light Rd. Turn Right on Hardee Rd. Property is on left. ABOUT 2 miles.

PROPOSED USE

Circle:

- SFD (Size 30x64) # Bedroom: 3 # Baths: 2 Basement (w/wo bath) 1 Garage 1 Deck 1 Crawl Space / Slab
- Modular: On frame Off frame (Size 30 x 64) # Bedrooms 3 # Baths 2 Garage N/A (site built?) Deck N/A (site built?)
- Multi-Family Dwelling No. Units _____ No. Bedrooms/Unit _____
- Manufactured Home: SW DW TW (Size x) # Bedrooms _____ Garage _____ (site built?) Deck _____ (site built?)
- Business Sq. Ft. Retail Space _____ Type _____ # Employees: _____ Hours of Operation: _____
- Industry Sq. Ft. _____ Type _____ # Employees: _____ Hours of Operation: _____
- Church Seating Capacity _____ # Bathrooms _____ Kitchen _____
- Home Occupation (Size x) # Rooms _____ Use _____ Hours of Operation: _____
- Accessory/Other (Size x) Use _____
- Addition to Existing Building (Size x) Use _____ Closets in addition () yes () no

Water Supply: () County () Well (No. dwellings 1) () Other well on site I WANT COUNTY

Sewage Supply: () New Septic Tank (Need to fill out New Tank Checklist) () Existing Septic Tank () County Sewer () Other

Property owner of this tract of land own land that contains a manufactured home w/in five hundred feet (500') of tract listed above? () YES () NO

Structures on this tract of land: Single family dwellings 1 prop Manufactured Homes _____ Other (specify) _____

Required Residential Property Line Setbacks:

Comments:

	Minimum	Actual
Front	35	95
Rear	25	46
Side	10	100
Corner/Sidestreet	20	69
Nearest Building on same lot	10	

- 30x64 includes front covered porch attached to home
- site building 4x4 + 4x6 deck

If permits are granted I agree to conform to all ordinances and the laws of the State of North Carolina regulating such work and the specifications of plans submitted. I hereby state that the foregoing statements are accurate and correct to the best of my knowledge. This permit is subject to revocation if false information is provided on this form.

Dray Evans
Signature of Owner or Owner's Agent

1-2-07
Date

This application expires 6 months from the initial date if no permits have been issued

A RECORDED SURVEY MAP, RECORDED DEED (OR OFFER TO PURCHASE) AND PLAT ARE REQUIRED WHEN APPLYING FOR LAND USE APPLICATION

Please use Blue or Black Ink ONLY

1/8 N 8/06

.ALC. 150

SITE PLAN APPROVAL

DISTRICT RA30 USE OFF MOP

#BEDROOMS 3
[Signature] 1/3/07
ZONING ADMINISTRATOR

Drey Evans 1/3/07

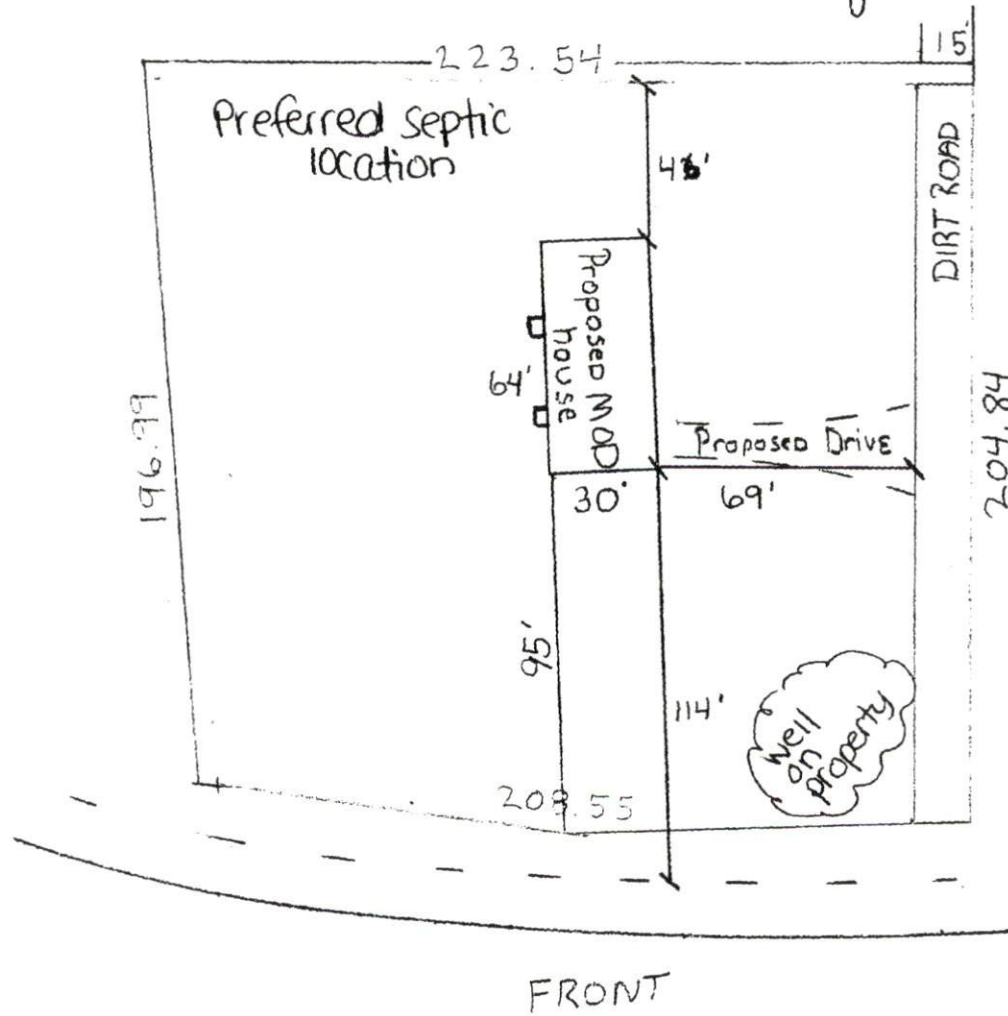

Proposed
OWNER NAME: Shea Cunningham

APPLICATION #: 0750016498

This application to be filled out only when applying for a new septic system.

County Health Department Application for Improvement Permit and/or Authorization to Construct

IF THE INFORMATION IN THIS APPLICATION IS FALSIFIED, CHANGED, OR THE SITE IS ALTERED, THEN THE IMPROVEMENT PERMIT OR AUTHORIZATION TO CONSTRUCT SHALL BECOME INVALID. The permit is valid for either 60 months or without expiration depending upon documentation submitted. (complete site plan = 60 months; complete plat = without expiration)

DEVELOPMENT INFORMATION

- New single family residence
- Expansion of existing system
- Repair to malfunctioning sewage disposal system
- Non-residential type of structure

WATER SUPPLY

- New well
- Existing well
- Community well
- Public water
- Spring

Are there any existing wells, springs, or existing waterlines on this property?

yes no unknown

SEPTIC

If applying for authorization to construct please indicate desired system type(s): can be ranked in order of preference. must choose one.

- Accepted Innovative
- Alternative Other
- Conventional Any

The applicant shall notify the local health department upon submittal of this application if any of the following apply to the property in question. If the answer is "yes", applicant must attach supporting documentation.

- YES NO Does the site contain any Jurisdictional Wetlands?
- YES NO Does the site contain any existing Wastewater Systems?
- YES NO Is any wastewater going to be generated on the site other than domestic sewage?
- YES NO Is the site subject to approval by any other Public Agency?
- YES NO Are there any easements or Right of Ways on this property?
- YES NO Does the site contain any existing water, cable, phone or underground electric lines?

If yes please call No Cuts at 800-632-4949 to locate the lines. This is a free service.

I Have Read This Application And Certify That The Information Provided Herein Is True, Complete And Correct. Authorized County And State Officials Are Granted Right Of Entry To Conduct Necessary Inspections To Determine Compliance With Applicable Laws And Rules. I Understand That I Am Solely Responsible For The Proper Identification And Labeling Of All Property Lines And Corners And Making The Site Accessible So That A Complete Site Evaluation Can Be Performed.

Deey Evans
PROPERTY OWNERS OR OWNERS LEGAL REPRESENTATIVE SIGNATURE (REQUIRED)

1-3-07
DATE



FOR REGISTRATION REGISTER OF DEEDS
 KIRBY & HARGROVE
 HARNETT COUNTY, NC
 2005 AUG 05 04:38:15 PM
 BK:2114 PG:700-702 FEE:\$17.00
 NC REV STAMP:\$90.00
 INSTRUMENT # 2005013888

HARNETT COUNTY TAX ID#

To be determined
\$5105 BY 140

NORTH CAROLINA GENERAL WARRANTY DEED

Excise Tax: \$ 90.00

Parcel Identifier No. _____ Verified by _____ County on the _____ day of _____, 20____
 By: _____

Mail/Box to: Matthew I. Van Horn, 5 West Hargett Street, Suite 310, Raleigh, NC 27601

This instrument was prepared by: Matthew I. Van Horn, 5 West Hargett Street, Suite 310, Raleigh, NC 27601

Brief description for the Index: LT 1, CONTAINING 3.32 ACRES,

THIS DEED made this 5th day of August, 2005, by and between

GRANTOR
 Jammy Scott Mason and wife,
 Sharon P. Mason

 6412 Burt Road
 Fuquay Varina, North Carolina 27526

GRANTEE
 IRS Enterprises of N.C., LLC

 #125 Robincrest Court
 Fuquay Varina, North Carolina 27526

The designation Grantor and Grantee as used herein shall include said parties, their heirs, successors, and assigns, and shall include singular, plural, masculine, feminine or neuter as required by context.

WITNESSETH, that the Grantor, for a valuable consideration paid by the Grantee, the receipt of which is hereby acknowledged, has and by these presents does grant, bargain, sell and convey unto the Grantee in fee simple, all that certain lot or parcel of land situated in the City of n/a, Hector's Creek Township, Harnett County, North Carolina and more particularly described as follows:

BEING all of Lot #1, containing 3.32 acres, more or less, as shown on that map entitled, "Property of R. A. McLamb and Associates," prepared by W. R. Lambert, RLS, and recorded in Plat Cabinet D, Slide 38-D, Harnett County Registry, to which map reference is hereby made for a more full and complete description of said real property.

The property hereinabove described was acquired by Grantor by instrument recorded in Book 1938 page 602.

A map showing the above described property is recorded in Plat Book _____ page _____

NC Bar Association Form No. L-3 © 1976, Revised © 1977, 2002

Printed by Agreement with the NC Bar Association - 1981 SoftPro Corporation, 333 E. Six Forks Rd., Raleigh, NC 27609

Harnett County Central Permitting Department

PO Box 65, Lillington, NC 27546
910-893-7525

conf #

Environmental Health New Septic Systems Test
Environmental Health Code 800

- Place "property flags" on each corner iron of lot. All property lines must be clearly flagged approximately every 50 feet between corners.
- Place "house corner flags" at each corner of where the house/manufactured home will sit. Use additional flagging to outline driveways, garages, decks, out buildings, swimming pools, etc.
- Place flags at locations as developed on site plan by Customer Service Technician and you.
- Place Environmental Health "orange" card in location that is easily viewed from road.
- If property is thickly wooded, Environmental Health requires that you clean out the undergrowth to allow the soil evaluation to be performed. Inspectors should be able to walk freely around site. *No grading of property should be done.*
- Call No Cuts to locate utility lines prior to scheduling inspection. 800-632-4949 (This is a free service)
- After preparing proposed site call the voice permitting system at 910-893-7525 and give code **800** for Environmental Health confirmation. **Please note confirmation number given at end of recording for proof of request.**
- Use Click2Gov or IVR to hear results. Once approved, proceed to Central Permitting for permits.

Environmental Health Existing Tank Inspections
Environmental Health Code 800

- Place Environmental Health "orange" card in location that is easily viewed from road. Follow above instructions for placing flags on property.
- Prepare for inspection by removing soil over door as diagram indicates. Loosen trap door cover. (Unless inspection is for a septic tank in a mobile home park)
- After preparing trapdoor call the voice permitting system at 910-893-7525 and give code **800** for Environmental Health confirmation. **Please note confirmation number given at end of recording for proof of request.**
- Use Click2Gov or IVR to hear results. Once approved, proceed to Central Permitting for remaining permits.

Health and Sanitation Inspections

- After submitting plans for food and lodging to Central Permitting, please allow approximately 7-10 working days for plan status. Use Click2Gov or IVR to hear results.
- Once **all** plans are approved, proceed to Central Permitting for remaining permits.

Fire Marshal Inspections

- After submitting plans for Fire Marshal review to Central Permitting, please allow approximately 7-10 working days for approval. Use Click2Gov or IVR to hear results. Once **all** plans are approved, proceed to Central Permitting for permits.
- Fire Marshal's letter must be placed on job site until work is completed.

Public Utilities

- Place stake with "orange" tape/name thirty feet (30) from the center of the road at the location you wish to have water tap installed.
- Allow four to six weeks after application for water/sewer taps. Call Utilities at 893-7575 for technical assistance.

Building Inspections

- After submitting plans for Building Inspections, please allow approximately 3 working days for review. Use Click2Gov or IVR to hear results. Once **all** plans are approved, proceed to Central Permitting for permits.
- For new housing/set up permits must meet E 911 / Addressing guidelines prior to scheduling final inspection.
- Use Click2Gov or IVR to hear results.

E911 Addressing

- Addressing Confirmation Code 814**
- Address numbers shall be mounted on the house, 3 inches high (5" for commercial).
- Numbers must be a contrasting color from house, must be clearly visible night and day at entrance of driveway if home is 100 ft or more from road, or if mailbox is on opposite side of road.
- Once you purchase permits and footing inspection has been approved call the voice permitting system at 910-893-7525 and give code **814** for address confirmation. This must be called in even if you have contacted E911 for verbal confirmation. Check Click2Gov for results and address.

Inspection results can be viewed online at <http://www.harnett.org/services-213.asp> then select **Click2Gov**

Applicant/Owner Signature Greg Evans Date 1.3.07