

# IMPROVEMENT PERMIT

21783

HTE 06-50014888

Be it ordained by the Harnett County Board of Health as follows: Section III, Item B. "No Person shall begin construction of any building at which a septic tank system is to be used for disposal of sewage without first obtaining a written permit from the Harnett County Health Department."

Name: (owner) Darren Jay Johnson  New Installation  Septic Tank  
Property Location: SR# 1129  Repairs  Nitrification Line  
Farrar Dairy Rd  
Subdivision \_\_\_\_\_ Lot # 4

Tax ID # \_\_\_\_\_ Quadrant # \_\_\_\_\_

Number of Bedrooms Proposed: 4 (37' x 76') Lot Size: 4.78ac

Basement with Plumbing:  Garage:

Water Supply:  Well  Public  Community

Distance From Well: 100 ft.

**Following is the minimum specifications for sewage disposal system on above captioned property. Subject to final approval.**

Type of system:  Conventional  Other 25% Reduction

Size of tank: Septic Tank: 1000 gallons Pump Tank: \_\_\_\_\_ gallons

Subsurface Drainage Field No. of ditches 7 exact length of each ditch 60 ft. width of ditches 3 ft. depth of ditches 12 in.

French Drain Required: \_\_\_\_\_ Linear feet

Date: 6-12-06

**This permit is subject to revocation if site plans or intended use change.**

Signed: James Twining BS  
Environmental Health Specialist

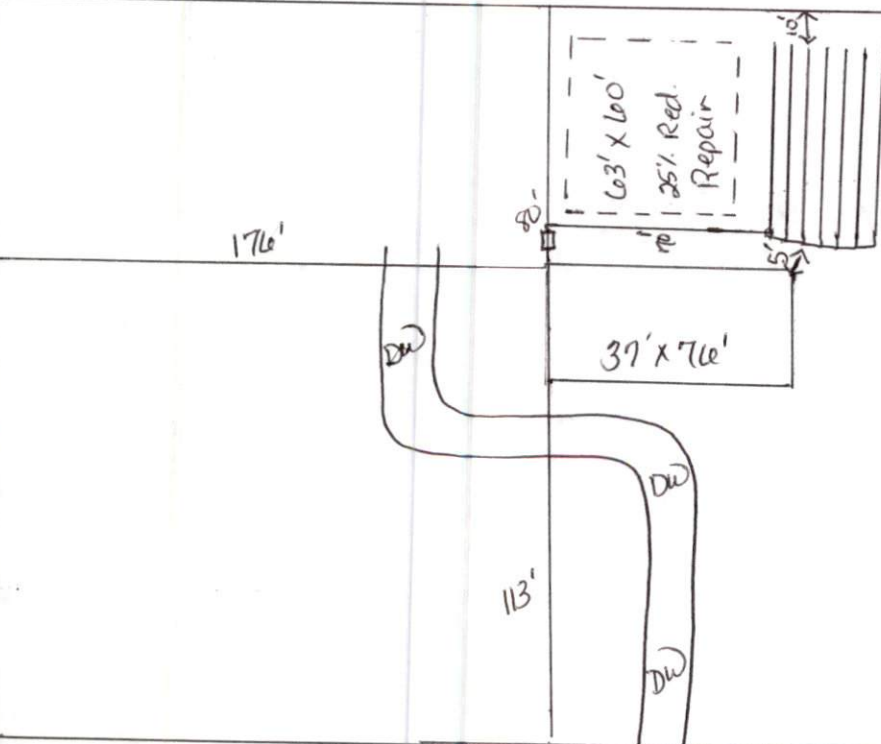

\* maintain all required setbacks.  
\* Need 6" of cover on drainfield.

HARNETT COUNTY DEPARTMENT OF PUBLIC HEALTH  
AUTHORIZATION TO CONSTRUCT

Authorization is hereby given to construct a wastewater system to the specifications described by Harnett County Department of Public Health, Improvement Permit # 21783. This authorization shall be valid for a period not to exceed five (5) years from the date of issuance.

***This authorization will be invalid if ownership, site plans, or intended use change.***

Darren Jay Johnson Name 910 892-5590 Telephone #

504 West "A" St. Erwin, NC 28339 Address

1127 Property Location SR# Farrar Dairy Rd Road Name

4 Subdivision 4 Lot # 4 (37' x 76') # Bedrooms Proposed 4.78 ac Lot Size

**TYPE OF SYSTEM**

New Installation  Repair  Septic Tank  Nitrification Lines

Conventional  Other 25% Reduction

Basement  With Plumbing  Without Plumbing

Water Supply:  Well  Public Water Supply Minimum Well Setback: 100 Ft.

Septic Tank 1000 gal Pump Chamber \_\_\_\_\_ gal

**NITRIFICATION FIELD SPECIFICATIONS**

Number of fields 1 # of lines per field 7 Length of lines 60 Ft.

Width of ditches 3 ft. Depth of ditches 12 inches

French Drain: Linear feet required \_\_\_\_\_ Depth of gravel \_\_\_\_\_

No wastewater system shall be covered or placed into use by any person until an inspection by the Harnett County Health Department has determined that the system has been installed according to the conditions of the Improvement Permit and that a valid Operations Permit has been issued.

Jamie Twilington RS Signature of Authorized Agent for Harnett County 6-12-06 Date