

HTE# 06-5-138547

IMPROVEMENT PERMIT 22374

Be it ordained by the Harnett County Board of Health as follows: Section III, Item B. "No person shall begin construction of any building at which a septic tank system is to be used for disposal of sewage without first obtaining a written permit from the Harnett County Health Department."

Name: (owner) Smith Homes Michael BASS New Installation Septic Tank Repair

Property Location: SR# 1428 LENNIE SMITH Nitrification Line Expansion

Subdivision Spring Meadow Acres Lot # 3

Tax ID# _____ Quadrant # _____

Number of Bedrooms Proposed: 3 3606PD Lot Size: 1.678

Basement with Plumbing: Garage:

Water Supply: Well Public Community

Distance From Well: 50' ft.

Following is the minimum specifications for sewage disposal system on above captioned property. Subject to final approval.

Type of system: Conventional Other 25% Reduction System

Size of tank: Septic Tank: 1000 gallons Pump Tank: _____ gallons

Subsurface No. of exact length width of depth of
Drainage Field ditches 2 ft. of each ditch 100 ft. ditches 3 ft. ditches 24" deep in.

French Drain Required: - Linear feet

This permit is subject to revocation if site plans or intended use change.

Date: 2-2-06
PERMIT EXPIRES 5 YEARS FROM ABOVE DATE

Signed: James C. Mandanfor
Environmental Health Specialist

TAKE NOTICE TO HOME SIZE

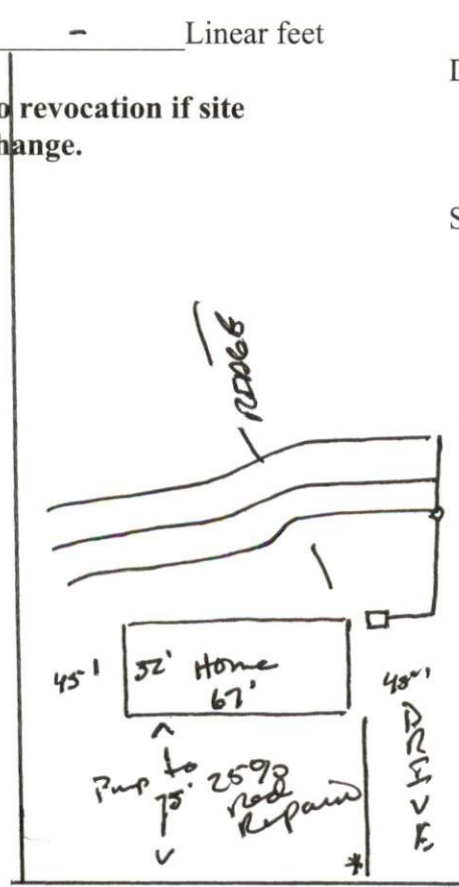

CHANGE IN HOME SIZE or smaller will require NEW Application

150m

HARNETT COUNTY DEPARTMENT OF PUBLIC HEALTH
AUTHORIZATION TO CONSTRUCT

Authorization is hereby given to construct a wastewater system to the specifications described by Harnett County Department of Public Health, Improvement Permit # 22374. This authorization shall be valid for a period not to exceed five (5) years from the date of issuance.

This authorization will be invalid if ownership, site plans, or intended use change.

CMH Homes
Michael BASS Name 919-630-0908 Telephone #

3912 Fayetteville RD Raleigh N.C. 27603 Address

1428 Property Location SR# Lennoxville Rd Road Name

Spring Meadows Acres 3 Subdivision 3 Lot # 3 360 GPD # Bedrooms Proposed 1.678 Lot Size

TYPE OF SYSTEM

- New Installation Repair Septic Tank Nitrification Lines
- Conventional Other 25' round syst
- Basement With Plumbing Without Plumbing

Water Supply: Well Public Water Supply Minimum Well Setback: 50 Ft.

Septic Tank 1000 gal Pump Chamber _____ gal

NITRIFICATION FIELD SPECIFICATIONS

Number of fields 2 # of lines per field 3 Length of lines 100 Ft.

Width of ditches 3 ft. Depth of ditches 21-26 inches

French Drain: Linear feet required — Depth of gravel —

No wastewater system shall be covered or placed into use by any person until an inspection by the Harnett County Health Department has determined that the system has been installed according to the conditions of the Improvement Permit and that a valid Operations Permit has been issued.

James E. Montague Signature of Authorized Agent for Harnett County 1-2-06 Date