

HTE# 05-50013273R

IMPROVEMENT PERMIT 22455

Be it ordained by the Harnett County Board of Health as follows: Section III, Item B. "No person shall begin construction of any building at which a septic tank system is to be used for disposal of sewage without first obtaining a written permit from the Harnett County Health Department."

Name: (owner) SHERNITA KELLY New Installation Septic Tank Repair

Property Location: SR# 1244 MOORES CIPPEL RD Nitrification Line Expansion

Subdivision Spring Hill S/D Lot # 2

Tax ID# _____ Quadrant # _____

Number of Bedrooms Proposed: 4 (480 sqd) Lot Size: 942

Basement with Plumbing: Garage:

Water Supply: Well Public Community

Distance From Well: 100 ft.

Following is the minimum specifications for sewage disposal system on above captioned property. Subject to final approval.

Type of system: Conventional Other _____

Size of tank: Septic Tank: 1000 gallons Pump Tank: _____ gallons

Subsurface Drainage Field No. of ditches 1 exact length of each ditch 460 width of ditches 3 depth of ditches 18-20 in.

French Drain Required: _____ Linear feet

Date: 12/8/05
PERMIT EXPIRES 5 YEARS FROM ABOVE DATE

This permit is subject to revocation if site plans or intended use change.

Signed: [Signature] Environmental Health Specialist

* MAINTAIN ALL SETBACKS

* CALL WITH ANY QUESTIONS PRIOR TO INSTALLATION

VOID

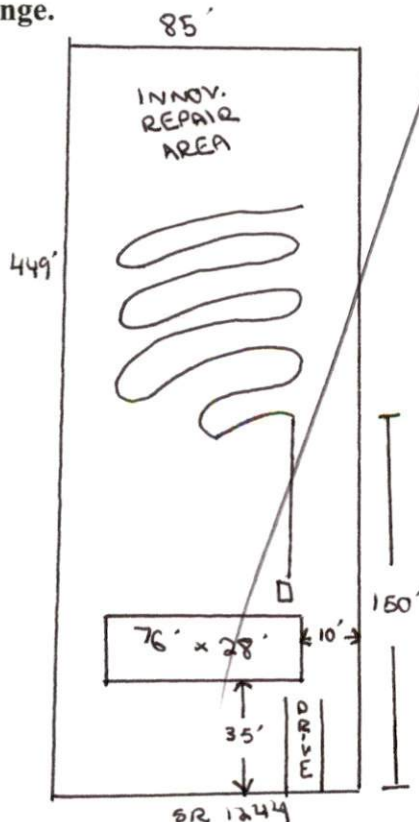

HARNETT COUNTY DEPARTMENT OF PUBLIC HEALTH
AUTHORIZATION TO CONSTRUCT

Authorization is hereby given to construct a wastewater system to the specifications described by Harnett County Department of Public Health, Improvement Permit # 22455. This authorization shall be valid for a period not to exceed five (5) years from the date of issuance. *This authorization will be invalid if ownership, site plans, or intended use change.*

SHERNKA KELLY 919-630-0408
Name Telephone #

413 EAST JACKSON BLVD ERWIN NC 28339
Address

1244 MOORES CHAPEL RD
Property Location SR# Road Name

SPRING HILL 2 4 (480 sq ft) .942 ac
Subdivision Lot # # Bedrooms Proposed Lot Size

TYPE OF SYSTEM

New Installation [] Repair Septic Tank Nitrification Lines

Conventional [] Other _____

[] Basement [] With Plumbing [] Without Plumbing

Water Supply: [] Well Public Water Supply Minimum Well Setback: _____ Ft.

Septic Tank 1000 gal Pump Chamber _____ gal

NITRIFICATION FIELD SPECIFICATIONS

Number of fields 1 # of lines per field 460 Length of lines 3 Ft.

Width of ditches 18-20 ft. Depth of ditches 18-20 inches

French Drain: Linear feet required _____ Depth of gravel _____

No wastewater system shall be covered or placed into use by any person until an inspection by the Harnett County Health Department has determined that the system has been installed according to the conditions of the Improvement Permit and that a valid Operations Permit has been issued.

[Signature] RS
Signature of Authorized Agent for Harnett County

12/8/05
Date