

Hill

0550013166

Application for Building and Trade Permit

Owner's Name: Freddie Hill Date: 10-29-07
Address: 141 Walter Ln, Cameron Phone: 499-5454
Directions to job site: _____

Subdivision: Mary Grant Lot: 6
Construction Type: (Please Check) Building Use: (Please Check)
 New Residential
 Renovation Modular
 Addition Commercial
 Moved House Multi-Family
 Other

Description of Proposed Work: Off Frame
Total Project Cost: 112,977⁰⁰

Building Permit Information

Heated SF 2128 Crawl Space
Unheated SF Slab ()
Homes By Vanderbuilt
Building Contractor's Company Name 919-718-2760
3320 Jefferson Davis Hwy, Sanford Telephone 43964
Address [Signature] License # _____
Signature of Officer(s) of Corporation

Electrical Permit Information

Description of Work 200 amp service panel Electrical Cost \$ 900⁰⁰
TS Pole: Yes () No () Underground () Overhead ()
Permanent Service: Underground Overhead () Service Size: 200 Amps
Furr Electric Telephone 910-690-6270
Electrical Contractor's Company Name 1820 McGil Rd Uss NC Telephone 24249-L
Address [Signature] License # _____
Signature of Officer(s) of Corporation

Mechanical Permit Information

Description of Work Heat pump & duct install
Number of Units 1 Type System Heat Pump Mechanical Cost \$ 6,500
Lewell Heat & A/C Telephone 919-777-0633
Mechanical Contractor's Company Name 1540 Truway Rd Sanford Telephone 20311
Address [Signature] License # _____
Signature of Officer(s) of Corporation

Plumbing Permit Information

Description of Work DWV & water hook gas for mobile
Number of Baths 2 Plumbing Cost \$ 2,200
Malcolm David McCracken TCC 919-353-1121
Plumbing Contractor's Company Name 529 Bannockburn Sanford Telephone 29173
Address [Signature] License # _____
Signature of Officer(s) of Corporation

Insulation Permit Information

Residential () Other () Not Required ()
Insulation Contractor's Company Name _____ Address _____ Telephone _____

Sprinkler System Information

Sprinkler Contractor's Company Name

Telephone

Contact Person

Address

License #

Signature of Officer(s) of Corporation

Fire Alarm System Information

Fire Alarm Contractor's Company Name

Telephone

Contact Person

Address

License #

Signature of Officer(s) of Corporation

Driveway Access

NC Department of Transportation Driveway Access/Permit? Yes ___ No ___

I hereby certify that I have the authority to make necessary application, that the application is correct and that the construction will conform to the regulations in the Building, Electrical, Plumbing and Mechanical codes, and the Harnett County Zoning Ordinance. I state the information on the above contractors is correct as known to me and if any changes occur including listed contractors, site plan, building and trade plans, Environmental Health permit changes or proposed use changes, I certify it is my responsibility to notify the Harnett County Central Permitting Division of any and all changes.

Cliff Wright, Permits

Signature of Owner/Contractor/Officer(s) of Corporation

10-29-07

Date

Affidavit for Worker's Compensation
N.C.G.S. 87-14

The undersigned applicant for Building Permit # _____ being the:

- _____ Contractor
- _____ Owner
- _____ Officer/Agent of the Contractor or Owner

Do hereby confirm under penalties of perjury that the person(s), firm(s) or corporation(s) performing the work set forth in the permit:

- _____ Has/have three (3) or more employees and has/have obtained workers' compensation insurance to cover them.
- _____ Has/have one (1) or more subcontractors(s) and has/have obtained workers' compensation insurance to cover them.
- _____ Has/have one (1) or more subcontractors(s) who has/have their own policy of workers' compensation insurance covering themselves.
- _____ Has/have not more than two (2) employees and no subcontractors.

While working on the project for which this permit is sought it is understood that the Central Permitting Department issuing the permit may require certificates of coverage of worker's compensation insurance prior to issuance of the permit and at any time during the permitted work from any person, firm or corporation carrying out the work.

Firm Name: Homes By Vanderbilt
By/Title: Cliff W. [Signature] Permits
Date: 10-29-07

ROCKBRIDGE SERIES

#7

MODEL NO. MAPLE - RB501A 28' X 76' - APPROX. 2,128 SQ. FT

CUSTOMER'S NAME Freddie Hill

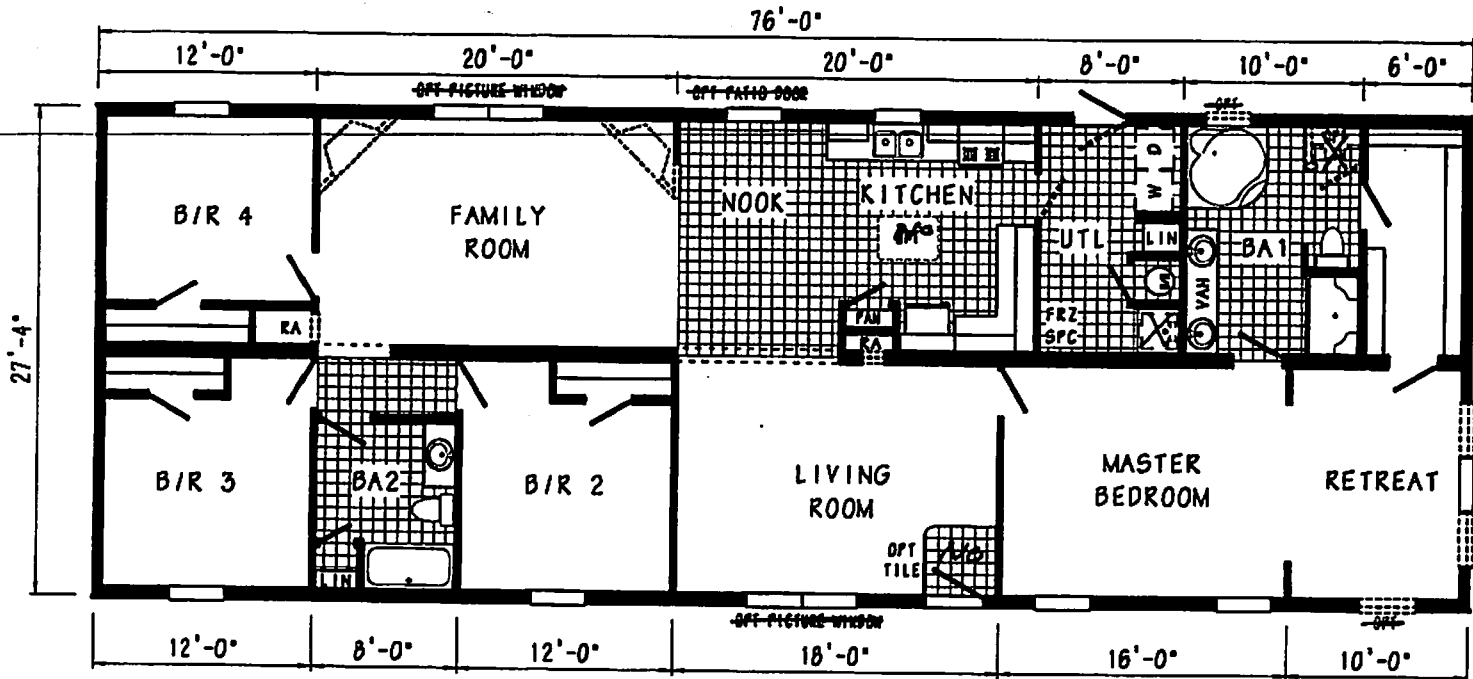

Anchorage II

FLOOR COVERING: CARPET Cappuccino

TILE LG-111

FOYER TILE NA

MASTER BATH: VANITY TOP Tumbled Rosa

CABINETS

BATH #2: VANITY TOP " "

CABINETS

KITCHEN: COUNTERTOPS Sedona Trail

CABINETS flat panel oak

UTILITY: COUNTERTOPS NA

CABINETS

OUTSIDE: SIDING Country Beige SHUTTERS Brown 12"

SHINGLES Heatherland Brown

OPTIONAL BRICK COLOR Std. black

SHEET ROCK WALLS ARE ALL PAINTED WHITE.

THE DECOR SELECTIONS SHOWN ABOVE ARE CORRECT.

Freddie Hill
SIGNATURE

Florian Hill
SIGNATURE

10-3-07
DATE

ALL ROOM SIZES STATED ON FLOOR PRINTS ARE APPROXIMATE. IF PRECISE SIZES ARE NEEDED, CONSULT ENGINEERING PRINTS.

**ROCKBRIDGE SERIES
OFF FRAME MODULAR
MAPLE - RB501A**

#7

MEETS NC RESIDENTIAL BUILDING CODE	
MODEL	BASE PRICE
MAPLE - RB 501A	\$98,998.00
BLOCK FOUNDATION UP TO 36"	INCLUDED
2 X 6 EXTERIOR WALLS WITH HOUSE WRAP	INCLUDED
30 YR. ARCHITECTURAL SHINGLES	INCLUDED
#700 VINYL THERMO PANE WINDOWS - NO GRIDS	INCLUDED
SMOOTH SHEET ROCK THROUGHOUT - EXCEPT CLOSETS	INCLUDED
DELIVERY IN OUR SERVICE AREA	INCLUDED
SET UP TO INCLUDE CRANE COSTS AND TRIM OF HOME	INCLUDED
9 LITE STEEL REAR DOOR WITH STORM	INCLUDED
PERIMETER VENTS - WHERE APPLICABLE	INCLUDED
BRUSHED NICKEL LIGHTS & KNOBS	INCLUDED
OSB SHEATHING	INCLUDED
FLAT PANEL OAK ARCHED CABINET DOOR	INCLUDED
MOULDING PACKAGE F	INCLUDED
6 PANEL INTERIOR DOORS	INCLUDED
MINI BLINDS & CEILING FANS FOR DISPLAY ONLY	

DATE OF QUOTE: 9-29-07
ASSOCIATE: George

CUSTOMER: Freddie Hill
141 Walter Ln.
ADDRESS: Cameron, NC 28326
CITY STATE ZIP CODE
COUNTY HOME BEING DELIVERED TO: Harnett
HOME PHONE # 499-5454
WORK PHONE # _____
MOBILE PHONE #: 910-224-8589
E-MAIL ADDRESS # _____

STANDARD FEATURES

EXTERIOR	INTERIOR
STEEL FRONT DOOR	PUSH CARPET REBOND PAD
9 LITE STEEL REAR DOOR W/ STORM	WIRE SHELVING IN CLOSETS & UTILITY ROOM
12" SHUTTERS - FRONT OF HOME	1/2" SHEETROCK PRIMED W/ FLAT WALL PAINT
#700 VINYL THERMO PANE WINDOWS	DRAPES NOT INCLUDED
5/12 ROOF TRUSSES 24" O.C.	
12" EAVES	

CONSTRUCTION
OSB FLOORING
2 X 4 INTERIOR WALL
2 X 6 EXTERIOR WALLS 24" O.C.
40 GALLON WATER HEATER
2 X 10 FLOOR JOISTS
HOUSE WRAP

KITCHEN
30" ELECTRIC RANGE
17 CF FROST FREE REFRIGERATOR
STAINLESS STEEL KITCHEN SINK
LAMINATE BACK SPLASH IN KITCHEN
HIDDEN CABINET HINGES
SELF-EDGE COUNTER TOPS
DRAWER OVER DOOR BASE CABINETS
CROWN MOULDING ON OVERHEAD CABINETS
ADJUSTABLE SHELVES IN OVERHEAD CABINETS

BATHS
LAMINATED BACK SPLASH IN BATHS
CHINA LAVS ALL BATHS
ONE-PIECE TUB/SHOWERS
33" HIGH VANITIES - BATHS
SELF-EDGE COUNTER TOPS

ITEMS NOT INCLUDED - EXCEPT AS OPTIONS OR ALLOWANCES

- THE COST OF PERMITS
- IF THE HOME HAS TO GO OVER 36" HIGH, THERE WILL BE AN ADDITIONAL OVER HEIGHT CHARGE PLUS AN ENGINEERING CHARGE
- STEPS, DECKS OR PORCHES
- LOT CLEARING OR GRADING
- BACKFILLING, DRAINS, GUTTERS
- ALL HOMES ARE SOLD UNFURNISHED, NO DRAPERIES
- ELECTRICAL HOOK UP/ PLUMBING HOOK UP
- CUSTOMER MUST CLEAR ACCESS FOR CRANE

LAND INFORMATION
SIZE: _____ APPROX VALUE: _____
HAS LAND BEEN PERKED: YES ___ NO ___
IS LAND DEED IN NAME: YES ___ NO ___

ROCKBRIDGE SERIES
5/12 ROOF PITCH WITH 8' FLAT CEILINGS INCLUDED

ADDITIONAL OPTIONS ADDED TO MODEL:

7/12 ROOF PITCH	1,995.00
7/12 DORMER	999.00
RAISED PANEL OAK CABINETS	469.00
50 GALLON WATER HEATER	100.00
FOYER VINYL	45.00
SLIDING GLASS DOOR TLO 1 WINDOW	895.00
30 X 38 WINDOW OVER TUB #800	275.00
11 - #800 WINDOWS WITH GRIDS - \$60 EACH	660.00
UTILITY SINK WITH CABINET	250.00
30 X 40 ISLAND	300.00
LINEN CLOSET MASTER BATH	195.00
SUBTOTAL OF ABOVE OPTIONS	\$105,228.00

Whirlpool Tub 995

HEATING AND AIR CONDITIONING OPTIONS
TRANE 13' SEER HEAT PUMP WITH AIR HANDLER & DUCT WO ~~6,250.00~~
By customer hires

H.B.V. SITE OPTIONS DESIRED
HBV PLUMBING PACKAGE By customer hires ~~2,500.00~~
HBV ELECTRICAL PACKAGE ~~950.00~~

ALLOWANCES
FUNDS SET ASIDE FOR CUSTOMER CONTRACTED HOME OR SITE IMPROVEMENTS By customer hires

discount: cash up front <1000
~~#98,990~~
#98,990

OK - Per RICK 10-3-07
MISCELLANEOUS ALLOWANCES - TO BE USED FOR **\$3,000.00**
(POSSIBLE OVER HEIGHT FOUNDATION, PERMITS, DECKS, ETC.)
1010

ESTIMATED CLOSING COSTS
TOTAL OF ABOVE ITEMS \$100,000

AMOUNT FINANCED
** HOME MAY HAVE MODERATE OVERHANG ON FOUNDATION
CUSTOMER SIGNATURE: _____

DATE _____
DATE _____

MODULAR

Plan Box Number B-2

Job Name HILL

Date: 10-29-07

Required Inspections for SFA/SFD

05-

Appl. # ~~500~~ 50013166
Valuation \$134,951
Sq. Feet 2077

Sequence

(MODULAR)

- | | | |
|--------|-------------------------------------|-----------------------------|
| 10 | <input checked="" type="checkbox"/> | R* Bldg. Footing |
| 10-30 | <input checked="" type="checkbox"/> | R* Elec. Temp Service Pole |
| 20 | <input checked="" type="checkbox"/> | R* Building Foundation |
| 20 | <input type="checkbox"/> | Address Confirmation |
| 30-999 | <input type="checkbox"/> | Open Floor |
| 30-999 | <input type="checkbox"/> | R* Bldg. Slab Insp. |
| 30-999 | <input type="checkbox"/> | R* Elec. Under Slab |
| 30-999 | <input type="checkbox"/> | R* Plumb. Under Slab |
| 40 | <input type="checkbox"/> | Four Trade Rough In |
| 40 | <input type="checkbox"/> | Four Trade Rough In > 2500 |
| 40 | <input type="checkbox"/> | Three Trade Rough In |
| 40 | <input type="checkbox"/> | Three Trade Rough In > 2500 |
| 40 | <input checked="" type="checkbox"/> | Two Trade Rough In |
| 40 | <input type="checkbox"/> | Two Trade Rough In > 2500 |
| 40 | <input type="checkbox"/> | One Trade Rough In |
| 40 | <input type="checkbox"/> | One Trade Rough In > 2500 |
| 50 | <input type="checkbox"/> | R* Insulation |
| 60 | <input type="checkbox"/> | Four Trade Final |
| 60 | <input type="checkbox"/> | Four Trade Final > 2500 |
| 60 | <input type="checkbox"/> | Three Trade Final |
| 60 | <input type="checkbox"/> | Three Trade Final > 2500 |
| 60 | <input type="checkbox"/> | Two Trade Final |
| 60 | <input checked="" type="checkbox"/> | Two Trade Final > 2500 |
| 60 | <input type="checkbox"/> | One Trade Final |
| 60 | <input type="checkbox"/> | One Trade Final > 2500 |
| 999 | <input checked="" type="checkbox"/> | Envir. Operations Permit |