

HTE# 05-5-13014

IMPROVEMENT PERMIT 22256

Be it ordained by the Harnett County Board of Health as follows: Section III, Item B. "No person shall begin construction of any building at which a septic tank system is to be used for disposal of sewage without first obtaining a written permit from the Harnett County Health Department."

Name: (owner) Vaw Stephen Murray New Installation Septic Tank Repair

Property Location: SR# 1437 Ballard Rd. Nitrification Line Expansion

Subdivision Strawberry Fields Lot # 4

Tax ID# _____ Quadrant # _____

Number of Bedrooms Proposed: 3 (360 ypd) Lot Size: .71 Ac

Basement with Plumbing: Garage:

Water Supply: Well Public Community

Distance From Well: 50 min ft.

Following is the minimum specifications for sewage disposal system on above captioned property. Subject to final approval.

Type of system: Conventional Other 25% Reduct. on System

Size of tank: Septic Tank: 1000 gallons Pump Tank: _____ gallons

Subsurface No. of exact length width of depth of
Drainage Field ditches 2 ft. of each ditch 150 ft. ditches 3 ft. ditches 18-24 in.

French Drain Required: _____ Linear feet

Date: 10/3/2005

This permit is subject to revocation if site plans or intended use change.

PERMIT EXPIRES 5 YEARS FROM ABOVE DATE

Signed: Bryan McSwiney
Environmental Health Specialist

*Maintain all setbacks
*Run ditches on contour

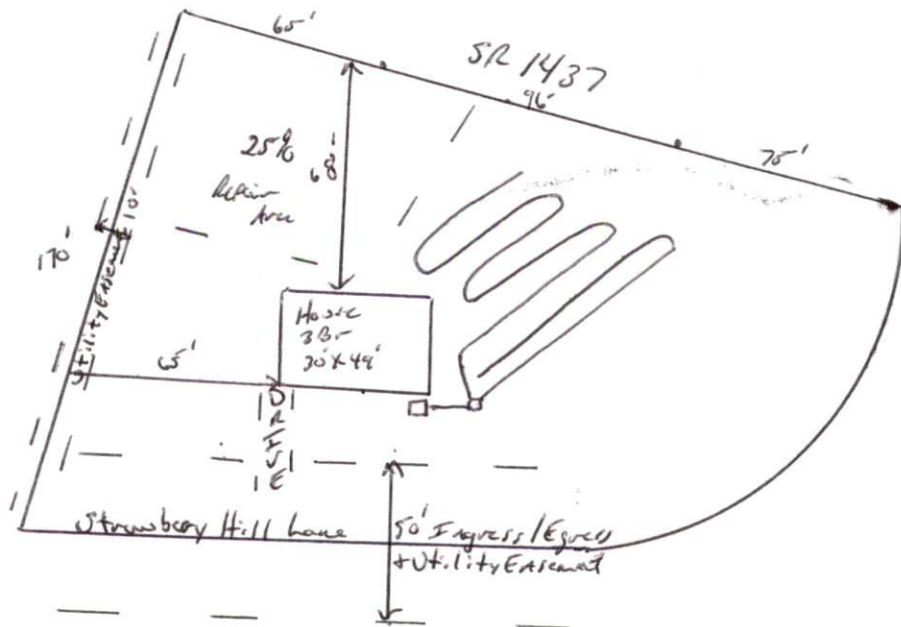

HARNETT COUNTY DEPARTMENT OF PUBLIC HEALTH
AUTHORIZATION TO CONSTRUCT

Authorization is hereby given to construct a wastewater system to the specifications described by Harnett County Department of Public Health, Improvement Permit # 22256. This authorization shall be valid for a period not to exceed five (5) years from the date of issuance. ***This authorization will be invalid if ownership, site plans, or intended use change.***

Van Stephen Murray Name 919-557-1389 Telephone #

5317 Shadow Valley Rd. Holly Springs, N.C. 27540 Address

1437 Property Location SR# Ballard Road Name

Strawberry Fields Subdivision 4 Lot # 3 (360 gpd) # Bedrooms Proposed .71Ac Lot Size

TYPE OF SYSTEM

New Installation Repair Septic Tank Nitrification Lines

Conventional Other 25% Reduction System

Basement With Plumbing Without Plumbing

Water Supply: Well Public Water Supply Minimum Well Setback: 50 Ft.

Septic Tank 1000 gal Pump Chamber _____ gal

NITRIFICATION FIELD SPECIFICATIONS

Number of fields 1 # of lines per field 2 Length of lines 150 Ft.

Width of ditches 3 ft. Depth of ditches 18-24 inches

French Drain: Linear feet required _____ Depth of gravel _____

No wastewater system shall be covered or placed into use by any person until an inspection by the Harnett County Health Department has determined that the system has been installed according to the conditions of the Improvement Permit and that a valid Operations Permit has been issued.

[Signature]
Signature of Authorized Agent for Harnett County

10/3/2005
Date