

HTE# 05-50012715R

# IMPROVEMENT PERMIT 22733

Be it ordained by the Harnett County Board of Health as follows: Section III, Item B. "No person shall begin construction of any building at which a septic tank system is to be used for disposal of sewage without first obtaining a written permit from the Harnett County Health Department."

Name: (owner) Accent Design Bldg LLC New Installation  Septic Tank  Repair

Property Location: SR# 1116 Nitrification Line  Expansion

Subdivision Colonial Hills Lot # 25

Tax ID# \_\_\_\_\_ Quadrant # \_\_\_\_\_

Number of Bedrooms Proposed: 3 (33x60) 360 sqd Lot Size: 2.308 AC

Basement with Plumbing:  Garage:

Water Supply:  Well  Public  Community

Distance From Well: 50 ft.

Following is the minimum specifications for sewage disposal system on above captioned property. Subject to final approval.

Type of system:  Conventional  Other Pump to 25% Reduction system

Size of tank: Septic Tank: 1000 gallons Pump Tank: 1000 gallons

Subsurface Drainage Field No. of ditches 4 ft. exact length of each ditch 75 ft. width of ditches 3 ft. depth of ditches 18 in. <sup>max</sup>

French Drain Required: \_\_\_\_\_ Linear feet of 25% Reduction system

Date: 08-25-05  
PERMIT EXPIRES 5 YEARS FROM ABOVE DATE

This permit is subject to revocation if site plans or intended use change.

90x90 AREA for Septic system & partial repair

Signed: Joe Waters  
Environmental Health Specialist 571

Rd  
mi  
to  
SR  
1116  
↓

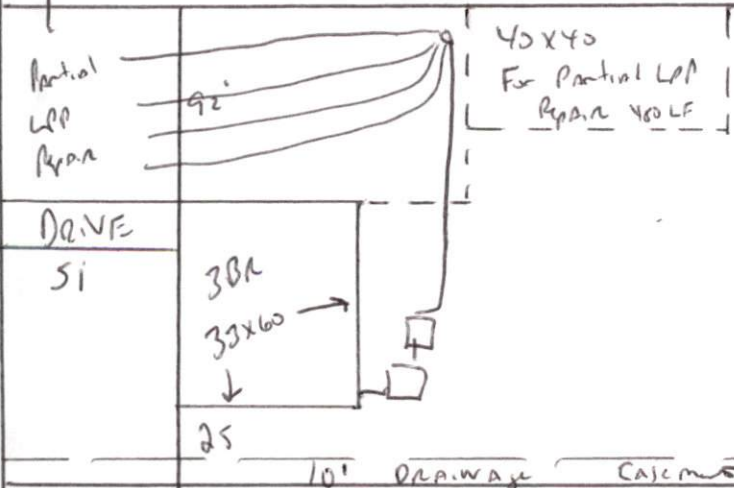

Meet onsite for Final layout - maintain All set Backs 564

HARNETT COUNTY DEPARTMENT OF PUBLIC HEALTH  
AUTHORIZATION TO CONSTRUCT

Authorization is hereby given to construct a wastewater system to the specifications described by Harnett County Department of Public Health, Improvement Permit # 22733. This authorization shall be valid for a period not to exceed five (5) years from the date of issuance. *This authorization will be invalid if ownership, site plans, or intended use change.*

Accent Design Build  
Name \_\_\_\_\_ Telephone # \_\_\_\_\_

Address \_\_\_\_\_  
1116

Property Location SR# \_\_\_\_\_ Road Name \_\_\_\_\_  
Colonial Hills 25 3(3)x60 360 sqd 2.308 AC  
Subdivision Lot # # Bedrooms Proposed Lot Size

**TYPE OF SYSTEM**

- New Installation [ ] Repair
- Septic Tank  Nitrification Lines
- [ ] Conventional  Other Pump To 25% Reduction SYSTEM
- [ ] Basement [ ] With Plumbing [ ] Without Plumbing

Water Supply: [ ] Well  Public Water Supply Minimum Well Setback: 50 Ft.  
Septic Tank 1000 gal Pump Chamber 1000 gal

**NITRIFICATION FIELD SPECIFICATIONS**

Number of fields 1 # of lines per field 4 Length of lines 75 Ft.  
Width of ditches 3 ft. Depth of ditches 18 inches of 25% Reduction SYSTEM  
French Drain: Linear feet required \_\_\_\_\_ Depth of gravel \_\_\_\_\_

No wastewater system shall be covered or placed into use by any person until an inspection by the Harnett County Health Department has determined that the system has been installed according to the conditions of the Improvement Permit and that a valid Operations Permit has been issued.

Joe West RS \_\_\_\_\_  
Signature of Authorized Agent for Harnett County Date 08-25-05