

Initial Application Date: 6-2-05

Application # 05-50012283
963504

COUNTY OF HARNETT LAND USE APPLICATION

Central Permitting 102 E. Front Street, Lillington, NC 27546 Phone: (910) 893-4759 Fax: (910) 893-2793

LANDOWNER: BARRY PATTERSON REACTY Mailing Address: 1254 Post office Road

City: SANFORD State: NC Zip: 27330 Phone #: 919 776 4241

APPLICANT: CKOO CKOO HOMES Mailing Address: 4209 BRAGE ROAD

City: FAYETTEVILLE State: NC Zip: 28303 Phone #: 919 860 8787

PROPERTY LOCATION: SR #: 1103 SR Name: CYPRESS ROAD

Address: Lot #3 CYPRESS RD CAMERON N.C.

Parcel: 09 9545 6051 02 PIN: _____

Zoning: RA20P Subdivision: Barry Patterson Lot #: 3 Lot Size: 1.031 AC

Flood Plain: X Panel: 150 Watershed: III Deed Book/Page: OTF Plat Book/Page: 2004-584

DIRECTIONS TO THE PROPERTY FROM LILLINGTON: HWY 27W FOR 20 MILES HWY 27W FOR 4 MILES T/C ON LINE RD FOR 1 MILE T/C ON CYPRESS RD FOR APPROX 3 MILES TO 3RD LOT ON LEFT

PROPOSED USE: MODULAR

Sg. Family Dwelling (Size 42x64) # of Bedrooms 3 # Baths 2 Basement (w/wo bath) - Garage - Deck -

Multi-Family Dwelling No. Units _____ No. Bedrooms/Unit _____

Manufactured Home (Size ___ x ___) # of Bedrooms _____ Garage _____ Deck _____

Number of persons per household 2

Business Sq. Ft. Retail Space _____ Type _____

Industry Sq. Ft. _____ Type _____

Church Seating Capacity _____ Kitchen _____

Home Occupation (Size ___ x ___) # Rooms _____ Use _____

Additional Information: _____

Accessory Building (Size ___ x ___) Use _____

Addition to Existing Building (Size ___ x ___) Use _____

Other _____

Additional Information: _____

Water Supply: County Well (No. dwellings _____) Other Environmental Health Site Visit Date: _____

Sewage Supply: New Septic Tank Existing Septic Tank County Sewer Other

Erosion & Sedimentation Control Plan Required? YES (NO)

Property owner of this tract of land own land that contains a manufactured home w/in five hundred feet (500') of tract listed above? YES NO

Structures on this tract of land: Single family dwellings 1 MOD Manufactured homes _____ Other (specify) _____

Required Residential Property Line Setbacks:	Minimum	Actual
Front	<u>35</u>	<u>35</u>
Rear	<u>25</u>	<u>45</u>
Side	<u>10</u>	<u>15</u>
Corner	<u>20</u>	<u>-</u>
Nearest Building	<u>10</u>	<u>-</u>

If permits are granted I agree to conform to all ordinances and the laws of the State of North Carolina regulating such work and the specifications or plans submitted. I hereby swear that the foregoing statements are accurate and correct to the best of my knowledge.

[Signature]

5-31-05

Signature of Owner or Owner's Agent

Date

This application expires 6 months from the initial date if no permits have been issued

A RECORDED SURVEY PLAT AND RECORDED DEED ARE REQUIRED WHEN APPLYING FOR A LAND USE APPLICATION

06/04
6/16/05

1=60

SITE PLAN APPROVAL

DISTRICT RA20B USE Modular

#BEDROOMS 3

6.205

JB
ZONING ADMINISTRATOR

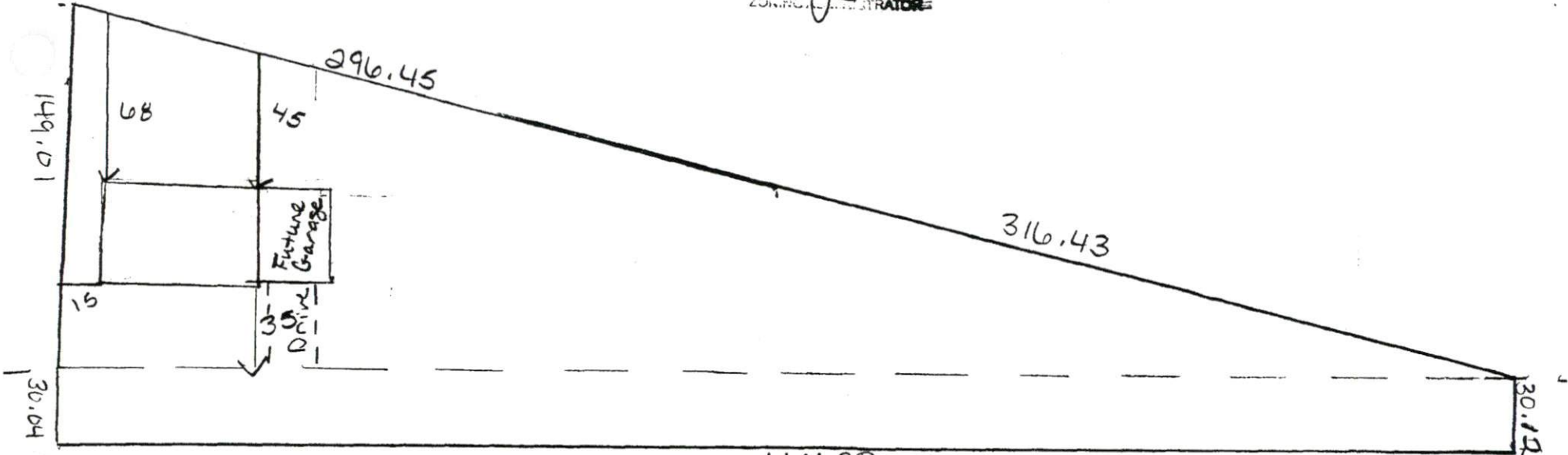

Cypress Rd ^{41'700} SR # 1103

Harnett County Planning Department

PO Box 65, Lillington, NC 27546
910-893-7527

Environmental Health New Septic Systems Test
Environmental Health Code 800

- Place "property flags" in each corner of lot. All property lines must be clearly flagged approximately every 50 feet between corners.
- Place "house corner flags" at each corner of where the house/manufactured home will sit. Use additional flagging to outline driveways, garages, decks, out buildings, swimming pools, etc.
- Place flags at locations as developed on site plan by Customer Service Technician and you.
- Place Environmental Health "orange" card in location that is easily viewed from road.
- If property is thickly wooded, Environmental Health requires that you clean out the undergrowth to allow the soil evaluation to be performed. Inspectors should be able to walk freely around site. *No grading of property should be done.*
- After preparing proposed site call the voice permitting system at 910-893-7527 and give code **800** for Environmental Health confirmation. Please note confirmation number given at end of recording for proof of request.
- To hear results, call IVR again. Once approved, proceed to Central Permitting for permits

Environmental Health Existing Tank Inspections
Environmental Health Code 800

- Place Environmental Health "orange" card in location that is easily viewed from road.
- Prepare for inspection by removing soil over door as diagram indicates. Loosen trap door cover. (Unless inspection is for a septic tank in a mobile home park)
- After preparing trapdoor call the voice permitting system at 910-893-7527 and give code **800** for Environmental Health confirmation. Please note confirmation number given at end of recording for proof of request.
- To hear results, call IVR again. Once approved, proceed to Central Permitting for permits

Health and Sanitation Inspections
Health and Sanitation Plan Review 826

- After submitting plans for food and lodging, call the voice permitting system at 910-893-7527 and give code **826** for Health and Sanitation confirmation. Please note confirmation number given at end of recording for proof of request.
- To hear results, call IVR again. Once approved, proceed to Central Permitting for permits

Fire Marshal Inspections
Fire Marshall Plan Review Code 804

- Call the voice permitting system at 910-893-7527 and give code **804** for plan review. Please note confirmation number given at end of recording for proof of request.
- To hear results, call IVR again. Once approved, proceed to Central Permitting for permits
- Pick up Fire Marshal's letter and place on job site until work is completed.

Public Utilities

- Place stake with "orange" tape/name thirty feet (30) from the center of the road at the location you wish to have water tap installed.
- Allow four to six weeks after application for water/sewer taps. Call Utilities at 893-7575 for technical assistance.

Building Inspections

- Call the voice permitting system at 910-893-7527 to schedule inspections. Please note confirmation number given at end of recording for proof of request.
- For new housing/set up permits must meet E 911 / Addressing guidelines prior to calling for final inspection.
- To hear results of inspections, call IVR again.

E911 Addressing
Addressing Confirmation Code 814

- Address numbers shall be mounted on the house, 3 inches high (5" for commercial).
- Numbers must be a contrasting color from house, must be clearly visible night and day at entrance of driveway if home is 100 ft or more from road, or if mailbox is on opposite side of road.
- Once you purchase permits and footing inspection has been approved call the voice permitting system at 910-893-7527 and give code **814** for address confirmation. This must be called in even if you have contacted E911 for verbal confirmation

Applicant Signature:  Date: 6-2-05