

HTE 0550011775

HARNETT COUNTY HEALTH DEPARTMENT

IMPROVEMENT PERMIT

21834

Be it ordained by the Harnett County Board of Health as follows: Section III, Item B. "No Person shall begin construction of any building at which a septic tank system is to be used for disposal of sewage without first obtaining a written permit from the Harnett County Health Department."

Name: (owner) Eddie Taylor
Property Location: SR# Cypress Creek Farm Rd
New Installation, Septic Tank, Repairs, Nitrification Line

Subdivision Cypress Creek Farms Lot # Tract # 1

Tax ID # Quadrant #

Number of Bedrooms Proposed: 3 (23x68) Lot Size: 10.050 ac

Basement with Plumbing: Garage:

Water Supply: Well, Public, Community

Distance From Well: 50 ft.

Following is the minimum specifications for sewage disposal system on above captioned property. Subject to final approval.

Type of system: Conventional, Other Ultra shallow

Size of tank: Septic Tank: 1000 gallons Pump Tank:

Subsurface Drainage Field: No. of ditches 5 exact length of each ditch 100 ft. width of ditches 3 ft. depth of ditches 12 in.

French Drain Required: Linear feet

Date: 4-2-05 Must bring in 8 to 12" of approved cover

This permit is subject to revocation if site plans or intended use change. Wood Line is Property Line - Orange paint

Signed: J. W. [Signature] Environmental Health Specialist

5 Lines are Flagged at 150' each Meet on site Before Installing MAINTAIN ALL Jet Backs 133' Must Bring In 8 to 12" of approved cover STUB out Plumbing shallow Do not DRIVE or park on septic SYSTEM 535'

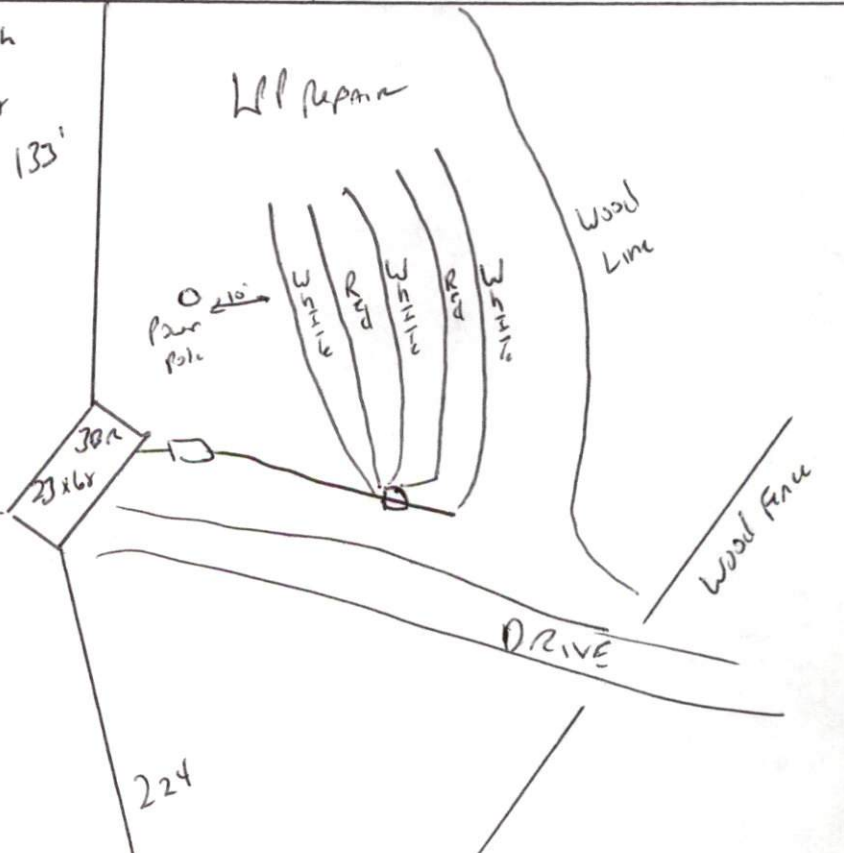

224

DEPARTMENT OF PUBLIC HEALTH
AUTHORIZATION TO CONSTRUCT

Authorization is hereby given to construct a wastewater system to the specifications described by Harnett County Department of Public Health, Improvement Permit # 21834. This authorization shall be valid for a period not to exceed five (5) years from the date of issuance. *This authorization will be invalid if ownership, site plans, or intended use change.*

Eddie Taylor

Name _____ Telephone # _____

Address _____

Cypress Crk Farm Rd

Property Location SR# _____ Road Name _____

Cypress Crk Farm Tract 1 3(23x68) 10.05 Ac
Subdivision Lot # # Bedrooms Proposed Lot Size

TYPE OF SYSTEM

- New Installation [] Repair Septic Tank Nitrification Lines
[] Conventional Other ultra-shallow
[] Basement [] With Plumbing [] Without Plumbing

Water Supply: [] Well Public Water Supply Minimum Well Setback: 50 Ft.

Septic Tank 1000 gal Pump Chamber _____ gal

NITRIFICATION FIELD SPECIFICATIONS

Number of fields 1 # of lines per field 5 Length of lines 100 Ft.

Width of ditches 3 ft. Depth of ditches 12 inches MAX

French Drain: Linear feet required _____ Depth of gravel _____

No wastewater system shall be covered or placed into use by any person until an inspection by the Harnett County Health Department has determined that the system has been installed according to the conditions of the Improvement Permit and that a valid Operations Permit has been issued.

Joe West RS

Signature of Authorized Agent for Harnett County

4.21.05

Date