

HTE 03-5-7806R

20271

IMPROVEMENT PERMIT

Be it ordained by the Harnett County Board of Health as follows: Section III, Item B. "No Person shall begin construction of any building at which a septic tank system is to be used for disposal of sewage without first obtaining a written permit from the Harnett County Health Department."

Name: (owner) Moore Homer New Installation Septic Tank
Property Location: SR# NC 27 Repairs Nitrification Line

Subdivision Clearview S-Subdivision Lot # 13

Tax ID # 28 56 Quadrant # _____

Number of Bedrooms Proposed: 4 (22x76) Lot Size: .77 AC

Basement with Plumbing: Garage:

Water Supply: Well Public Community

Distance From Well: 50 ft.

Following is the minimum specifications for sewage disposal system on above captioned property. Subject to final approval.

Type of system: Conventional Other _____

Size of tank: Septic Tank: 1000 gallons Pump Tank: _____ gallons

Subsurface Drainage Field No. of ditches 1 exact length of each ditch 460 ft. width of ditches 3 ft. depth of ditches 18-24 in.

French Drain Required: _____ Linear feet

Date: 9-9-03

Signed: [Signature]
Environmental Health Specialist

This permit is subject to revocation if site plans for intended use change.

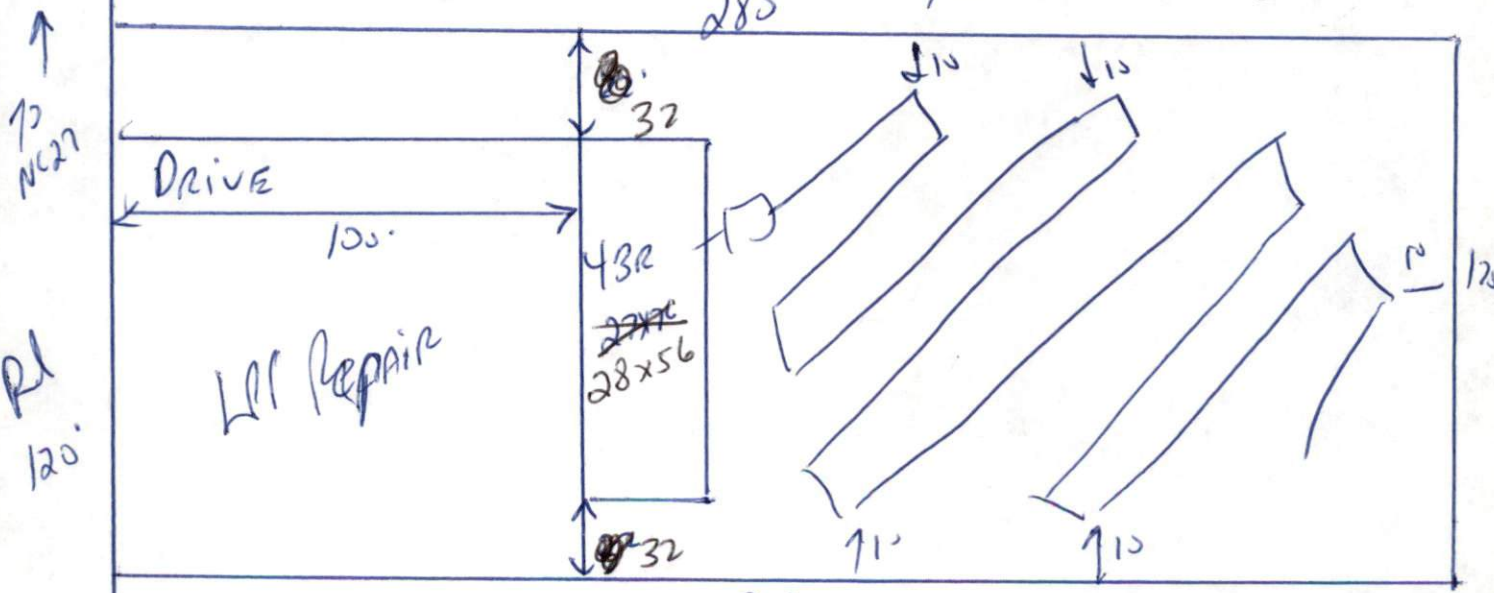

STUB OUT Plumbing shallow maintain ALL setbacks
Follow contours - Do not Drive or park on septic system
House size changed to 28x56 4BR JHW 2/13/04

HARNETT COUNTY HEALTH DEPARTMENT
AUTHORIZATION TO CONSTRUCT

Authorization is hereby given to construct a wastewater system to the specifications described by Harnett County Health Department, Improvement Permit # 20271. This authorization shall be valid for a period not to exceed five (5) years from the date of issuance. This authorization will be invalid if ownership, site plans, or intended use change.

Name Moore Homer Telephone# 814 3349

Address NC 27

Property Location SR# Clearview Subdivision Lot # 13 # Bedrooms Proposed 2 (22x76) 28x56 Road Name .77 AC Lot Size

TYPE OF SYSTEM

New Installation Repair Septic Tank Nitrification Lines

Conventional Other _____

Basement With Plumbing Without Plumbing

Water Supply: Well Public Water Supply Minimum Well Setback: _____ Ft.

Septic Tank 1000 gal Pump Chamber _____ gal

NITRIFICATION FIELD SPECIFICATIONS

Number of fields 1 # of lines per field 1 Length of lines 460 Ft.

Width of ditches 3 ft. Depth of ditches 18-24 inches

French Drain: Linear feet required _____ Depth of gravel _____

No wastewater system shall be covered or placed into use by any person until an inspection by the Harnett County Health Department has determined that the system has been installed according to the conditions of the Improvement Permit and that a valid Operations Permit has been issued.

Signature of Authorized Agent for Harnett County of Harnett [Signature]

Date 9-9-04 2-13-04