

HARNETT COUNTY HEALTH DEPARTMENT

No 19953

IMPROVEMENT PERMIT

Be it ordained by the Harnett County Board of Health as follows: Section III, Item B. "No Person shall begin construction of any building at which a septic tank system is to be used for disposal of sewage without first obtaining a written permit from the Harnett County Health Department."

Name: (owner) James + Judy Owen  New Installation  Septic Tank  
Property Location: SR# 1419 Avery Spence Rd  Repairs  Nitrification Line

Subdivision \_\_\_\_\_ Lot # \_\_\_\_\_

Tax ID # \_\_\_\_\_ Quadrant # \_\_\_\_\_

Number of Bedrooms Proposed: 3 Lot Size: 1.2 acre

Basement with Plumbing:  Garage:

Water Supply:  Well  Public  Community

Distance From Well: 50' ft.

Following is the minimum specifications for sewage disposal system on above captioned property. Subject to final approval.

Type of system:  Conventional  Other \_\_\_\_\_

Size of tank: Septic Tank: 1000 gallons Pump Tank: \_\_\_\_\_ gallons

Subsurface Drainage Field No. of ditches 2 exact length of each ditch 150 ft. width of ditches 3 ft. depth of ditches 18 in.

French Drain Required: - Linear feet

Date: 3-14-03

This permit is subject to revocation if site plans or intended use change.

Signed: James E. Markham  
Environmental Health Specialist

Septic Contractor + plumber to meet on site prior to any installation!

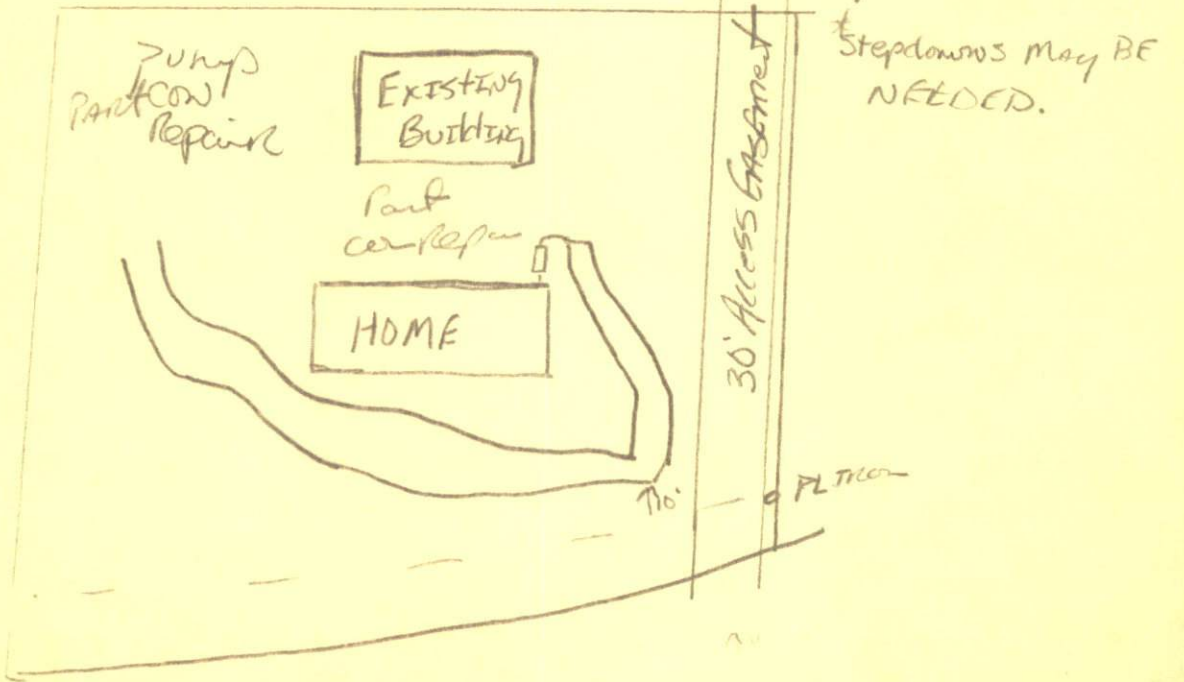

HARNETT COUNTY HEALTH DEPARTMENT  
AUTHORIZATION TO CONSTRUCT

Authorization is hereby given to construct a wastewater system to the specifications described by Harnett County Health Department, Improvement Permit # 19953. This authorization shall be valid for a period not to exceed five (5) years from the date of issuance. This authorization will be invalid if ownership, site plans, or intended use change.

Name James + Judy Avent Telephone# 919-552-3444

Address 416 Avery Spence Rd F.V. N.C. 27526

Property Location SR# 1419 Road Name Avery Spence

Subdivision \_\_\_\_\_ Lot # 1A # Bedrooms Proposed 3 Lot Size 1.2

**TYPE OF SYSTEM**

New Installation    Repair    Septic Tank    Nitrification Lines

Conventional    Other \_\_\_\_\_

Basement    With Plumbing    Without Plumbing

Water Supply:  Well    Public Water Supply   Minimum Well Setback: \_\_\_\_\_ Ft.

Septic Tank 1000 gal Pump Chamber \_\_\_\_\_ gal

**NITRIFICATION FIELD SPECIFICATIONS**

Number of fields 2 # of lines per field 2 Length of lines 150 Ft.

Width of ditches 3 ft. Depth of ditches 22-18 inches

French Drain: Linear feet required \_\_\_\_\_ Depth of gravel \_\_\_\_\_

No wastewater system shall be covered or placed into use by any person until an inspection by the Harnett County Health Department has determined that the system has been installed according to the conditions of the Improvement Permit and that a valid Operations Permit has been issued.

James E. Marshall  
Signature of Authorized Agent for Harnett County of Harnett

3-14-03  
Date