

## IMPROVEMENT PERMIT

03-5-5353

Be it ordained by the Harnett County Board of Health as follows: Section III, Item B. "No Person shall begin construction of any building at which a septic tank system is to be used for disposal of sewage without first obtaining a written permit from the Harnett County Health Department."

Name: (owner) Chad Langdon☒ New Installation☒ Septic TankProperty Location: SR# NC 27☐ Repairs☒ Nitrification LineSubdivision                      Lot # 4Tax ID #                      Quadrant #                     Number of Bedrooms Proposed: 3 (27 x 52) Lot Size: 1.05 acBasement with Plumbing: ☐ Garage: ☐Water Supply: ☐ Well ☒ Public ☐ CommunityDistance From Well: 50 ft.

Following is the minimum specifications for sewage disposal system on above captioned property. Subject to final approval.

Type of system: ☒ Conventional ☐ Other                     Size of tank: Septic Tank: 1000 gallons Pump Tank:                      gallonsSubsurface Drainage Field No. of ditches 3 exact length of each ditch 80 ft. width of ditches 3 ft. depth of ditches 18 in.French Drain Required:                      Linear feet

This permit is subject to revocation if site plans or intended use change.

Date: 8-27-02Signed: for [signature]

Environmental Health Specialist

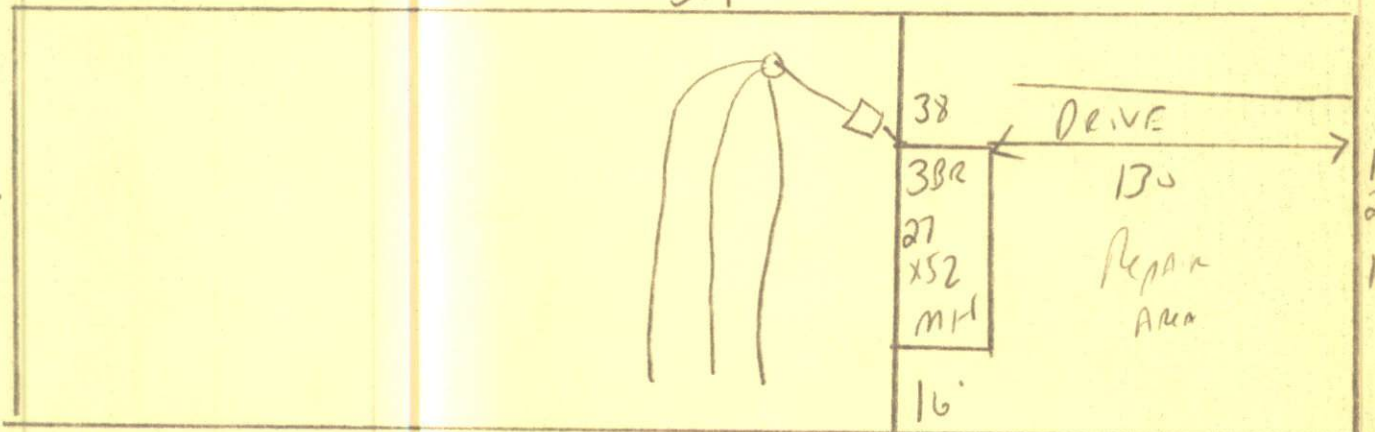

STAB OUT Plumbing shallow when shown. 18" Ditch Depth  
 MAINTAIN ALL SET BACKS - MAY INSTALL IN 1 x 240 Trench  
 IF THAT WOULD BE ENOUGH. DO NOT DRIVE ON PARCH ON SEPTIC  
 SYSTEM.



HA HART COUNTY HEALTH DEPARTMENT  
AUTHORIZATION TO CONSTRUCT

Authorization is hereby given to construct a wastewater system to the specifications described by Harnett County Health Department, Improvement Permit # 19583. This authorization shall be valid for a period not to exceed five (5) years from the date of issuance. *This authorization will be invalid if ownership, site plans, or intended use change.*

Chad Lantz  
Name

893-4125  
Telephone #

Address

N627

Property Location SR#

—

Road Name

3(27x52)

1.05 ac

Subdivision

Lot # 4

# Bedrooms Proposed

Lot size

TYPE OF SYSTEM

☒ New Installation [ ] Repair ☒ Septic Tank ☒ Nitrification Lines

☒ Conventional Other [ ] Basement [ ] With Plumbing [ ] Without Plumbing

Water Supply: [ ] Well ☒ Public - Minimum Well Setback: \_\_\_\_\_ Ft.  
Septic Tank 1000 Pump Chamber \_\_\_\_\_

NITRIFICATION FIELD SPECIFICATIONS

Number of fields 1 # of lines per field 3 Length of lines 80 Ft.

Width of ditches 3 ft. Depth of ditches 18 inches

French Drain: Linear feet required \_\_\_\_\_ Depth of gravel \_\_\_\_\_

No wastewater system shall be covered or placed into use by any person until an inspection by the Harnett County Health Department has determined that the system has been installed according to the conditions of the Improvement Permit and that a valid Operations Permit has been issued.

[Signature]

Signature of Authorized Agent for Harnett County

08-27-02

Date