

IMPROVEMENT PERMIT

01-5-1326

Be it ordained by the Harnett County Board of Health as follows: Section III, Item B. "No Person shall begin construction of any building at which a septic tank system is to be used for disposal of sewage without first obtaining a written permit from the Harnett County Health Department."

Name: (owner) Joseph Hodges New Installation Septic Tank
 Property Location: SR# 1280 Repairs Nitrification Line

Subdivision _____ Lot # _____

Tax ID # _____ Quadrant # _____

Number of Bedrooms Proposed: 3 (28x56) Lot Size: 2.04 AC

Basement ~~with Plumbing~~: No plumbing Garage: Meet on site ~~Before~~

Water Supply: Well Public Community STUB out Plumbing - may

Distance From Well: 50 ft. Be Able To Get out of A Pump

Following is the minimum specifications for sewage disposal system on above captioned property. Subject to final approval.

Type of system: Conventional Other Pump to Conventional

Size of tank: Septic Tank: 1000 gallons Pump Tank: 1000 gallons

Subsurface Drainage Field No. of ditches 1 exact length 400 ft. width of ditches 3 ft. depth of ditches 18 max in.

French Drain Required: _____ Linear feet

Date: 03-19-01

Signed: Joe Wiles
 Environmental Health Specialist

This permit is subject to revocation if site plans or intended use change.

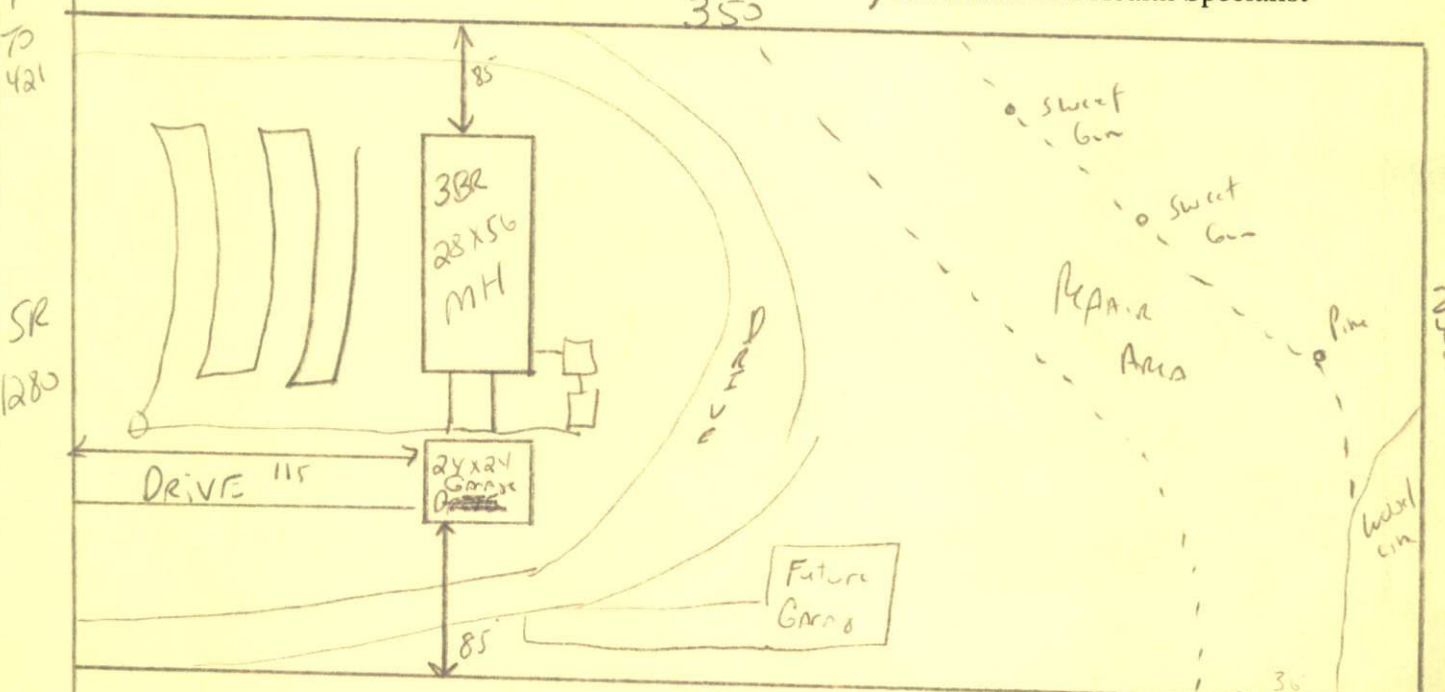

Meet on site maybe able to get out of a pump.

Maintain all set backs

Do not Drive or park on septic system

Land owner stated home can not be moved because of the basement

HARNETT COUNTY HEALTH DEPARTMENT
AUTHORIZATION TO CONSTRUCT

Authorization is hereby given to construct a wastewater system to the specifications described by Harnett County Health Department Improvement Permit # 18275. This authorization shall be valid for a period not to exceed five (5) years from the date of issuance. This authorization will be invalid if ownership, site plans, or intended use change.

Owner or Authorized Agent Joseph Hodges

Name: _____ Telephone # 1-252-438-7412

Address: _____

Property Location: SR # 1280 Road Name _____

New Installation Repair _____ Septic Tank Nitrification Lines

Subdivision _____ Lot # _____

Number of Bedrooms Proposed: 3 Lot size: 2.04 Ac

Basement _____ With Plumbing _____ Without Plumbing _____

Water Supply: Well _____ Public Minimum Well Setback: _____ ft.

Type of System: Conventional _____ Other

Tank Volume: Septic Tank 1000 gallons Pump Chamber 1000 gallons

Nitrification Field Specifications

Number of fields 1 Number of Lines per Field 4 Length of lines 400

Width of ditches 3 ft. Depth of ditches 18 inches

French Drain: Linear feet required _____ Depth of gravel _____

No wastewater system shall be covered or placed into use by any person until an inspection by the Harnett County Health Department has determined that the system has been installed according to the conditions of the improvement permit and that a valid operations permit has been issued.

Authorized Agent for Harnett County Health Department

Name: [Signature] Date: 3-20-01