

**SOIL/SITE EVALUATION  
 for ON-SITE WASTEWATER SYSTEM**

Owner: \_\_\_\_\_ Applicant: \_\_\_\_\_  
 Address: \_\_\_\_\_ Date Evaluated: 8/5/85  
 Proposed Facility: \_\_\_\_\_ Design Flow (.1949): \_\_\_\_\_ Property Size: \_\_\_\_\_  
 Location of Site: \_\_\_\_\_ Property Recorded: \_\_\_\_\_  
 Water Supply:  Public  Individual  Well  Spring  Other  
 Evaluation Method:  Auger Boring  Pit  Cut  
 Type of Wastewater:  Sewage  Industrial Process  Mixed

P R O F I L E #	1940 Landscape Position/ Slope%	Horizon Depth (IN.)	SOIL MORPHOLOGY .1941		OTHER PROFILE FACTORS				Profile Class & LTAR
			1941 Structure/ Texture	1941 Consistence Mineralogy	1942 Soil Wetness/ Color	1943 Soil Depth (IN.)	1944 Saprot Class	1944 Restr. Horiz	
L5 3-796		0-14	G/L5	VFr NSNP					OS/PS.4
		14-32	SBK/SCI	Fr SSSP	10YR 8/1 & 26"				
		0-8	G/L5	VFr NSNP					
		8-15	SBK/SCI	Fr SSSP					OS/PS.4
		15-20	G/L5	VFr NSNP					
		20-31	SBK/SCI	Fr SSSP	10YR 8/1 & 29"				
		0-15	G/L5	VFr NSNP					PS.4
		15-32	SBK/SCI	Fr SSSP	10YR 8/1 & 30"				
		0-24	G/L5	VFr NSNP					
		24-36	SBK/SCI	Fr SSSP	10YR 8/1 & 34"				PS.4
		0-15	G/L5	VFr NSNP					
		15-32	SBK/SCI	Fr SSSP	10YR 8/1 & 33"				
	0-10	G/L5	VFr NSNP					OS/PS.4	
	10-29	SBK/SCI	Fr SSSP	10YR 8/1 & 27"					

Description	Initial System	Repair System
Available Space (.1945)	✓	✓
System Type(s)	1/2" dia corr. shell	shallow corr.
Site LTAR	4	4

Other Factors (.1946): \_\_\_\_\_  
 Site Classification (.1948): PS  
 Evaluated By: JN  
 Others Present: \_\_\_\_\_



COMMENTS: \_\_\_\_\_  
 \_\_\_\_\_  
 \_\_\_\_\_

LANDSCAPE POSITIONS	GROUP	TEXTURES	.1955 LTAR	CONSISTENCE MOIST	WET
R-RIDGE	I	S-SAND	1.2 - 0.8	VFR-VERY FRIABLE	NS-NON-STICKY
S-SHOULDER SLOPE		LS-LOAMY SAND			
L-LINEAR SLOPE	II	SL-SANDY LOAM	0.8 - 0.6	FR-FRIABLE	SS-SLIGHTLY STICKY
FS-FOOT SLOPE		L-LOAM			
N-NOSE SLOPE	III	SI-SILT-	0.6 - 0.3	FI-FIRM	S-STICKY
H-HEAD SLOPE		SIL-SILT LOAM			
CC-CONCLAVE SLOPE		CL-CLAY LOAM			
CV-CONVEX SLOPE		SCL-SANDY CLAY LOAM			
T-TERRACE	IV	SIC-SILTY CLAY	0.4 - 0.1	VFI-VERY FIRM	VS-VERY STICKY
FP-FLOOD PLAN		C-CLAY			
		SC-SANDY CLAY			
		SICL-SILTY CLAY LOAM		EFI-EXTREMELY FIRM	NP-NON-PLASTIC
					SP-SLIGHTLY STICKY
					P-PLASTIC
					VP-VERY PLASTIC

*Handwritten notes:*  
 2  
 0-15 G/LU SH-NOT  
 15-33 SB/LSC F-SSP / PE.3  
 chm at 30"  
 (8)

**STRUCTURE**  
 SG-SINGLE GRAIN  
 M-MASSIVE  
 CR-CRUMB  
 GR-GRANULAR  
 SBK-SUBANGULAR BLOCKY  
 ABK-ANGULAR BLOCKY  
 PL-PLATY  
 PR-PRISMATIC

**MINERALOGY**  
 SLIGHTLY EXPANSIVE  
 EXPANSIVE

Show profile locations and other site features (dimensions, reference or benchmark, and North).

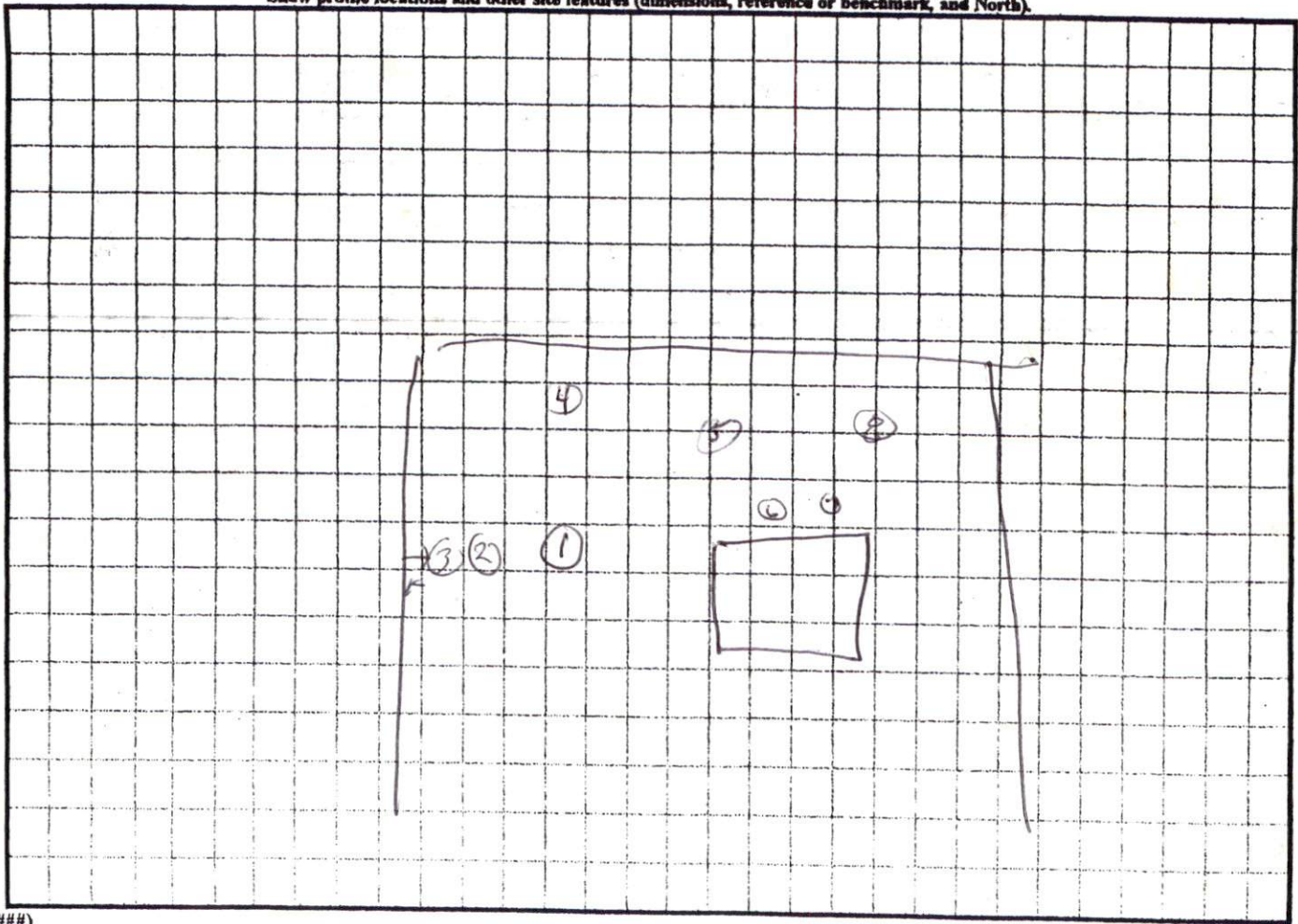

COMMENTS: \_\_\_\_\_

LANDSCAPE POSITIONS	GROUP	TEXTURES	.1955 LTAR	CONSISTENCE MOIST	WET
R-RIDGE	I	S-SAND	1.2 - 0.8	VFR-VERY FRIABLE FR-FRIABLE FI-FIRM VFI-VERY FIRM EFI-EXTREMELY FIRM	NS-NON-STICKY SS-SLIGHTLY STICKY S-STICKY VS-VERY STICKY NP-NON-PLASTIC SP-SLIGHTLY STICKY P-PLASTIC VP-VERY PLASTIC
S-SHOULDER SLOPE		LS-LOAMY SAND			
L-LINEAR SLOPE					
FS-FOOT SLOPE	II	SL-SANDY LOAM	0.8 - 0.6		
N-NOSE SLOPE		L-LOAM			
H-HEAD SLOPE	III	SI-SILT-	0.6 - 0.3		
CC-CONCLAVE SLOPE		SIL-SILT LOAM			
CV-CONVEX SLOPE		CL-CLAY LOAM			
T-TERRACE		SCL-SANDY CLAY LOAM			
FP-FLOOD PLAN		SICL-SILTY CLAY LOAM			
	IV	SIC-SILTY CLAY	0.4 - 0.1		
		C-CLAY			
		SC-SANDY CLAY			

*Handwritten notes:*  
 2  
 0-15 G/W S/W NTM  
 15-33 SBL/SCI F/STP / PE.3  
 chm at 30"  
 (8)

**STRUCTURE**

- SG-SINGLE GRAIN
- M-MASSIVE
- CR-CRUMB
- GR-GRANULAR
- SBK-SUBANGULAR BLOCKY
- ABK-ANGULAR BLOCKY
- PL-PLATY
- PR-PRISMATIC

**MINERALOGY**

- SLIGHTLY EXPANSIVE
- EXPANSIVE

Show profile locations and other site features (dimensions, reference or benchmark, and North).

