

**SOIL/SITE EVALUATION  
 for ON-SITE WASTEWATER SYSTEM**

Owner:  
 Address:  
 Proposed Facility: Design Flow (.1949):  
 Location of Site:  
 Water Supply:  Public  Individual  Well  
 Evaluation Method:  Auger Boring  Pit  
 Type of Wastewater:  Sewage  Industrial Process

Applicant:  
 Date Evaluated: 5/15/2008  
 Property Size:  
 Property Recorded:  
 Spring  Other  
 Cut  
 Mixed

P R O F I L E #	.1940 Landscape Position/ Slope%	Horizon Depth (IN.)	SOIL MORPHOLOGY .1941		OTHER PROFILE FACTORS				Profile Class & LTAR
			.1941 Structure/ Texture	.1941 Consistence Mineralogy	.1942 Soil Wetness/ Color	.1943 Soil Depth (IN.)	.1956 Sapro Class	.1944 Restr Horiz	
1	L5	0-26	G/SL	VFN SNP					PS.45
		26-44	SBK/SCI	FR SS SP	10YR 7/2 39"				
2	3-6%	0-16	G/SL	VFN SNP					PS.45
		16-39	SBK/SCI	FR SS SP	10YR 7/2 37"				
3		0-48	G/LS	VFN SNP					PS.8

Description	Initial System	Repair System
Available Space (.1945)	✓	✓
System Type(s)	CGN	pump to CGN
Site LTAR	.45	.8

Other Factors (.1946): \_\_\_\_\_  
 Site Classification (.1948): PS  
 Evaluated By: DT  
 Others Present: BM

COMMENTS: \_\_\_\_\_  
 \_\_\_\_\_  
 \_\_\_\_\_

<u>LANDSCAPE POSITIONS</u>	<u>GROUP</u>	<u>TEXTURES</u>	<u>.1955 LTAR</u>	<u>CONSISTENCE MOIST</u>	<u>WET</u>
R-RIDGE	I	S-SAND	1.2 - 0.8	VFR-VERY FRIABLE FR-FRIABLE FI-FIRM VFI-VERY FIRM EFI-EXTREMELY FIRM	NS-NON-STICKY SS-SLIGHTLY STICKY S-STICKY VS-VERY STICKY NP-NON-PLASTIC SP-SLIGHTLY STICKY P-PLASTIC VP-VERY PLASTIC
S-SHOULDER SLOPE		LS-LOAMY SAND			
L-LINEAR SLOPE	II	SL-SANDY LOAM	0.8 - 0.6		
FS-FOOT SLOPE		L-LOAM			
N-NOSE SLOPE	III	SI-SILT-	0.6 - 0.3		
H-HEAD SLOPE		SIL-SILT LOAM			
CC-CONCLAVE SLOPE		CL-CLAY LOAM			
CV-CONVEX SLOPE		SCL-SANDY CLAY LOAM			
T-TERRACE		SIC-SILTY CLAY			
FP-FLOOD PLAN	IV	C-CLAY	0.4 - 0.1		
		SC-SANDY CLAY			

STRUCTURE

- SG-SINGLE GRAIN
- M-MASSIVE
- CR-CRUMB
- GR-GRANULAR
- SBK-SUBANGULAR BLOCKY
- ABK-ANGULAR BLOCKY
- PL-PLATY
- PR-PRISMATIC

MINERALOGY

- SLIGHTLY EXPANSIVE
- EXPANSIVE

Show profile locations and other site features (dimensions, reference or benchmark, and North).

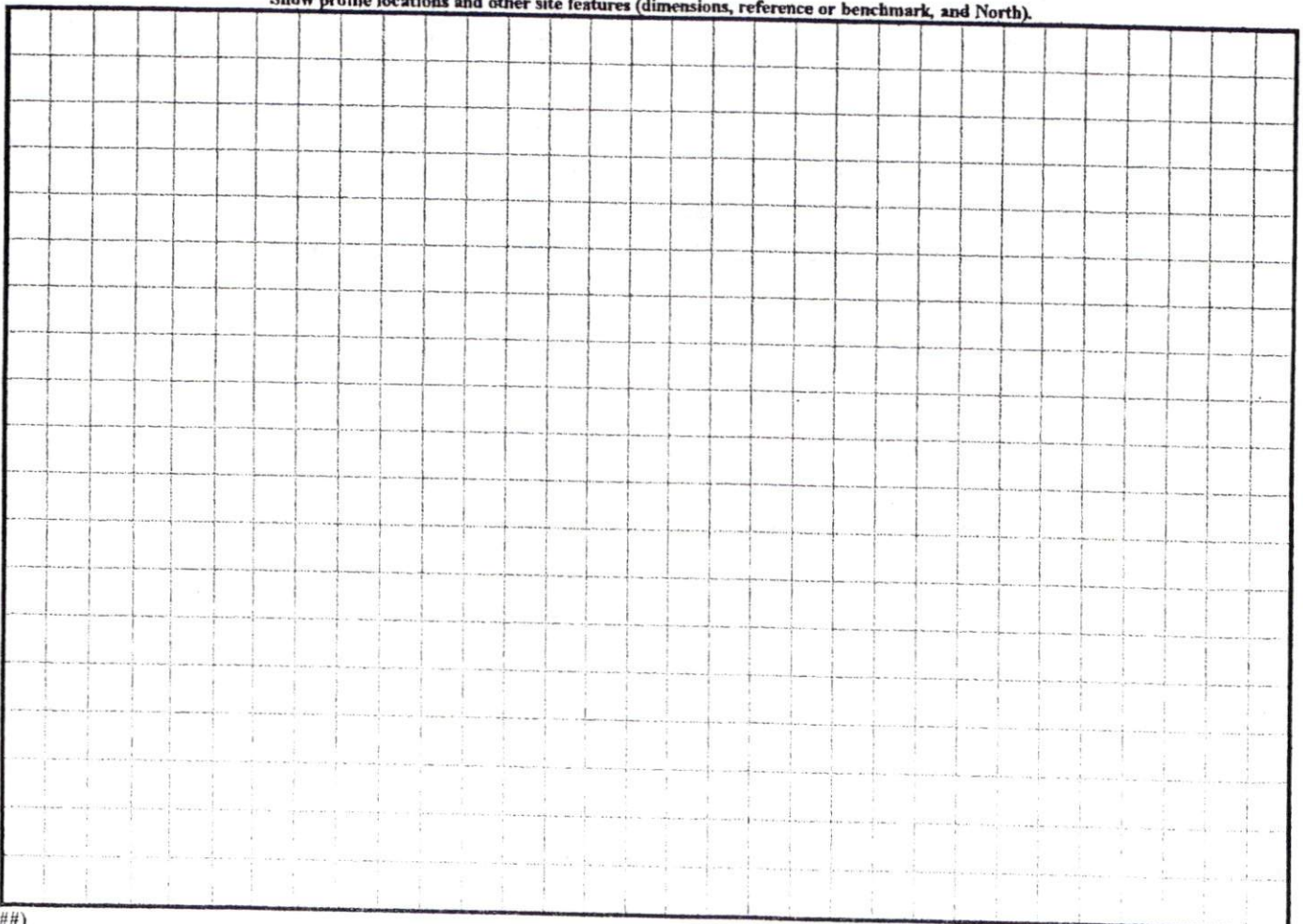

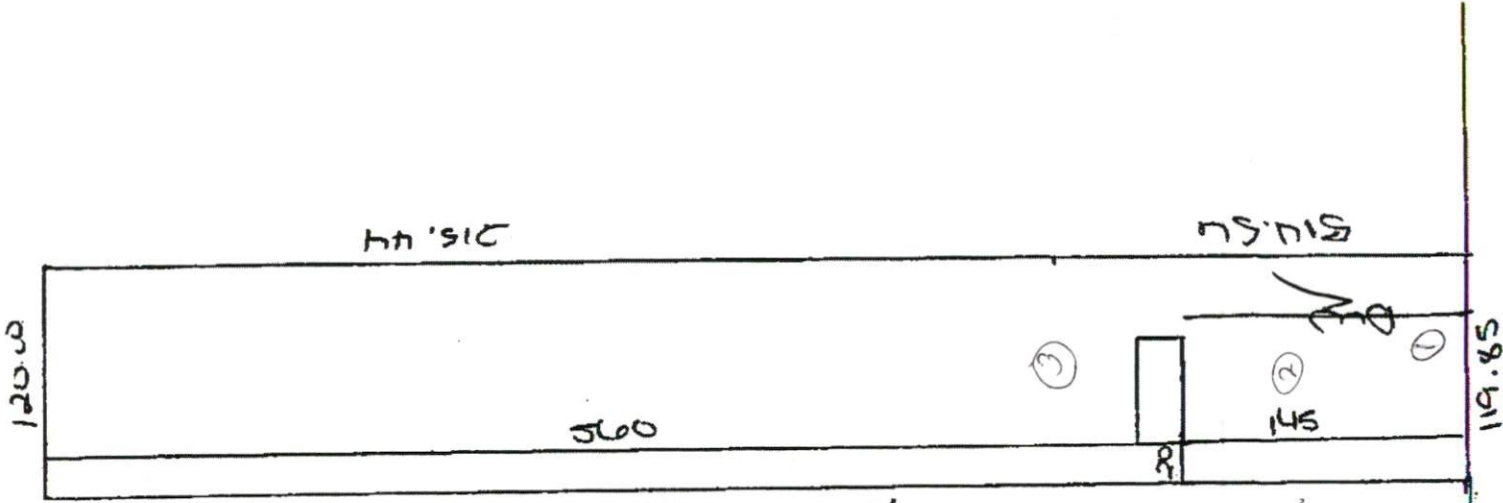

**SITE PLAN APPROVAL**

DISTRICT NA USE ResM4

#BEDROOMS 3  
4/23/08  
 Date Zoning Administrator

Teresa Coeff

Byrd Mill Rd SR # 2024