

### SOIL/SITE EVALUATION for ON-SITE WASTEWATER SYSTEM

Owner: \_\_\_\_\_ Applicant: \_\_\_\_\_  
 Address: \_\_\_\_\_ Date Evaluated: \_\_\_\_\_  
 Proposed Facility: \_\_\_\_\_ Design Flow (.1949): \_\_\_\_\_ Property Size: \_\_\_\_\_  
 Location of Site: \_\_\_\_\_ Property Recorded: \_\_\_\_\_  
 Water Supply:  Public  Individual  Well  Spring  Other  
 Evaluation Method:  Auger Boring  Pit  Cut  
 Type of Wastewater:  Sewage  Industrial Process  Mixed

1940 Landscape Position/ Slope%	Horizon Depth (IN.)	SOIL MORPHOLOGY 1941		OTHER PROFILE FACTORS				Profile Class & LTAR
		1941 Structure/ Texture	1941 Consistence Mineralogy	1942 Soil Wetness/ Color	1943 Soil Depth (IN.)	1956 Sapro Class	1944 Restr. Horiz	
1 L 20%	0-36	SL	FL GW NSNP					.4
	36"-48"	SLL	SLLM 1 <sup>LD</sup> S.P.					
2 L 20%	0-36	SL	FL GW NSNP					.4
	36"-48"	SLL	SLLM 1 <sup>LD</sup> S.P.					

Description	Initial System	Repair System
Available Space (.1945)		
System Type(s)	CS	CS
Site LTAR	.4	.4

Other Factors (.1946): \_\_\_\_\_  
 Site Classification (.1948): \_\_\_\_\_  
 Evaluated By: \_\_\_\_\_  
 Others Present: \_\_\_\_\_

COMMENTS: \_\_\_\_\_  
 \_\_\_\_\_  
 \_\_\_\_\_

<u>LANDSCAPE POSITIONS</u>	<u>GROUP</u>	<u>TEXTURES</u>	<u>.1955 LTAR</u>	<u>CONSISTENCE MOIST</u>	<u>WET</u>
R-RIDGE	I	S-SAND	1.2 - 0.8	VFR-VERY FRIABLE FR-FRIABLE FI-FIRM VFI-VERY FIRM EFI-EXTREMELY FIRM	NS-NON-STICKY SS-SLIGHTLY STICKY S-STICKY VS-VERY STICKY NP-NON-PLASTIC SP-SLIGHTLY STICKY P-PLASTIC VP-VERY PLASTIC
S-SHOULDER SLOPE		LS-LOAMY SAND			
L-LINEAR SLOPE	II	SL-SANDY LOAM	0.8 - 0.6		
FS-FOOT SLOPE		L-LOAM			
N-NOSE SLOPE	III	SI-SILT-	0.6 - 0.3		
H-HEAD SLOPE		SIL-SILT LOAM			
CC-CONCLAVE SLOPE		CL-CLAY LOAM			
CV-CONVEX SLOPE		SCL-SANDY CLAY LOAM			
T-TERRACE		SICL-SILTY CLAY LOAM			
FP-FLOOD PLAN	IV	SIC-SILTY CLAY	0.4 - 0.1		
		C-CLAY			
		SC-SANDY CLAY			

STRUCTURE  
 SG-SINGLE GRAIN  
 M-MASSIVE  
 CR-CRUMB  
 GR-GRANULAR  
 SBK-SUBANGULAR BLOCKY  
 ABK-ANGULAR BLOCKY  
 PL-PLATY  
 PR-PRISMATIC

MINERALOGY  
 SLIGHTLY EXPANSIVE  
 EXPANSIVE

Show profile locations and other site features (dimensions, reference or benchmark, and North).

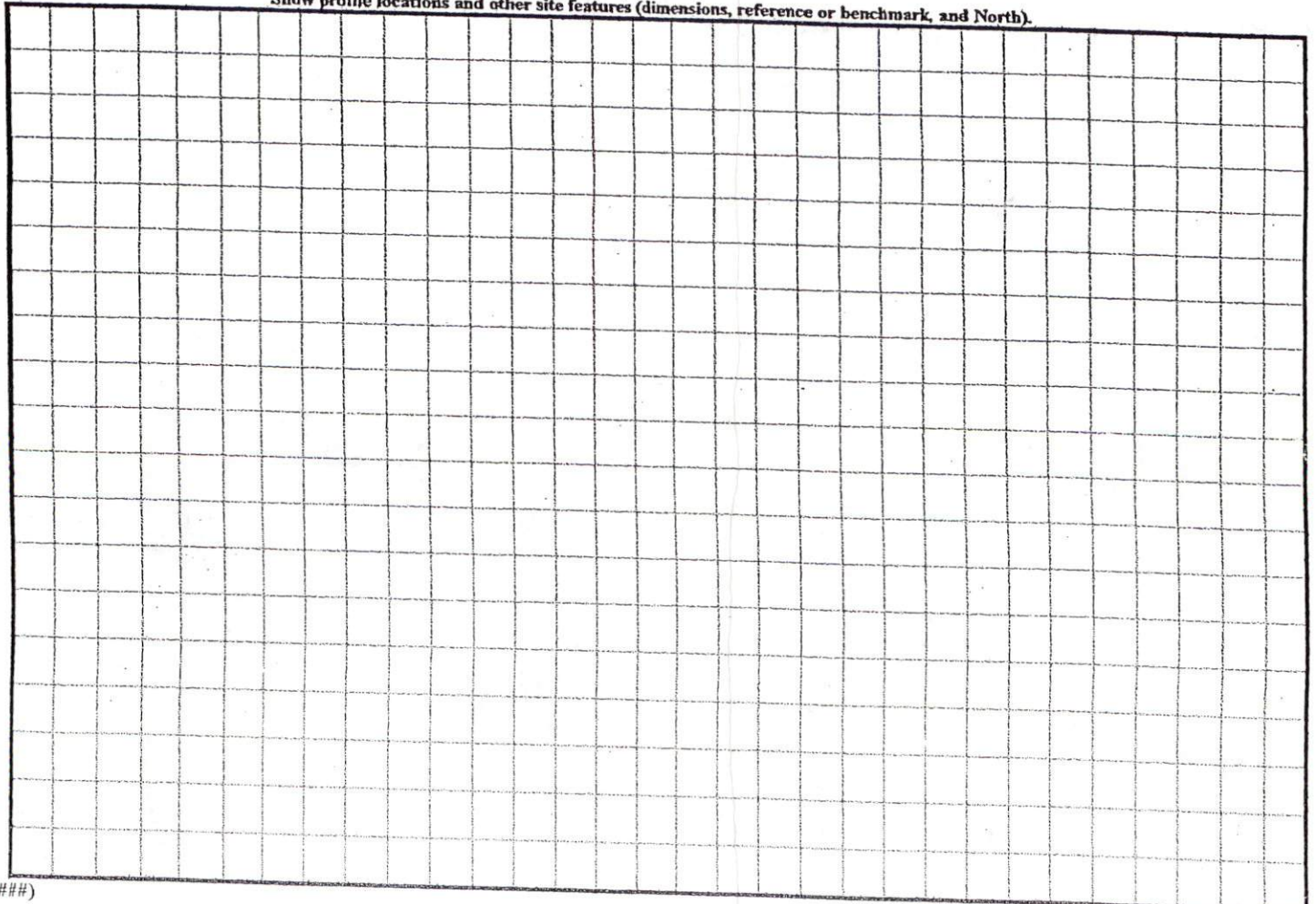

(#####)



0.36 SL  
36" x SL  
.4

3x100 car  
3x80 2590  
24' x 42'

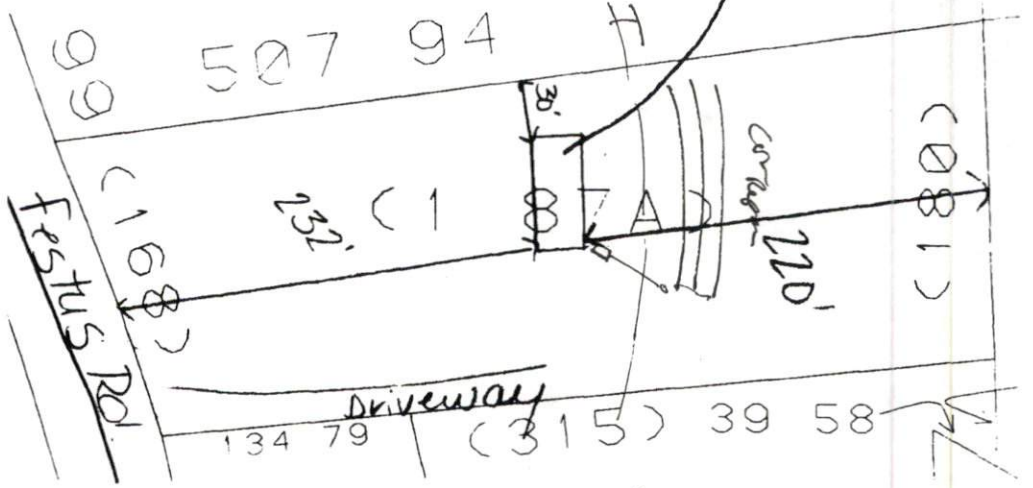

PLAN APPROVAL

DISTRICT RA20M USE DWELL

#BEDROOMS 3

12/19/05

Zoning Administrator

*[Signature]*

1610-26-1648

Scale: 1" = 100 ft

December 19, 2005