

HARNETT COUNTY HEALTH DEPARTMENT

HTE 05-500-11357

IMPROVEMENT PERMIT

21823

Be it ordained by the Harnett County Board of Health as follows: Section III, Item B. "No Person shall begin construction of any building at which a septic tank system is to be used for disposal of sewage without first obtaining a written permit from the Harnett County Health Department."

Name: (owner) Bernadino (Dino) Cisneros

New Installation  Septic Tank

Property Location: SR# 1320 Milton Welch

Repairs  Nitrification Line

Subdivision K-Bar Hills

Lot # 4

Tax ID #

Quadrant #

Number of Bedrooms Proposed: 3 (14x80)

Lot Size: .95 AC

Basement with Plumbing:

Garage:  Meet onsite for final layout

Water Supply:  Well  Public

Community Keep Tank 50' from well

Distance From Well: 50' ft.

Following is the minimum specifications for sewage disposal system on above captioned property. Subject to final approval.

Type of system:  Conventional

Other 25% Reduction SYSTEM

Size of tank: Septic Tank: 1000 gallons

Pump Tank: \_\_\_\_\_ gallons

Subsurface Drainage Field No. of ditches 1 exact length of each ditch 150 ft.

width of ditches 3 ft.

depth of ditches 18-24 in.

French Drain Required: \_\_\_\_\_ Linear feet of 25% Reduction system

Date: 04-08-05

This permit is subject to revocation if site plans or intended use change.

Signed: [Signature]

Environmental Health Specialist

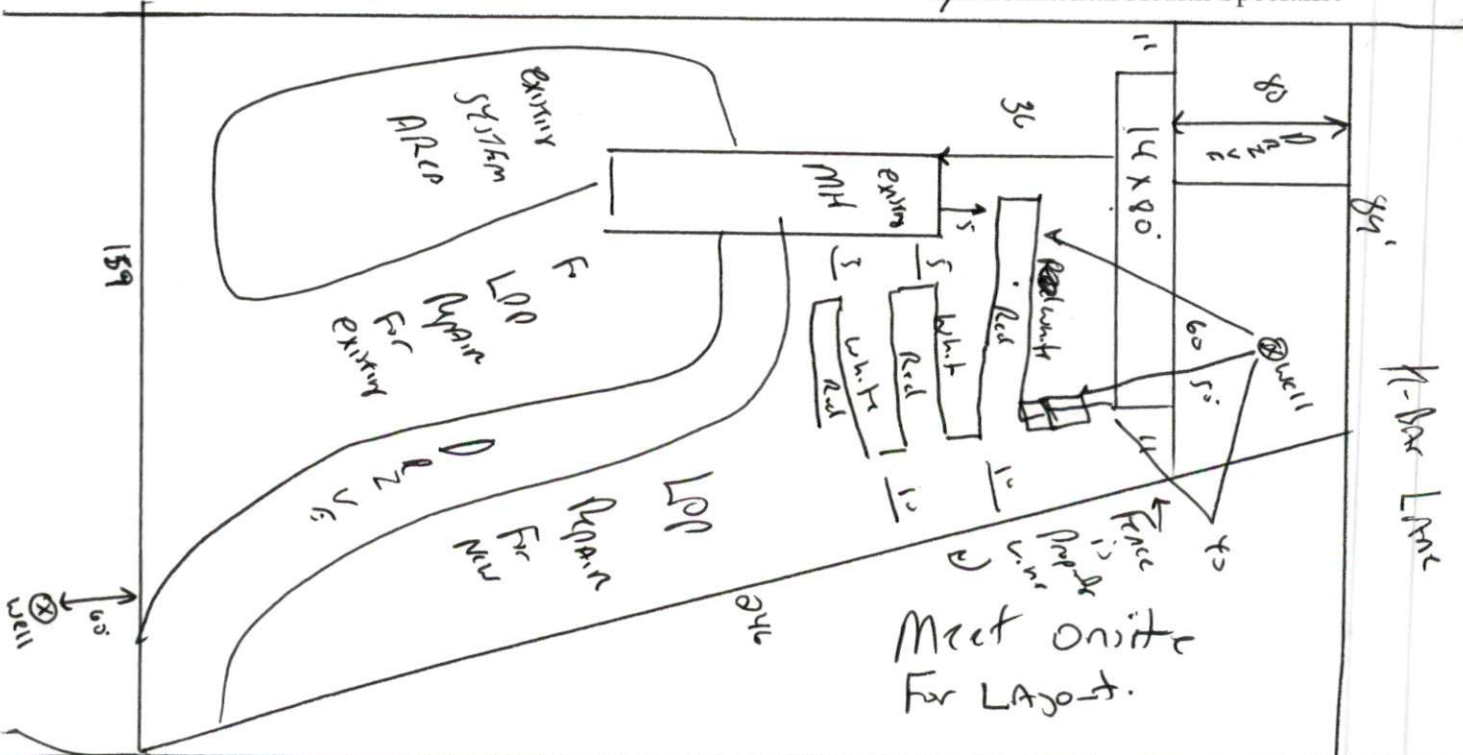

SR 1320

HARNETT COUNTY DEPARTMENT OF PUBLIC HEALTH  
AUTHORIZATION TO CONSTRUCT

Authorization is hereby given to construct a wastewater system to the specifications described by Harnett County Department of Public Health, Improvement Permit # 21823. This authorization shall be valid for a period not to exceed five (5) years from the date of issuance. *This authorization will be invalid if ownership, site plans, or intended use change.*

Bernardino (Dino) Cisneros

Name

Telephone #

Address

1320

Property Location SR#

Road Name

K-Bar Hill

4

3(14x8)

.95 ac

Subdivision

Lot #

# Bedrooms Proposed

Lot Size

**TYPE OF SYSTEM**

- New Installation [ ] Repair
- Septic Tank  Nitrification Lines
- [ ] Conventional  Other 25% Reduction SYSTEM
- [ ] Basement [ ] With Plumbing [ ] Without Plumbing

Water Supply: [ ] Well  Public Water Supply Minimum Well Setback: 50 Ft.

Septic Tank 1000 gal Pump Chamber \_\_\_\_\_ gal

**NITRIFICATION FIELD SPECIFICATIONS**

Number of fields 1 # of lines per field 6 Length of lines 150 Ft.  
 Width of ditches 3 ft. Depth of ditches 18-24 inches of 25% Reduction SYSTEM  
 French Drain: Linear feet required \_\_\_\_\_ Depth of gravel \_\_\_\_\_

No wastewater system shall be covered or placed into use by any person until an inspection by the Harnett County Health Department has determined that the system has been installed according to the conditions of the Improvement Permit and that a valid Operations Permit has been issued.

Joe West RS

Signature of Authorized Agent for Harnett County

04-08-05

Date