

IMPROVEMENT PERMIT

03-5-5765 Rev.

Permit # 19784 IS NOW VOIDED # 19784 WAS ISSUED ON 10-30-02

Be it ordained by the Harnett County Board of Health as follows: Section III, Item B. "No Person shall begin construction of any building at which a septic tank system is to be used for disposal of sewage without first obtaining a written permit from the Harnett County Health Department."

Name: (owner) LORRAINE CURRIE
Property Location: SR# 1215
New Installation
Septic Tank
Repairs
Nitrification Line

Subdivision JM Kelly Acres Lot # 3

Tax ID # Quadrant #

Number of Bedrooms Proposed: 2 Lot Size: 1.20ac

Basement with Plumbing: Garage:
Water Supply: Well Public Community
Distance From Well: 50 ft.

Permit # 19784 Issued on 10-30-02 IS NOW VOID

Following is the minimum specifications for sewage disposal system on above captioned property. Subject to final approval.

Type of system: Conventional Other
Size of tank: Septic Tank: 1000 gallons Pump Tank: gallons
Subsurface Drainage Field No. of ditches: 4 exact length of each ditch: 80 ft. width of ditches: 3 ft. depth of ditches: 18 in. max
French Drain Required: Linear feet

Date: 11-21-02
Signed: Joe WARS
Environmental Health Specialist

This permit is subject to revocation if site plans or intended use change.

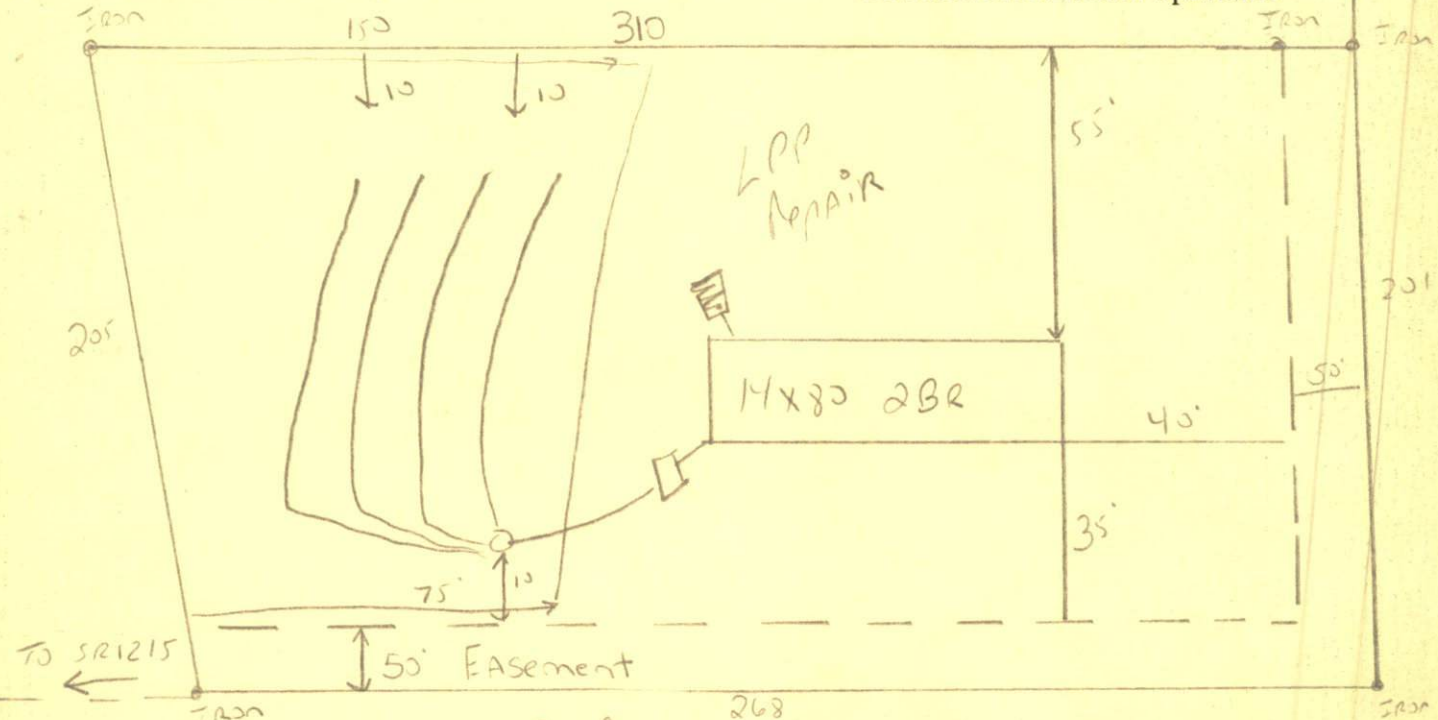

Meet onsite Before Installing 18" max ditch Depth, maintain All set Backs, Do not DRIVE OR PARK on septic system

HARNETT COUNTY HEALTH DEPARTMENT
AUTORIZATION TO CONSTRUCT

Authorization is hereby given to construct a wastewater system to the specifications described by Harnett County Health Department, Improvement Permit # 19799. This authorization shall be valid for a period not to exceed five (5) years from the date of issuance. *This authorization will be invalid if ownership, site plans, or intended use change.*

LORRAINE CURRIE 893-2838
Name Telephone #

Address _____

1215
Property Location SR# Road Name

JM Kelly Acres 3 2(14x87) 1.22 Ac
Subdivision Lot # # Bedrooms Proposed Lot size

TYPE OF SYSTEM

New Installation [] Repair Septic Tank Nitrification Lines

Conventional Other _____ [] Basement [] With Plumbing [] Without Plumbing

Water Supply: [] Well Public - Minimum Well Setback: 50 Ft.
Septic Tank 1000 Pump Chamber _____

NITRIFICATION FIELD SPECIFICATIONS

Number of fields 1 # of lines per field 4 Length of lines 80 Ft.

Width of ditches 3 ft. Depth of ditches 18mm inches

French Drain: Linear feet required _____ Depth of gravel _____

No wastewater system shall be covered or placed into use by any person until an inspection by the Harnett County Health Department has determined that the system has been installed according to the conditions of the Improvement Permit and that a valid Operations Permit has been issued.

[Signature] 11-21-02
Signature of Authorized Agent for Harnett County Date